

Operating Instructions



Model:

iDOME SWING

PC MARKETING

1040 WILT AVENUE

RIDGEFIELD, NJ 07657

1-800-FAST TAN



Forward

The iDOME is built with state-of-the-art technology and is safe to operate.

However, there is a risk of danger if the unit is operated by people who have not been properly instructed or trained in its use or in a way other than that for which was intended. Therefore all persons concerned with the assembly, installation, operation, maintenance and repair of the unit must first read and understand the operating instructions and especially the safety instructions.

Ensure that you and your staff are instructed by a specialist before the unit is used for the first time. In the unlikely event of a technical fault please contact our Customer Service or your dealer.

TABLE OF CONTENTS PAGE

1	SAFETY INSTRUCTIONS	3-5
1.1	Before initial operation	3
1.2	Using the unit for the first timethe first time	3
1.3	Safety warning	3-5
1.4	Proper use	5
1.5	Product liability	5
1.6	What to do in an emergency	5
1.7	Explanation of danger symbols	5
1.8	Position of the user	5

INFORMATION FOR THE USER

2	OPERATION	6-9
2.1	Equipment - New and proven	6
2.2	Preparation	6
2.3	Starting	6-7
2.3.1	Starting in coinbox operation	7
2.3.2	Starting in private operation	7
2.3.3	Head end fan	7
2.3.4	Body fan	7
2.3.5	Facial tanning	7
2.3.6	Audio	7-8
2.3.7	BREEZE	8
2.3.8	AROMA	8
2.3.9	Fault indicators	8
2.4.	Cleaning the acrylic panel	8-9

INFORMATION FOR THE OPERATOR

3	COMMISSIONING	9-11
3.1	Important information! To be read by everyone!	9
3.2	Before initial operation	9
3.3	Using the unit for the first time	9
3.3.1	Specifying coinoperated/private operation	9-10
3.4.	Connecting the BREEZE tank	10
3.4.1	Bleeding the BREEZE lines	10
3.4.2	Connecting AROMA bottle	10-11
3.5	Audiosystem	11
3.6	Error messages	11
4	CLEANING – IMPORTANT INFORMATION FOR THE OPERATOR	11-12
5	IMPORTANT INFORMATION FOR THE OPERATOR	12-15
5.1	Service module (Operating hours, error messages)	12
5.1.1	Service module	12
5.1.2	Use of the service module	12
5.1.3	Programs of the service module	13
	The service at a glance	14
5.2	Preset service intervals	14
5.2.1	Overview of Possible Settings	15
6	SERVICE AND MAINTENANCE	15-22
6.1	Replacing acrylic panels	15
6.1.1	Acrylic panels	15
6.2	Changing the POWERSPOT	16
6.2.1	Changing the high pressure lamp	16
6.2.2	Exchanging the POWERSPOT in the top	16-17
6.2.3	Exchanging the POWERSPOT in Panel 2	17
6.3	Exchanging the Sunlamp	17
6.3.1	Lighting of the facial panel	18
6.3.2	Replacing the LED handle illumination	19

TABLE OF CONTENTS	PAGE
6.4 Changing the filter mats	19
6.4.1 Filter mats in the base housing	20
6.4.2 Changing filter mats boards	20-21
6.5 Servicing the BREEZE system	21
6.5.1 Bleeding the BREEZE lines	21
6.5.2 BREEZE system faults	21
6.6 Replacing the BREEZE tank	21
6.6.1 Change of BREEZE nozzle	21
6.6.2 Important Information to BREEZE	21
6.6.3 Set the BREEZE spray cycles to zero, bleed BREEZE	22
6.6.4 Bleeding the BREEZE system	22
6.7 Changing AROMA bottle	22
6.7.1 Replacing the LED illumination AROMA	22
7. TIPS FOR TROUBLESHOOTING	23
8. WASTE DISPOSAL	23
INFORMATION FOR THE ENGINEER AND PC MARKETING PERSONNEL	
9 INSTALLATION OF THE PROFI UNIT	24-35
9.1 Place of Installation and State on Delivery	24
9.2 Assembly and Installation	24
9.2.1 Assembling the bottom	24
9.2.2 Assembling Panel 1	25
9.2.3 Assembly body cooling column	25
9.2.4 Assembling Panel 2	26
9.2.5 Assembling the series housings	26
9.2.6 Assembling the function column	27
9.2.7 Assembly of top module	27
9.2.8 Assembly of panel door	28
9.2.9 Fit the mounting boards into the panel 1 and panel door	29
9.3 Connection of plug-in connections	29-31
9.4 Assembling the housing parts	32
9.4.1 Assembling the panel housing parts	32
9.4.2 Assembly of unit housing	32-34
9.5 Final assembly of fittings	35
9.5.1 Assembly the bottom plate	35
9.5.2 Installing the bottom plate	35
9.6 OPTIONS	35-38
9.6.1 Translucent Canopy with RGB (Optional)	36
9.6.2 RGB-Controller with remote control	37
9.6.3 Translucent canopy with illumination tubes (Optional)	37
9.7 Connecting the Outgoing Air Unit	37
9.7.1 Mounting of the exhaust hose (Optional)	37
9.8 T-Max Timer	38
10. TECHNICAL DATA	39
10.1 Dimensions and UV type*	39
10.2 Lamp covers (filter discs)	39
11 CUSTOMER SERVICE ADDRESS	39

1 SAFETY INSTRUCTIONS:

- 1.1 Before installation and placing in operation, the Safety Instructions and Operating Instructions must be carefully read and observed.**
- 1.2 Before the unit is placed in operation, the local Safety Regulations and the Safety Instructions must be complied with.**

1.3 SAFETY / WARNING

DANGER – ULTRAVIOLET RADIATION

Follow instructions. Avoid overexposure. As with natural sunlight, overexposure can cause eye and skin injury and allergic reactions. Repeated exposure may cause premature aging of the skin and skin cancer. Consult physician before using sunlamp if you are using medication or have a history of skin problems or believe yourself especially sensitive to sunlight. If you do not tan in the sun, you are likely to tan from the use of this product. WEAR PROTECTIVE EYEWEAR: FAILURE TO MAY RESULT IN SEVERE BURNS OR LONG – TERM INJURY TO THE EYES.

Therefore, you must observe the following Safety Instructions:

The ultraviolet and visible radiation is very intense. DO NOT stare at the tanning lamps. While tanning, close your eyes, and always use the protective eyewear that is supplied. Before tanning, always remove jewelry.

DO NOT tan more frequent than once every two days.

For recommendations about exposure times and recommended frequencies, please see below RECOMMENDED EXPOSURE SCHEDULE, which is enclosed with every unit.

RECOMMENDED	Skin Type	WEEK 1 1 ST -3 RD Session	WEEK 2 4 TH -6 TH Session	WEEK 3 7 TH -10 TH Session	WEEK 11 TH -15 TH Session	WEEKLY Subsequent Session
EXPOSURE SCHEDULE	II - Fair	2 min.	2 min.	4 min.	8 min.	8 min.
	III – Average	2 min.	3 min.	5 min.	8 min.	8 min.
	IV– Brown	2 min.	4 min.	6 min.	8 min.	8 min.
	V – Dark Brown	2 min.	4 min.	6 min.	8 min.	8 min.

Tanning can begin on a regular basis. An appearance of tanning normally occurs after a few exposures and maximizes after four (4) weeks of exposure following the recommended exposure schedule of two (2) weekly 8 minute sessions is recommended from the fifth week onward.

USE PROTECTIVE EYEWEAR WHENEVER THE EQUIPMENT IS ENERGIZED.

READ THE INSTRUCTION BOOKLET BEFORE USING THIS PRODUCT.

WARNING

If you have been diagnosed by a physician as being allergic to the sun or are currently taking photosensitive medications, consult your physician before using this product.

Children, persons with fair skin, elderly persons and persons who have a history of skin problems or believe yourself especially sensitive to sunlight, should avoid using this product. If you do not tan in the sun, you are likely to tan from this product.

Certain drugs – particularly those designed to enhance photosensitivity – maybe cause individuals under their influence to experience adverse effects and those people ought to avoid exposure to UV sources of all kinds. Doctors will advise persons taking these drugs of possible adverse effects.

It is recommended that only one person at a time use the tanning system. Use protective eyewear while tanning. One pair of protective eyewear is provided with each unit sold.

Occasionally, persons, using the tanning system will experience a slight reddening of the skin – usually in small patches – after the second or third session. This redness is often accompanied by an itching sensation. This is nothing more than a heat "rash" caused by heat from the lamps within the system. It is generally very limited. It will go away within approximately 24 hours and should not reappear. This rash can be lessened or prevented by applying moisturising lotion to the affected area after the tanning session is complete.

CAUTION:

WHILE THERE IS NO IMMEDIATE CLINICAL EVIDENCE REGARDING UV EXPOSURE AND ITS EFFECTS UPON EXPECTANT MOTHERS, IT IS STRONGLY ADVISED THAT EXPECTANT MOTHERS BE DISCOURAGED FROM USING THIS PRODUCT.

EXPOSURE TIMES AND FREQUENCIES

Melanin, the brownish pigment produced by special cells in the base layers of the skin determines the individual ability to tan. As the skin is exposed to ultraviolet rays, the melanin is activated and combines with protein cells that rise to the skin's surface, thus producing a tan. The amount of melanin in your bodies determining how quickly and darkly you can tan.

NOTE

THE TAN PRODUCED BY THIS UNIT IS A DEEP, RICH "COSMETIC" TAN, HOWEVER, REGARDLESS OF HOW MUCH AN INDIVIDUAL MAY TAN WITH THIS UNIT, IT WILL NOT PROVIDE ADEQUATE PROTECTION AGAINST OVEREXPOSURE TO NATURAL SUNLIGHT OR UVB TANNING SYSTEMS.

SKIN TYPE II - THIS IS THE INDIVIDUAL THAT USUALLY BURNS EASILY AND SEVERELY. TANS MINIMALLY OR LIGHTLY AND PEELS.

SKIN TYPE III - OFTEN REFERRED TO AS "AVERAGE" COMPLEXION.
BURNS MODERATELY AND TANS ABOUT AVERAGE.

SKIN TYPE IV – THIS INDIVIDUAL BURNS MINIMALLY, TANS EASILY AND ABOVE AVERAGE WITH EACH EXPOSURE.

SKIN TYPE V - THIS INDIVIDUAL RARELY BURNS, TANS EASILY

RECOMMENDED EXPOSURE SCHEDULE

RECOMMENDED	Skin Type	WEEK 1 1 ST -3 RD Session	WEEK 2 4 TH -6 TH Session	WEEK 3 7 TH -10 TH Session	WEEK 11 TH -15 TH Session	WEEKLY Subsequent Session
EXPOSURE SCHEDULE	II - Fair	2 min.	2 min.	4 min.	8 min.	8 min.
	III – Average	2 min.	3 min.	5 min.	8 min.	8 min.
	IV– Brown	2 min.	4 min.	6 min.	8 min.	8 min.
	V – Dark Brown	2 min.	4 min.	6 min.	8 min.	8 min.

No two individual skin tones are the same. A tan to one person may be different to another, and session length may vary. It is recommended that, following a tanning session, a skin moisturiser be applied. This promotes a smoother more even looking tan. Equally important – many facial make –ups have oil bases and should be removed prior to each tanning session.

NOTE

SINCE THE BACK AND STOMACH AREAS OF THE BODY WILL RECEIVE THE MAJORITY OF THE TANNING RAYS, IT IS RECOMMENDED THAT INDIVIDUALS SPEND ONE THIRD OF EACH SESSION IN FRONT OF EACH PANEL TO ACHIEVE A FULL-BODIED TAN.

WARNING

COMMERCIALY AVAILABLE CREAMS, LOTIONS AND OILS CONTAIN SUNSCREENS WHICH FORM A PHYSICAL BARRIER ON THE SKIN THAT PREVENTS THE UV RAYS FROM PENETRATING AND INDUCING A TAN. IT IS RECOMMENDED THAT YOU ONLY USE CREAMS, OILS OR LOTIONS THAT **DO NOT CONTAIN POLYTHENE/GLYCOL MONOLAUROATE** AND ARE DESIGNED FOR USE WITH INDOOR TANNING EQUIPMENT. FAILURE TO COMPLY WITH RECOMMENDATIONS AND WARNINGS STATED ABOVE MAY VOID THE MANUFACTURER'S WARRANTY.

WARNING!

THIS UNIT **MUST NOT** BE USED IF THE TIMER IS FAULTY OR IF THE FILTER GLASS PLATE IS BROKEN.



WARNING: ultraviolet radiation-follow instructions-failure to use protective eyewear may result in severe burns or other eye injury-if discomfort develops; discontinue use and consult a physician. Children, persons with fair skin, elderly persons and persons who have a history of skin problems or believe themselves especially sensitive to sunlight, should avoid using this product.

1.4 Proper Use

All units are intended exclusively for indoor tanning of people and for commercial use. The unit must only be operated in areas free from the danger of explosions and in dry rooms. The rooms must be well ventilated. If operated in a tanning salon, the room and solarium itself must be kept clean and hygienic. Any additional use is not regarded as the intended proper use and the manufacturer accepts no liability for any damage that may arise as a result. All risk falls to the user.

Proper use includes observance of the operating, maintenance, and servicing conditions specified by the manufacturer. Servicing and repair work and the like may only be carried out by Customer Service Department or persons commissioned by them. The units may only be used by those who are familiar with them and who have been informed about the dangers. Appropriate accident prevention measures and other generally recognized rules regarding safety and industrial medicine must be observed. Unauthorized changes to the units exclude the liability of the manufacturer for any resulting injury. This applies in particular to injury resulting from the use of lamps and/or filter disks not authorized by PC Marketing.

1.5 Product Liability

The attention of the user is drawn explicitly to the fact that the unit may only be used for the intended purpose. All responsibility and liability falls to the user if the unit is used other than for the intended purpose. The manufacturer no accepts any liability.

1.6 What to do in an Emergency

Remove the mains plug or switch off the power using the main switch or fuses and secure the unit against unauthorized reinitialization.



Warning

1.7 Explanation of Danger Symbols

Warning!

All sections in these operating instructions that relate to your safety are marked with this symbol.

Please also pass on the information regarding safety to other users.



Function

All sections in these operating instructions that contain information regarding the function of the unit are marked with this symbol. Please pay particular attention to this information to avoid damaging the unit.



Important!

All information and notes in these operating instructions are marked with this symbol.

Various figures and diagrams are referred to in the text.
For example (30/2) refers to Figure 30, item 2.

1.8 Position of the User.

In the unit.

INFORMATION FOR THE TANNING SALON PERSONNEL

2 OPERATION

2.1 Equipment - New and proven



Warning

Important Information! To be read by everyone!

Not every model is equipped with all of the modules described here and therefore all options.

1. Check the brochure for the features of your unit.
2. Please observe the instructions which apply to your unit.
3. Please pass on all information to the user.

INTERACTIVE OPERATION

You can regulate the face tanning intensity and the cooling for your body and face separately.

AIR JET BODY COOLING

An air vent is provided in the column segment and in the function column which allows cool air to be directed over the upper part of the body.

FAN

The fans continue to run for about 2 minutes (factory setting) after switching off the unit in order to cool it down.

POWERSPOT

There are three POWERSPOTS in the roof specially for shoulder tanning and seven POWER-SPOTS in the panel 2 of the iDOME specially for face tanning.

BREEZE

There is a nozzle in the function column from which a fine atomised spray of distilled, sterilised water can be sprayed into the tanning area on demand.

AROMA

There is an AROMA module in the column segment of the unit. When the AROMA module button is pressed, fragrance is sprayed into the tanning area for 30 seconds. During this time the LED in the AROMA button lights up.

SERVICE MODULE

The service module allows you to monitor the operating hours according to the total operating hours of the solarium, the operating time of the ND lamps and POWERSPOTS.

The service module displays error messages.

The service module facilitates maintenance and inspection of parts for wear (see Ch. 5).

AUDIO SYSTEM

The unit may be connected to an external sound system.

CONNECTION TO CELL PHONE

The unit has a connection for your cell phone with which you can hear your own music.

LOUDSPEAKER

If you prefer, you can equip your solarium with two speakers allowing you to enjoy the music played on the central sound system while you tan.

2.2 Preparation

1. Stand in the center of the iDOME.
2. Use the hand rail to close the iDOME.

2.3 Starting



Warning

Observe the tanning schedule.

Do not exceed the recommended tanning times for your skin type. Avoid sunburn.

Never exposure yourself to ultraviolet light if you already have a sunburn.

Your final tan (when your skin does not darken any more) depends on your skin type.

Your tan cannot be intensified by using a solarium but only maintained by it.

Close your eyes while tanning and always wear the protective goggles provided.

People who have undergone surgery to their eye lenses must wear protective goggles.

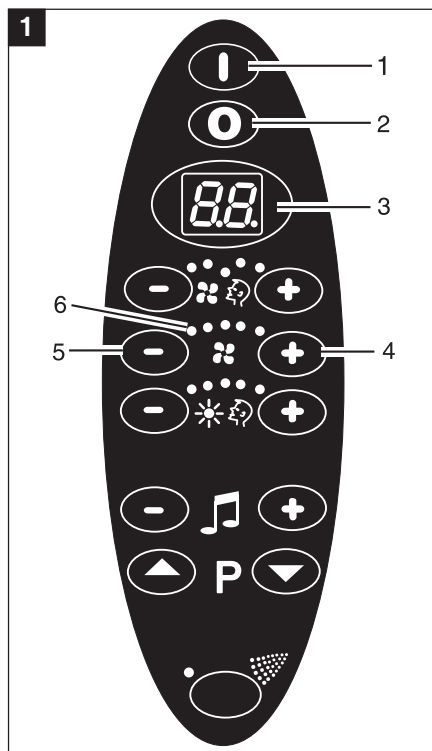

Operating and display elements:

- [START] button (1/1)
- [STOP] button (1/2)
- Display (1/3)

2.3.1 Starting by inserting a coin

1. Insert coins or chips into the coin meter.
The unit starts automatically after the warming-up period, depending on whether central control desk or coin timer is used.
2. If you want to start the unit before the end of the warming-up period, press the START- button (1/1) (Early start).
3. You can interrupt the tanning session by pressing the STOP button (1/2).
The tanning time continues during this interruption, i.e. the display (1/3) continues to count.

2.3.2 Starting in private operation

1. Actuate START-button (1/1) on the operating unit.
2. Increase the tanning time in one-minute increments by repeatedly actuating START-button (1/1).
3. Reduce the tanning time in one-minute increments by repeatedly actuating STOP-button (1/2).
The desired tanning time must be set within 20 seconds.
Tanning begins 5 seconds following the initial actuation of START-button (1/1).
4. If you would like to switch off the unit before the set time has passed, actuate the STOP-button (1/2).
The flashing display shows the remaining tanning time.
5. Actuate START-button (1/1) again to continue the tanning session.
You have up to 60 minutes to continue the tanning session.
With STOP-button (1/2), you can interrupt the tanning session at any time.
6. Actuate STOP-button (1/2) again and the tanning session is completely interrupted and the display (1/3) reset to zero.

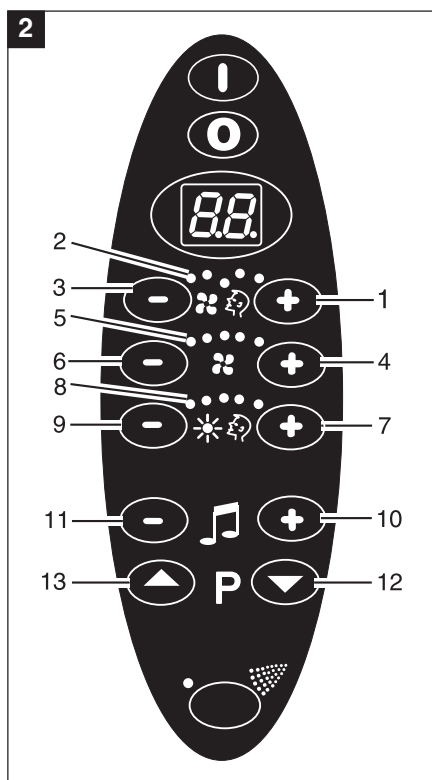

2.3.3 Head end fan

Operating and display elements

- [+] button (2/1)
- [-] button (2/3)
- LED (2/2)

The buttons control the infeed of cooling air over the head. Actuate [+] (2/1) to increase the intensity of the cooling air infeed; actuate [-] (2/3) to reduce the intensity. You can select from 3 levels. The 5 LEDs (2/2) are switched on appropriately for the 3 levels. If you would like to completely switch off head cooling, actuate the [-] (2/3) button for three seconds while on level 1. The previously set level is retained when restarting tanning. If head cooling was switched off, the unit starts on level 2.

2.3.4 Body fan

Operating and display elements

- [+] button (2/4)
- [-] button (2/6)
- LED (2/5)

The buttons control the infeed (2/4) to increase the intensity of the cooling air infeed; actuate [-] (2/6) to reduce the intensity. You can select from 3 levels. The 5 LEDs are switched on appropriately for the 3 levels. If you would like to completely switch off body cooling, actuate the [-] (2/6) button for three seconds while on level 1.

The previously set level is retained when restart-ing tanning.

If body cooling was switched off, the unit starts on level 2.

2.3.5 Facial tanning

Operating and display elements

- [+] - Taste (2/7)
- [-] - Taste (2/9)
- LED (2/8)

The buttons control the intensity of facial tanning. Actuate [+] (2/7) to increase the intensity of facial tanning; actuate [-] (2/9) to decrease the intensity. You can select from 3 levels. The 5 LEDs are switched on appropriately for the 3 levels. If you would like to completely switch off facial tanning, actuate the [-] (2/9) button for 3 seconds while on level 1.

The previously set level is retained when restart-ing tanning. If facial tanning was previously switched off, the unit starts on level 3 (highest level).

If tanning is interrupted and reactivated within 2 minutes, the active LEDs flash for 2 minutes, i.e. high pressure lamps require up to 2 minutes before they are again energized. Upon conclusion of the tanning time, the high pressure lamps are switched off level by level.

2.3.6 AUDIO

• Program selection

Operating elements

- button (2/12)
- button (2/13)

Use (2/12) and (2/13) to select from the entertain-ment programs which are fed into the unit.

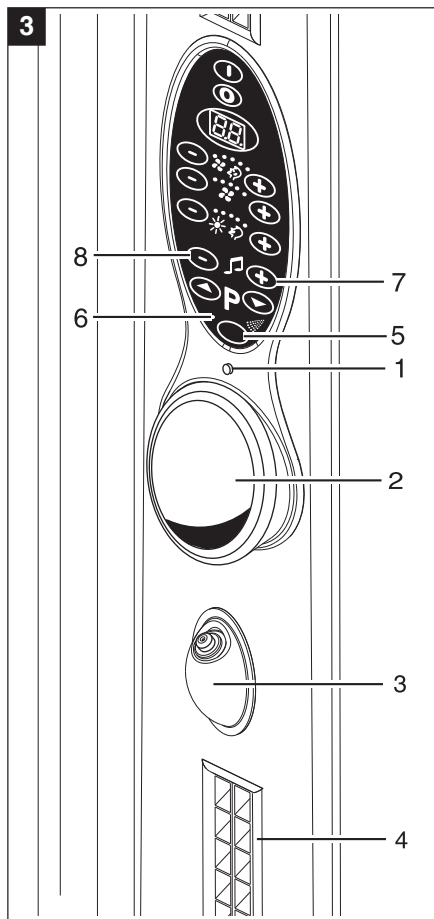

• Volume

Operating elements

- [+] button (3/7)
- [-] button (3/8)

With the two buttons, you can control the volume of the entertainment being fed into the unit. Actuate [+] (3/7) to increase the volume; actuate [-] (3/8) to decrease the volume.

Connection to cell phone

Operating elements

- Socket (3/1)
- Cell phone holder (3/2)

Plug the cell phone jack into the socket (3/1). Thus the music played on the central sound system is interrupted and you can listen to your own music.

2.3.7 BREEZE

Operating and display elements

- BREEZE button (3/5)
- LED (3/6)

Press the button (3/5) with the symbol for BREEZE for a fine mist of distilled water to be spray from the nozzle (3/3) located above the body fan (3/4) onto the body and face.

The LED (3/6) lights up during the spray cycle. After approx. 40 seconds (pause time) BREEZE can be reactivate.

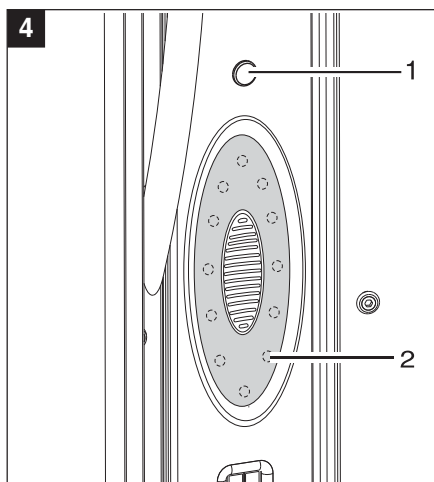

2.3.8 AROMA

Operating and display elements

- Button AROMA (4/1)
- LED (4/2)

1. Press the button above the AROMA module. The button is illuminated by LED.
2. The AROMA module is active for 10 seconds. The LED illumination is on during this time.
3. After approx. 30 seconds (pause time) AROMA can be reactivated.

2.3.9 Fault indicators

When the preset service intervals have been reached for the following functions, the right decimal point illuminates (5/1):

- BREEZE
- POWERSPOT
- LP lamps

BREEZE has the following special feature: If the preset service interval is exceeded by a relatively long period of time, the continuously illuminated right decimal point begins to flash and the BREEZE function is deactivated.

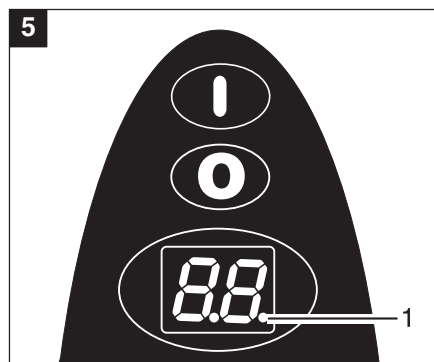

Please inform the salon personnel.

Function

2.4 Cleaning the floor plate, the acrylic sheet panel and the handles.



Warning

The floor plate, the acrylic sheet panel and the handles of the panel must be disinfected and cleaned following each tanning session.

Only use uwe "PICOBELLO" cleaning agent!

Always pay great attention to hygiene.

Keep uwe cleaning agent or other cleaning agents out of your eyes.

Do not spray near an open flame.

Do not drink.

Keep out of reach of children.

Follow the manufacturer's instructions for the cleaning agent and take account of the specified activation time.

Never pour liquid directly onto the unit to avoid the risk of moisture getting inside and affecting the electrical equipment.

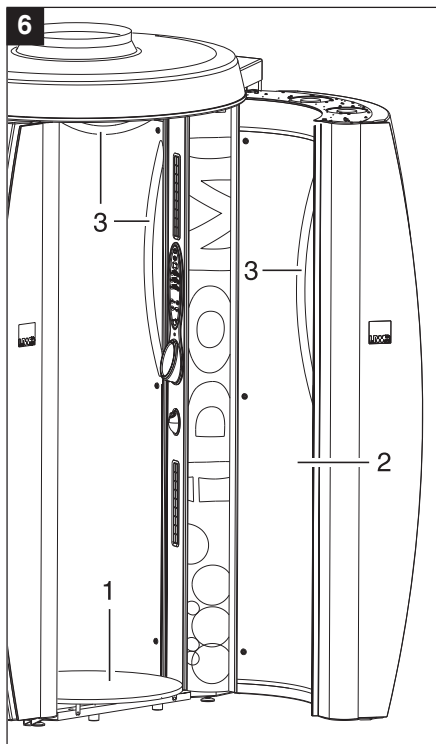

Cleaning the floor plate, the acrylic sheet and the panel handles

1. Clean the floor plate (6/1), the acrylic sheet (6/2) and the panel handles (6/3) after each tanning session using uwe **PICCOBELLO** cleaner or Paletti Hydro fleece.
2. When using uwe **PICCOBELLO** cleaner, spray it onto the acrylic sheet bed and allow it to act for approx. 1 minute.
3. Always dry the panel afterwards with a clean cloth.

INFORMATION FOR THE USER

3 Initial operation

3.1 Important Information!



Warning

To be read by everyone! Never switch on a defective sun bed.

Ensure the maximum permissible room temperature (35°C) is not exceeded, otherwise the unit may overheat.

Observe the requirements with regard to hygiene.

Be sure to provide protective goggles and ensure that they are worn.

Point out that the permitted tanning time depends on the type of skin.

Make sure the assembly and operating instructions are always available.

Be sure the safety instructions and tanning schedules are clearly visible in the tanning cubicle.

Use the unit only in the closed state for a longer period of time.

3.2 Before initial operation

Safety regulations and operating instructions must be read carefully and taken into account before installation and start-up.

3.3 Using the unit for the first time

Before each initial operation all local safety regulations and safety warnings must be observed.

Once the unit has been fully assembled, connected to the power supply and coin-operated timer or central control unit, it can be switched on.

The tasks described in the following sections are to be performed during the initial commissioning.

3.3.1 Specifying coin-operated/private operation

The unit is configured for coin operation upon delivery from the factory.

If the unit is to be operated privately, you must set the unit for private operation prior to initial start-up.

To do this, a jumper must be repositioned on the mounting plate (behind the panel 2).



Warning

Danger to life !

De-energize the unit and protect against accidentally being switched back on!

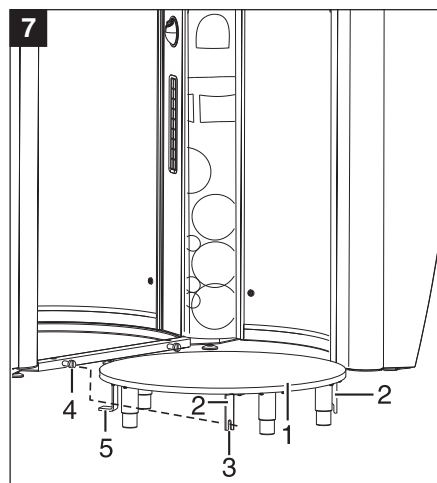

Removing the bottom plate

1. The base plate (7/1) is plugged in the front with two fittings (7/3) at the cross strut of the metal bottom. Lift the base plate (7/1) until the fittings (7/4) are free.
2. Pull the base plate (7/1) forwards to unplug the dump protection (7/5) in the back area.
3. Tilt the bottom plate (7/1) carefully outside the unit.

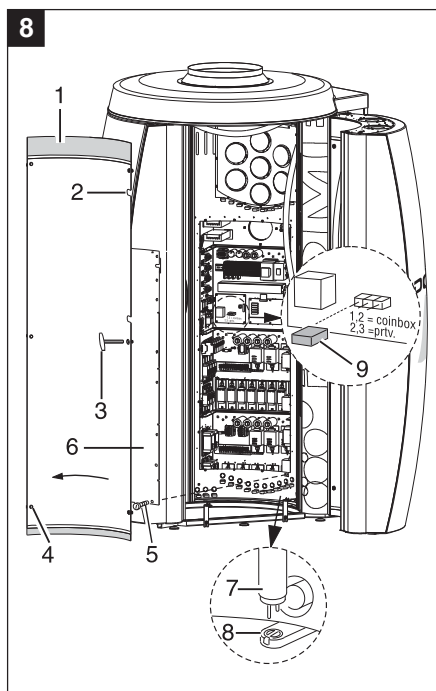

Remove the acrylic panel

1. Unlock the six lock bolts (8/4) with the Allen key (8/3).
2. Move the acrylic panel (8/1) a little to the left to allow the grooves (8/2) to slide out of the locking device at the handle.
3. Now you can take out the acrylic panel (8/1) to the front.
4. Put the acrylic sheet panel aside.

Changing the sunlamp

1. Turn the sunlamp (8/7) in either direction until the contact pins can be seen in the groove of the lamp holder (8/8).
2. Remove the lamp (8/7).
3. Remove all sunlamps to be able to remove the mounting board covers.

Remove the service compartment cover 1

1. Remove the screws (8/5) of the mounting board (8/6) cover.
2. Lift off the cover.

The unit is configured for coin operation upon delivery from the factory.

Position of jumper for coin operation 1,2 coin-box(factory setting).

Position of jumper 2,3 privt. for private operation.

Configuring unit for private operation

1. Pull the jumper (8/9) out of position 1,2 coinbox, from the left and center post connectors.
2. Connect the jumper (8/3) in position 2,3 on the center and right post connectors for private operation.

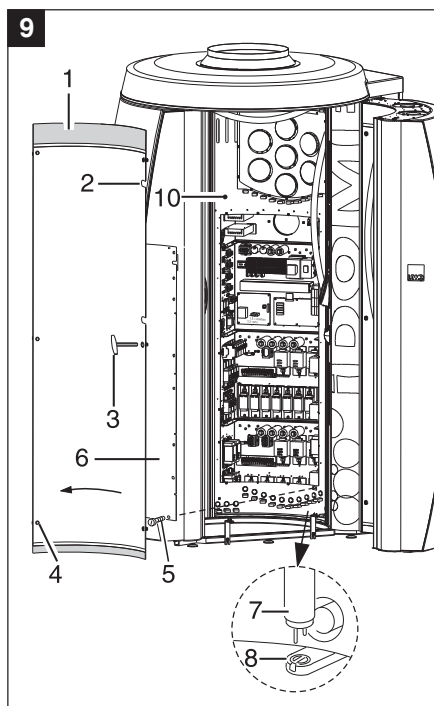

Further procedure

• Reflector

Wipe off the reflector (9/10) with a cloth moistened with alcohol.

Mounting the cover of service compartment 1

1. Take the mounting board cover (9/6).
2. Fasten the cover with the screws (9/5) on the reflector.

Mounting the sunlamps

1. Hold the sunlamp (9/7) in vertically so that the contact pins are vertically above each other.
2. Press the sunlamp into the lamp holder (9/8) in this position.
3. Turn the sunlamp 90 degrees so that the notch in the metal ring at the end of the lamp is at the top. Install all the sunlamps.

Fitting the acrylic panel

1. Take the acrylic panel (9/1). The grooves (9/2) must point towards the handle.
2. Push the acrylic panel (9/1) with its grooves (9/2) to the right in the direction of the handle.
3. Turn the six bolts (9/4) of the acrylic panel (9/1) back using the Allen key (9/3) so that the acrylic panel is secured firmly in place.

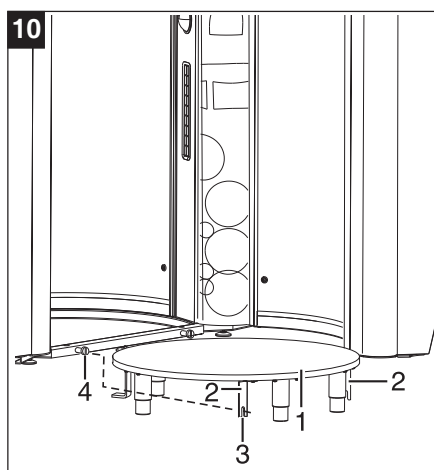

Installing the bottom plate

1. Take the base plate (10/1) tilty into the unit.
2. Lift up the bottom plate (10/1) in the front and plug in the two fittings (10/3) at the cross strut (10/4) of the metal bottom.
The bottom plate is fixed.

3.4. Connecting the BREEZE tank

As supplied from the factory the BREEZE tank is not yet connected up.
The closed tank is placed in its final location in the service compartment 2.

Open service compartment 2

1. Close the iDOME.
2. Unlock the three lock bolts (11/2) with the Allen key (11/1).
3. Open the door (11/3).

Connecting the BREEZE tank

1. Unscrew the lid (11/6) from the full BREEZE canister (11/7).
2. Take the cover (11/5) with the tube connections out of the unit and pull the tubes off the quick-acting hose connector.
3. Screw the cover (11/5) with the supply connections onto the full canister (11/7).
4. Insert the tube (11/8) from the pump into the green quick-acting hose connector (11/8a) as far as it will go.
5. Insert the tube (11/9) from the solenoid valve into the red quick-acting hose connector 11/9a) as far as it will go.
6. Put the full BREEZE canister (11/7) in the service compartment.
7. Close the service compartment door (11/3) Lock the door (11/3) using the Allen key (11/1).

3.4.1 Bleeding the BREEZE lines

The BREEZE lines must be bled during the initial commissioning, following service work on the BREEZE system and after changing the tank. See Chapter 6.6.3.



Warning

To do this, use the service module in the operating unit. Follow the instructions as described in Chapter 5.1.3. Page 13 under program PrP5.

3.4.2 Connecting AROMA bottle



Warning

Disconnect the unit from the power supply. When working with the AROMA module, please wear gloves. Take note of the housing edges. Work with care.

The AROMA module is located in the column segment of the iDOME.

On delivery from the factory, the plastic bottle for AROMA is not yet connected. It is supplied in a separate carton.

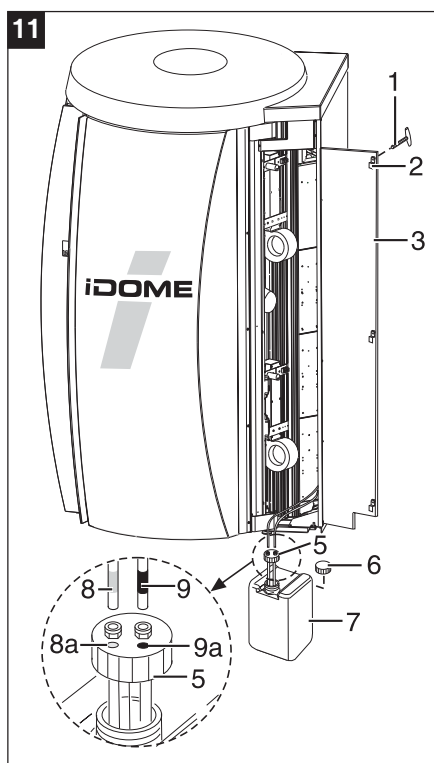

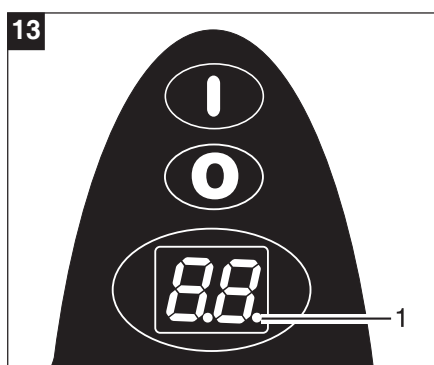
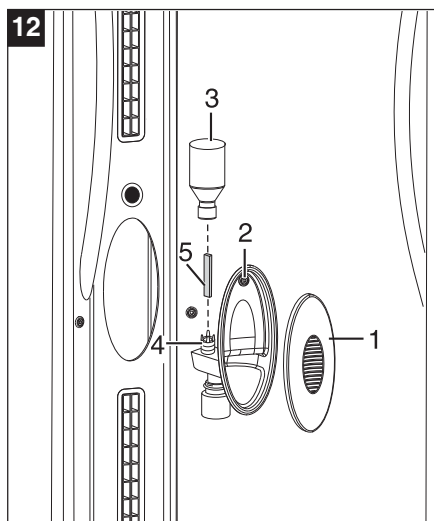

Connecting the AROMA bottle

1. Remove the protective grid (12/1).
2. Rotate both bolts (12/2) with the Allen key through 90° to the left.
3. Remove the complete AROMA module from the plastic housing.
4. Take the evaporation fleece (12/5) and place the evaporation fleece in the level tube (12/4).
5. Put the full bottle (12/3) on the level tube (12/4).
6. Turn the bottle in clockwise direction on the level tube.
Take care to ensure that you tighten the bottle with gentle pressure.
7. Re-insert the AROMA module into the opening provided in the plastic cover.
8. Rotate the bolt (12/2) with the Allen key through 90° to the right.
9. Re-insert the protective grid (12/1).

3.5 Audio system

A connection plate for an external audio system is provided through which a non-amplified audio signal can be fed.

Tape recorders or CD players provide a suitable signal for this purpose.

3.6 Error messages

When the preset service intervals have been reached for the following functions, the right decimal point illuminates (13/1):

- BREEZE
- POWERSPOT
- Low pressure lamps

BREEZE has the following special feature:

If the preset service interval is exceeded by a long period of time, the continuously illuminated right decimal point begins to flash and the BREEZE function is deactivated.

See Chapter 5.1 Service intervals.

4 CLEANING – IMPORTANT INFORMATION FOR THE OPERATOR



Observe the utmost hygiene for the sun bed and its surroundings.
Dust deposits reduce the tanning effect.

Warning

Use only uwe cleaner!

Keep cleaning agents away from the eyes!

Do not spray cleaning agent near a naked flame!

Do not drink!

Keep out of reach of children!

Do not pour liquid directly onto the unit to avoid moisture affecting the electrical equipment.

Follow the manufacturer's instructions for the cleaning agent and take account of the specified activation time.

There is no liability or warranty if other cleaning agents are used.

4.1 Cleaning agent

PICCOBELLO is very well suited for disinfection, deodorizing and daily cleaning of all types of surfaces, particularly in tanning salons and fitness studios. **PICCOBELLO** is supplied by uwe in concentrated form and must be mixed with water to produce a diluted solution which is ready for use.

Mixing PICCOBELLO ready for use

Mix 15 ml of "PICCOBELLO" with 1 litre of water. This produces a 1.5 % solution which requires an activation time of 1 minute.

4.2 Unit body

1. Clean the painted surfaces of the unit with a damp cloth; some detergent can be mixed in with the water. Do not use any abrasive materials.
2. To clean stubborn soiling, use a soft cloth and a biodegradable cleaning agent.

4.3 Acrylic Panel sheets

Use cleaning agents according to instructions and adhere to the reaction time specified by the manufacturer.

4.3.1 Cleaning acrylic panel sheets

1. Only use original uwe PICCOBELLO cleaning agent or Paletti Hydro Vlies for cleaning the acrylic sheets.
2. If using the PICCOBELLO cleaning agent, spray it onto the bed acrylic and leave to work for approx. 1 minute.
3. Always dry the acrylics after cleaning with a clean cloth.
4. From time to time, clean the rear side of the bed acrylic.



Acrylic sheets must not be cleaned with cleaning agents which contain alcohol.

Important!

The frosted side of the acrylic sheet bed (LIGHTGLASS) must not be treated with polishing agent.

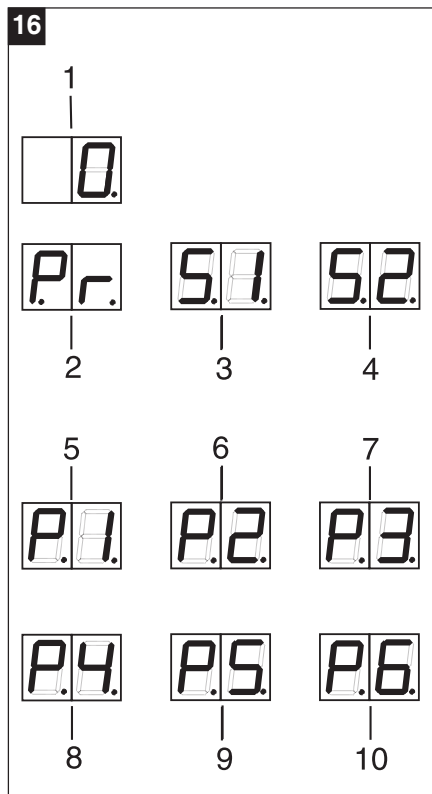
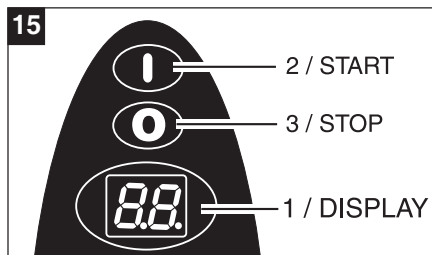
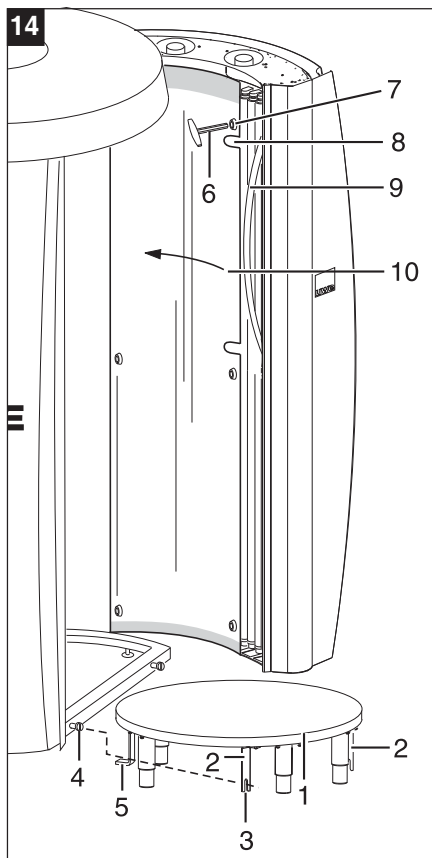

4.3.2 Cleaning the rear side Acrylic sheet

Removing the bottom plate

1. The base plate (14/1) is plugged in the front with two fittings (14/3) at the cross strut of the metal bottom.
2. Lift the base plate (14/1) forwards to unplug the dump protection (14/5) in the back area.
3. Tilt the bottom plate (14/1) carefully outside the unit.

4.3.2 Cleaning the back of the acrylic sheet

1. Unlock the six lock bolts (14/7) with the Allen key (14/6).
2. Move the acrylic panel (14/10) a little to the left to allow the grooves (14/8) to slide out of the locking device at the handle.
3. Now you can remove the acrylic panel (14/10) to the front.
4. Clean the bottom of the acrylic sheet (14/10).
5. Always dry with a clean cloth after cleaning.

Fitting the acrylic panel

1. Take the acrylic panel (14/10). The grooves 14/8) must show to the handle.
2. Push the acrylic panel (14/9) with its grooves (14/7) to the right side in direction of the handle (14/9).
3. Turn the six bolts (14/7) of the acrylic panel (14/10) back with the Allen key (14/6) so that the acrylic panel is secured firmly in place.

Mounting and cleaning the bottom plate

1. Take the base plate (14/1) tilty into the unit.
2. Lift up the bottom plate (14/1) in the front and plug in the two fittings (14/3) at the cross strut (14/4) of the metal bottom. The bottom plate is fixed.
3. Clean the bottom plate
4. Always dry with a clean cloth after cleaning.

• Reflectors

Wipe off the reflectors using a cloth moistened with alcohol when replacing the reflectors.

5 KNOW HOW FOR THE OPERATOR

5.1 Service module (Operating hours, error messages)

5.1.1 Service module

The operating unit (15/1) is used to display various operating states and error messages and provides service information.

The unit is operated with the buttons on the key pad. In the standby mode, the display shows the value zero (15/1).

The service module includes three menus for calling up operating states and for reading error messages on the display (15/1) and (16/1):

- Program menu Pr (16/2)
- Service menu S1 (16/3)
- Service menu S2 (16/4)

5.1.2 Operating the service module (see Service module at a glance on page 14)

1. Simultaneously actuate **[START]** (15/2) and **[STOP]** (15/3) for approx. 4 seconds:
The program menu **Pr** (16/2) appears on the display.
2. Actuate **[START]** to change between the three menus.
The program menu **Pr**, service menu **S1** or service menu **S2** appears.
3. To enter the program, press **Pr [STOP]** in the program menu.
The top menu level **P1** (16/5) appears.
4. Use **[START]** to switch to the next menu level
5. Actuate **[STOP]** to display the parameters, e.g. operating hours. Two values are displayed alternately. The single digit which is displayed is the tenths place; the two digits which are displayed represent the thousands and hundreds places, respectively.
6. Actuate and hold down **[START]**.
Read the tens and single digit places
7. Simultaneously actuate **[START]** and **[STOP]** and hold down for approx. 4 seconds to set the time counted up to now to zero (16/1) (reset), e.g. after replacing a lamp.
8. On the top menu level **Pr**, again actuate **[START]** and **[STOP]** simultaneously for approx. 4 seconds.
The service menu is exited and the display switches to the standby mode.



If the unit is disconnected from the power supply within 5 minutes following completion of the service module, the changed parameters are stored and activated.
Wichtig!

If parameters are changed, but not confirmed after exiting from the service module by disconnecting from the power supply, all settings remain as they were prior to entering the service module.

For further information on the service module, refer to the diagram on page 14.

5.1.3 Service module menus



Program menu Pr

- Operating hours can be read in the program menu.
 - PrP1: operating hours solarium
 - PrP2: operating hours lamps, LP lamps, HP lamps for the body tanners, side tanner in the multifunction unit
 - PrP3: operating hours HP lamps for the facial tanner, POWERSPOT
 - PrP4: BREEZE spray cycles
 - PrP5: Bleed BREEZE, necessary during
 - initial commissioning see Chapter 3.4.1
 - tank change and service work on the BREEZE system see Chapter 6. Servicing and Maintenance.
 - PrP6: Operating hours AROMA
 - PrP7: Not engaged
 - PrP8: Audio: adjustment of basic volume from 1 to 64
 - PrP9: Audio: adjustment of maximum volume from 1 to 64
 - PrP10: Lamp aging (only for Electronic Ballasts)
- Example: by actuating **[STOP]** in the programmenu **P2**, the currently elapsed operating hours are read for the lamps, LP lamps and POWERSPOT in the body tanner.
- Reading the operating hours: Two values are displayed alternately. The single digit which is displayed is the tenthousands place; the two digits which are displayed represent the thousands and hundreds places, respectively.
- Actuate and hold down **[START]**. Read the tens and single digit places.
- Simultaneously actuate **[START]** and **[STOP]** and hold down for approx. 4 seconds to set the time counted up to now to zero (5-2/1) (reset), e.g. after replacing a lamp.
- If an operating hour counter has reached its limit value, the right decimal point of the 7-segment display illuminates on the display.



Important!

If the unit is disconnected from the power supply within 5 minutes following completion of the service module, the changed parameters are stored and activated.



Service menu S1

In service menu S1 you can read:

- S1P1: the cooling time of the fan: must not be changed
- S1P2: not assigned
- S1P3: not assigned
- S1P4: limit value of the operating hours for: LP lamps and HP lamps. If the limit value is reached, the right decimal point on the display illuminates.
- S1P5: limit value of operating hours for: operating hours HP lamp and POWERSPOT. If the limit value is reached, the right decimal point on the display illuminates.



Important!

If the unit is disconnected from the power supply within 5 minutes following completion of the service module, the changed parameters are stored and activated.



Service menu S2

In service menu S2 you can read:

- S2P1: reading the error memory



Important!

If the left decimal point illuminates, one or more errors are stored.



- Use **[STOP]** to access the error display. Error messages in the service menu S2 are displayed with an **E** in the left position and an error number in the right position, e.g. E2.
- By repeatedly actuating **[START]**, you can cycle through the error memory and display up to the last 10 errors.



Important!

If an error message appears on the display: Contact uwe customer service or your specialized dealer.

Do not yet clear the error memory. Rather, first consult uwe customer service or your specialized dealer.

The service at a glance

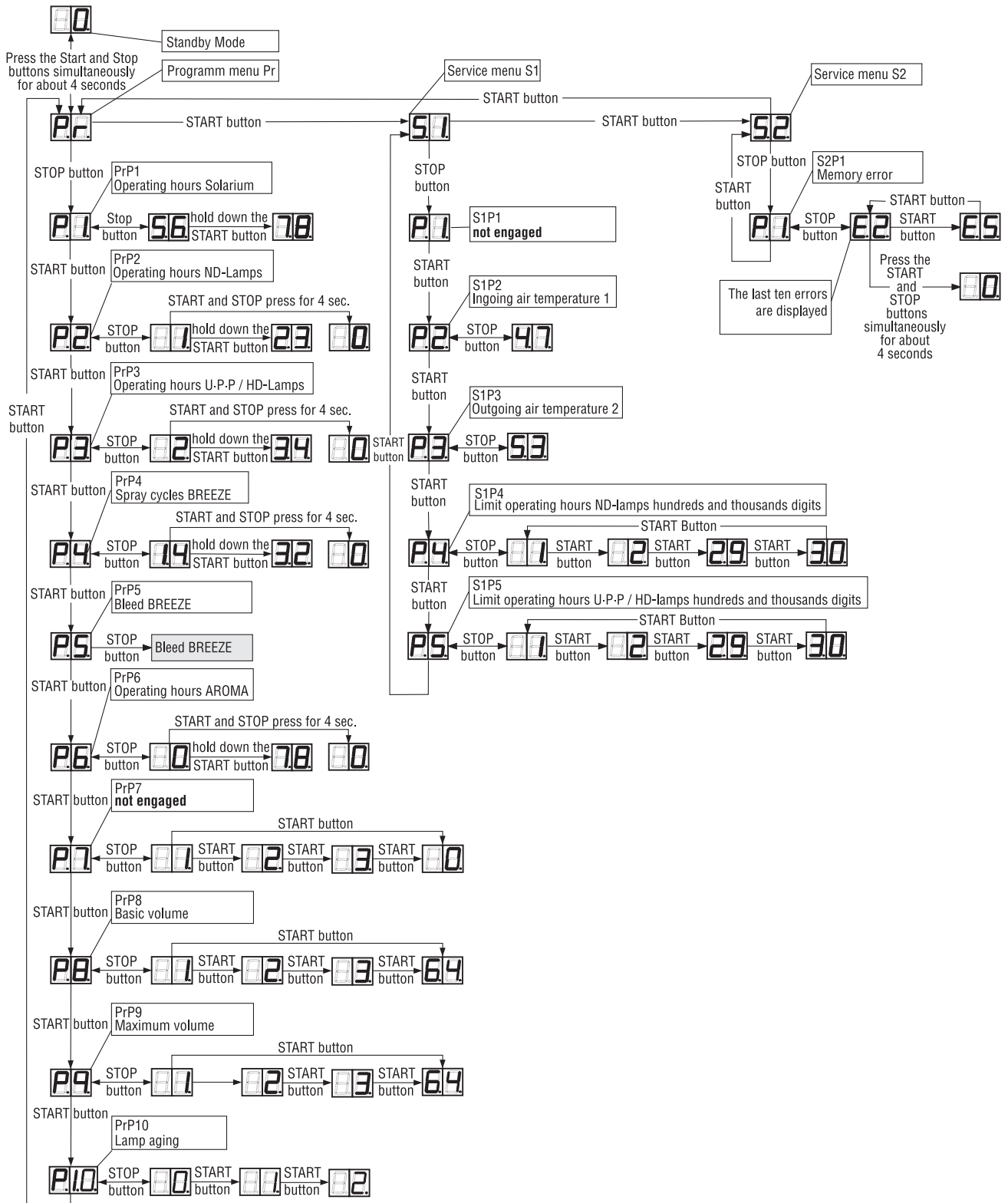

5.2 Preset service intervals



When the preset service intervals are reached, the right decimal point on the display illuminates continuously.

5.2.1 Overview of Possible Settings

	Factory Settings	Possible setting ranges for the operator	
		Minimum value	Maximum value
Overrun time	6 minutes	0 Min.	10 Min.
Low-pressure lamps	500 operating hours (hrs)	350 hrs	700 hrs
POWERSPOT	500 operating hours (hrs)	350 hrs	700 hrs
Filter mats	150 operating hours	100 hrs	300 hrs
Starter	1000 operating hours	700 hrs	1400 hr
BREEZE Module	2000 <i>spraying</i> operations	Cannot be changed, counts up of spraying operations from 0. Warning! After 1920 activations the BREEZE button is locked	

6 SERVICE AND MAINTENANCE



Warning

For servicing and maintenance work, always disconnect the unit from the power supply! Protect the unit from being switched back on accidentally!

Be certain to adhere to the safety and warning notices as specified in Chapter 1.

The operator must ensure that the equipment is only use when it is in perfect working order.

Be sure that technical equipment is inspected and serviced regularly.

During repair or start-up, additional measures must be taken to prevent unauthorized access to the safety area.

Only authorized persons may work on the equipment, contact your authorized dealer or uwe Customer Service for further details.

Do not do anything which could impair the safety of the equipment.

Order original spare parts only from your specialized dealer or uwe.

No liability can be assumed if parts other than the original spare parts are installed.



Warning

Do not operate the unit without the acrylic sheets.

6.1 Replacing the acrylic (panel) sheets

The acrylic sheets are made of special plastic with high UV penetrability.

Therefore, when replacing, never use window glass or standard acrylic, as these filter the UV radiation either partially or completely.

Always order the original acrylic sheets from your specialized dealer or unit manufacturer.

Upon delivery of replacements, the acrylic sheets are covered on both sides with a protective foil. Remove the foil before installing in the tanning unit.

Do not operate the unit without acrylic sheets, as cooling of the unit cannot otherwise be ensured.



Important!

In the event of damages, the manufacturer assumes no liability.

LIGHTGLASS

The acrylic panels of each unit panel are frosted on one side.

6.1.1 Replacing the Acrylic sheet panels

Removing the bottom plate

1. The base plate (17/1) is plugged in the front with two fittings (17/3) at the cross strut of the metal bottom. Lift the base plate (17/1) until the fittings (17/4) are free.
2. Pull the base plate (17/1) forwards to unplug the dump protection (17/5) in the back area.
3. Tilt the bottom plate (17/1) carefully outside the unit.

Removing the acrylic sheet panels

1. Unlock the six lock bolts (17/7) with the Allen key (17/6).
2. Move the acrylic panel (17/10) a little to the left to allow the grooves (17/8) to slide out of the locking device at the handle.
3. Now you can move the acrylic panel (17/10) to the front.

Fitting the new acrylic panel

1. Take the new acrylic panel (17/10). The grooves (17/8) must point towards the handle.
2. Push the acrylic panel (17/10) with its grooves (17/8) to the right side in direction of the handle.
3. Turn the six bolts (17/7) of the acrylic panel (17/10) back with the Allen key (17/6) so that the acrylic panel is secured firmly in place.

Installing the bottom plate

1. Take the base plate (17/1) tilty into the unit.
2. Lift up the bottom plate (17/1) in the front and plug in the two fittings (17/3) at the cross strut (17/4) of the metal bottom. The bottom plate is fixed.

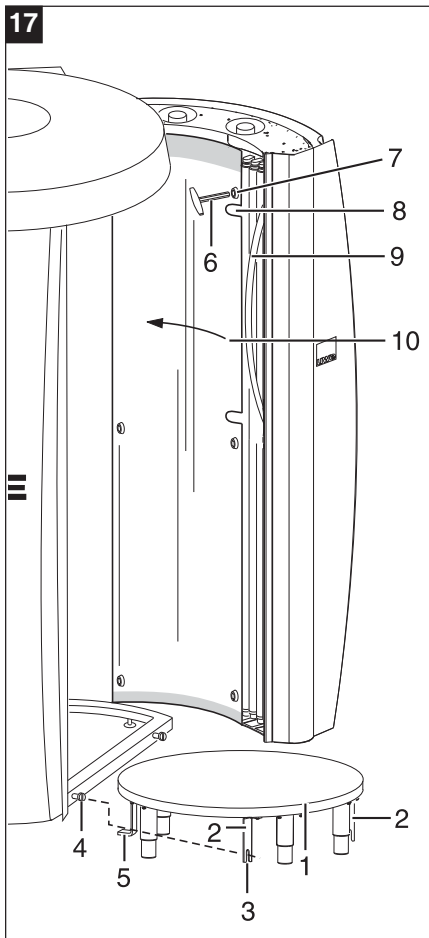

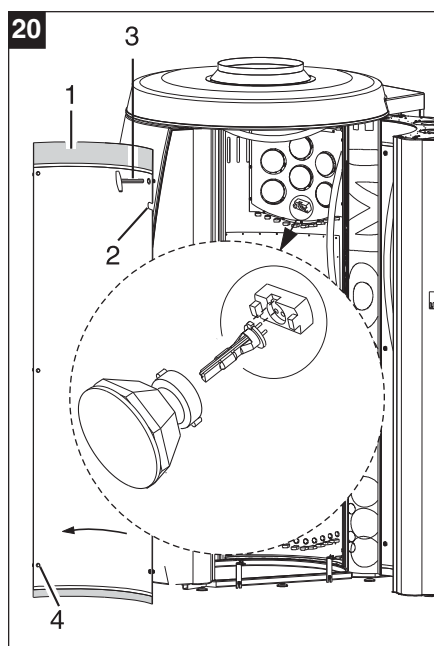
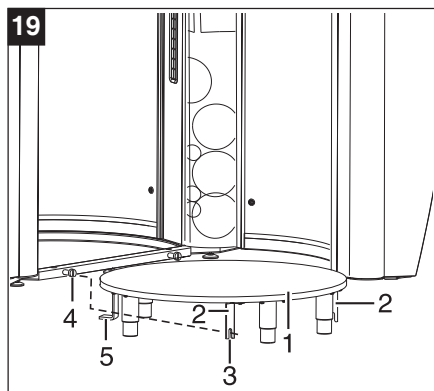
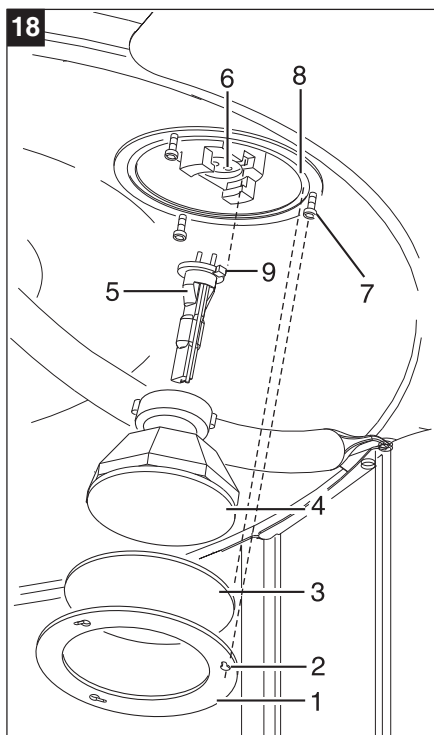

6.2 Changing the POWERSPOT

There are three POWERSPOTS in the roof specially for shoulder tanning and seven POWERSPOTS in the panel 2 of the iDOME specially for face tanning.

6.2.1 Changing the high pressure lamp



Attention!

Warning

Transport the sunlamp in its packing to the place of installation.

Wear gloves when replacing the sunlamp.

Never touch the sunlamp with your fingers, as fingerprints will damage the sunlamp.

Remove possible soiling with a clean cloth soaked in rubbing alcohol.

Never install a damaged sunlamp. Before installing the sunlamp, check, if it shows mechanical damage.

Before opening the decive to replace a sunlamp, always disconnect all poles of the decive from the mains and wait until the tube has cooled completely.

Wear goggles to protect yourself against exploding lamps.

6.2.2 Exchanging the POWERSPOT in the top

1. Loosen the socket head screws (18/7).
2. Rotate the cover ring (18/1) anticlockwise until the heads of the screws (18/7) in the large holes (18/2) are visible. Now you can remove the cover ring (18/1) and the cover disk (18/3) to the bottom. The cover disk (18/3) is located on the cover ring (18/1) in the groove (18/8), make sure that it does not fall down when you remove the cover ring.
3. Remove the reflector (18/4) of the POWERSPOT by pressing slightly against the socket and turning it anticlockwise.
4. Hold the high pressure lamp (18/5) (see item 6.2.1). Pull out the lamp.
5. Hold the new high pressure lamp (18/5) (see item 6.2.1). Please pay attention to the coding (18/9). Plug the new high pressure lamp (18/5) into the socket (18/6).
6. Insert the reflector (18/4) of the POWERSPOT by pressing slightly on the socket and turning it clockwise.
7. Take the cover disk (18/3), insert it into the groove (18/8).
8. Press the cover ring (18/1) with the corresponding holes (18/2) onto the socket head screws (18/7).
9. Rotate the cover ring (18/1) clockwise until it locks in the grooves.
Tighten the socket head screws (18/7).

6.2.3 Exchanging the POWERSPOT in Panel 2

Removing the bottom plate

1. The base plate (19/1) is plugged in the front with two fittings (19/3) at the cross strut of the metal bottom. Lift the base plate (19/1) until the fittings (19/4) are free.
2. Pull the base plate (19/1) forwards to unplug the dump protection (19/5) in the back area.
3. Tilt the bottom plate (19/1) carefully outside the unit.

Remove the acrylic panel

1. Unlock the six lock bolts (20/4) with the Allen key (20/3).
2. Move the acrylic panel (20/5) a little to the left to allow the grooves (20/2) to slide out of the locking device at the handle.
3. Now you can take out the acrylic panel (20/5) to the front. Put the acrylic sheet panel aside.

Exchanging the POWERSPOT

1. Remove the reflector (20/6) of the POWERSPOT by pressing slightly against the socket and turning it anti-clock-wise.
2. Pull out the lamp (20/7) (see item 6.2.1).
3. Hold the new high pressure lamp (20/7) (see item 6.2.1). Please pay attention to the codification (20/8). Plug the new high pressure lamp (20/7) into the socket (20/9).
4. Insert the reflector (20/6) of the POWERSPOT by pressing slightly on the socket and turning it clock-wise.

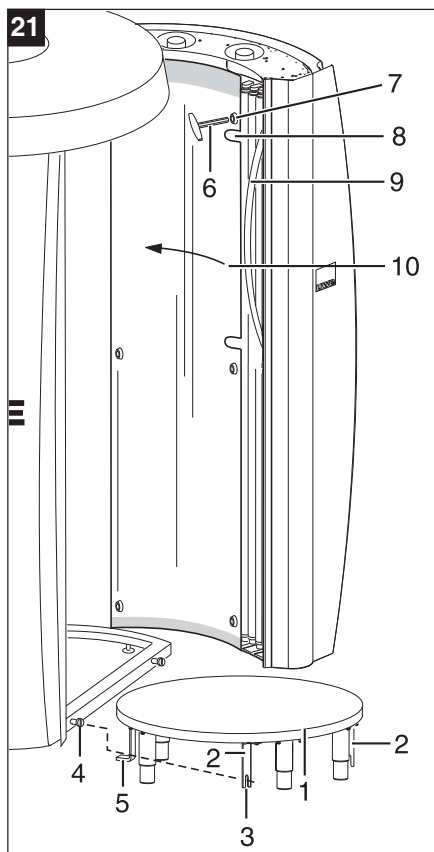

Fitting the acrylic panel

1. Take the acrylic panel (21/10).
The grooves (21/8) must point towards the handle (21/7).
2. Push the acrylic panel (21/10) with its grooves (21/8) to the right in the direction of the handle (21/9).
3. Turn the six bolts (21/6) of the acrylic panel (21/10) back using the Allen key (21/6) so that the acrylic panel is secured firmly in place.

Installing the bottom plate

1. Take the base plate (21/1) tilty into the unit.
2. Lift up the bottom plate (21/1) in the front and plug in the two fittings (21/3) at the cross strut (21/4) of the metal bottom.
The bottom plate is fixed.

6.3 Exchanging the Sunlamp



De-energize the unit and protect against accidentally being switched back on!

Warning

Removing the bottom plate

1. The base plate (21/1) is plugged in the front with two fittings (21/3) at the cross strut of the metal bottom.
Lift the base plate (21/1) until the fittings (21/4) are free.
2. Pull the base plate (21/1) forwards to unplug the dump protection (21/5) in the back area.
3. Tilt the bottom plate (21/1) carefully outside the unit.

Removing the acrylic panel

1. Unlock the six lock bolts (21/7) with the Allen key (21/6).
2. Move the acrylic panel (21/10) a little to the left to allow the grooves (21/8) to slide out of the locking device at the handle.
3. Now you can remove the acrylic panel (21/10) to the front.

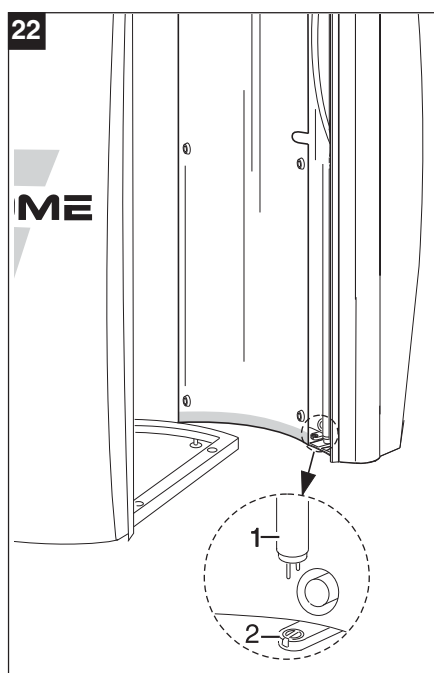

Exchanging the Sunlamp

1. Turn the sunlamp (22/1) in either direction until the contact pins can be seen in the groove of the lamp holder.
2. Remove the lamp.
3. Clean the reflector with a cloth soaked in alcohol.
4. Hold the new sunlamp horizontally so that the contact pins are vertically above one another.
5. Press the sunlamp into the lamp holder (22/2) in this position.
6. Turn the sunlamp 90 degrees so that the notch in the metal ring at the end of the lamp is at the top.

Fitting the Acrylic panel

1. Take the acrylic panel (21/10). The grooves (21/8) must point towards the handle (21/7).
2. Push the acrylic panel (21/10) with its grooves (21/8) to the right side in direction of the handle (21/7).
3. Turn the six bolts (21/9) of the acrylic panel (21/10) back with the Allen key (21/6) so that the acrylic panel is secured firmly in place.

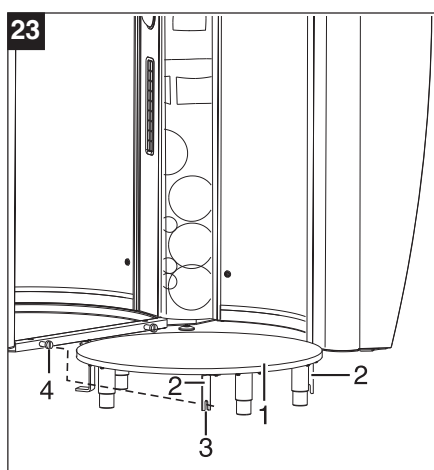

Installing the bottom plate

1. Take the base plate (23/1) tilty into the unit.
2. Lift up the bottom plate (23/1) in the front and plug in the two fittings (23/3) at the cross strut (23/4) of the metal bottom.
The bottom plate is fixed.

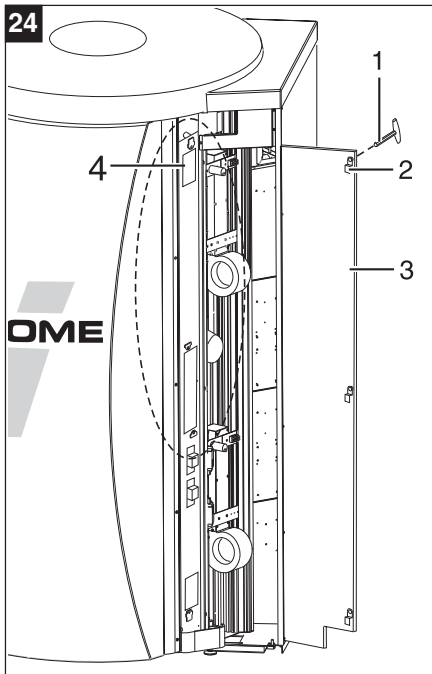

6.3.1 Replacing the lamps in the facial panel

1. Close the iDOME. Unlock the door of the service compartment (24/3) with the Allen key (24/1).
2. Open the door (24/3).
3. Reach in the bottom opening (24/4) of the lampholder carrier, rotate the bottom sunlamp (24/3) in either direction until the contact pins are visible in the socket groove.
4. Tilt the sunlamp to the unit center and push it a little to the top. With the other hand reach into the center opening (24/1) in the lampholder carrier, pull the sunlamp (24/3) out to the rear side.
5. Reach into the bottom opening (24/5) of the lampholder carrier, rotate the bottom sunlamp (24/2) in either direction until the contact pins are visible in the socket groove.
6. Tilt the sunlamp to the unit center and push it a little to the top. With the other hand reach into the center opening (24/1) in the lampholder carrier, pull the sunlamp (24/2) out to the rear side.

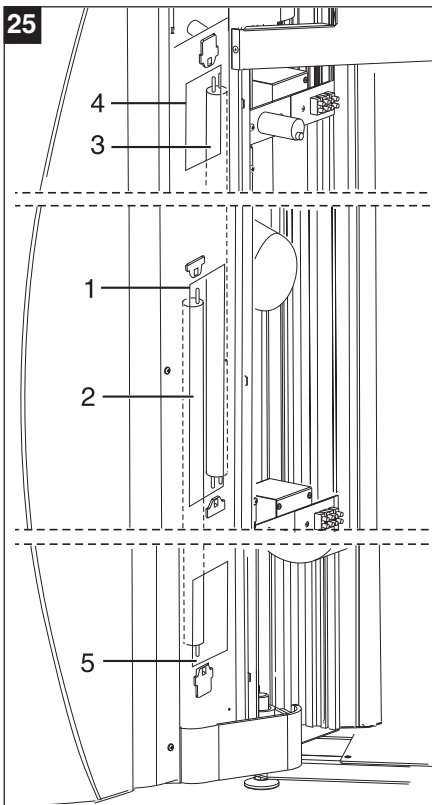

Mounting the sunlamps in the facial panel

1. Take the new sunlamp and push it through the center opening (25/1) in the lampholder carrier.
2. With the other hand reach into the bottom opening (25/5) in the lampholder carrier, hold the sunlamp vertically so that the contact pins of the lamp are one above the other.
3. In this position press the lamp into the socket. Rotate the lamp through 90 degrees until it engages.
4. Take the new lamp and push it through the center opening (25/1) in the lampholder carrier.
5. With the other hand reach into the upper opening (25/4) in the lampholder, hold the lamp vertically so that the contact pins of the lamp are vertically one above the other.
6. In this position press the lamp into the socket. Rotate the lamp through 90 degrees until it clicks into position.
7. Close the door of the service compartment.
8. Lock the door with the Allen key (24/1).

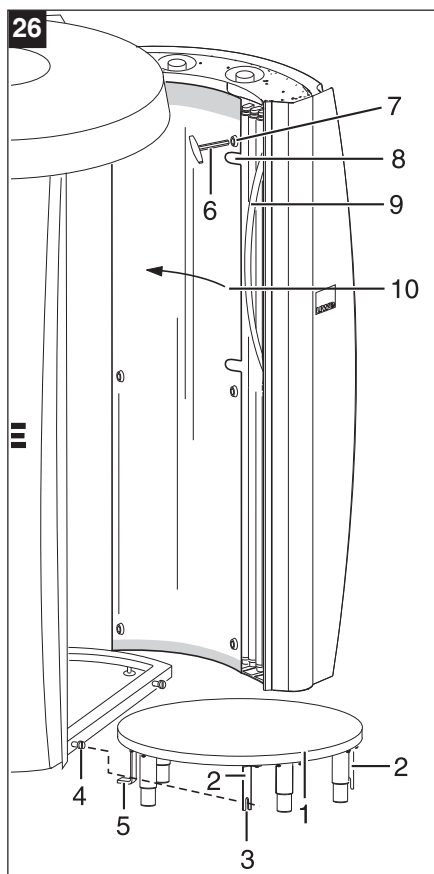

6.3.2 Replacing the LED handle illumination

Removing the bottom plate

1. The base plate (26/1) is plugged in the front with two fittings (26/3) at the cross strut of the metal bottom.
Lift the base plate (26/1) until the fittings (26/4) are free.
2. Pull the base plate (26/1) forwards to unplug the dump protection (26/5) in the back area.
3. Tilt the bottom plate (26/1) carefully outside the unit.

Removing the acrylic sheet panel

1. Unlock the six lock bolts (26/7) with the Allen key (26/6).
2. Move the acrylic panel (26/10) a little to the left to allow the grooves (26/8) to slide out of the locking device at the handle.
3. Now you can remove the acrylic panel (26/10) to the front.

Replacing the LED handle illumination

1. Unscrew the two pan head screws (27/5) 4,8 x 13 on the back of Panel 2 and the door panel with a cranked screwdriver.
2. Remove the plastic cover (27/4).
3. Disconnect the plug connector (27/6) XS 13 Panel 1 / XS 33 Panel door to the LED terminal (27/1).
4. Remove the two outside sunlamps (27/8) as described in the following.
5. Rotate the lamp (27/8) in either direction until the contact pins are visible in the socket groove (27/10).
6. Pull out the lamps.
7. Unscrew the 5 slotted pan head screws (27/9) 4,2 x 9,5 at the interior side of the lampholder carrier.
8. Remove the handle unit and place it on a worktop.
9. Unscrew the five slotted pan head screws (27/7) 4,2 x 13 with the washers A4.2, remove the acrylic handle (27/2) and put it aside.
10. Remove the defect LED light rail (27/3) and eventual glue residues.
11. Insert the new LED light rail after having re-moved the protective foil for the glue surface.
12. Mount the handle unit and the lamps in the reverse sequence.

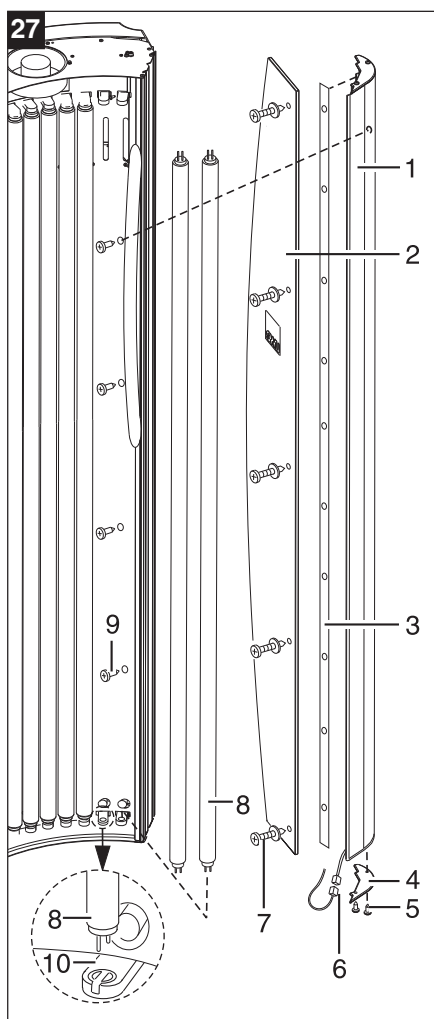

Fitting the acrylic panel

1. Take the acrylic panel (26/10). The grooves (26/8) must point towards the handle.
2. Push the acrylic panel (26/10) with its grooves (26/8) to the right in direction of the handle.
3. Turn the six bolts (26/7) of the acrylic panel (26/10) back with the Allen key (26/6) so that the acrylic panel is secured firmly in place.

Installing the bottom plate

1. Take the base plate (26/1) tilty into the unit.
2. Lift up the bottom plate (26/1) in the front and plug in the two fittings (26/3) at the cross strut (26/4) of the metal bottom.
The bottom plate is fixed.

6.4 Changing filter mats

The air used to cool the unit passes over micro filter mats as it enters the unit inlet.

These mats filter out fluff, hair, dust particles,

etc. to minimize the need for cleaning internal parts such as lamps.

These filtered particles block the filter after longterm use and reduce the cooling effect of the unit.

You should therefore change the filter mats from time to time to prevent the unit from overheating.

How often you replace the filter mats depends on the operating time and the amount of dirt in the air.



Only purchase original filter mats from your authorized dealer or equipment manufacturer.

Function

Check the filters after every 200 operating hours.

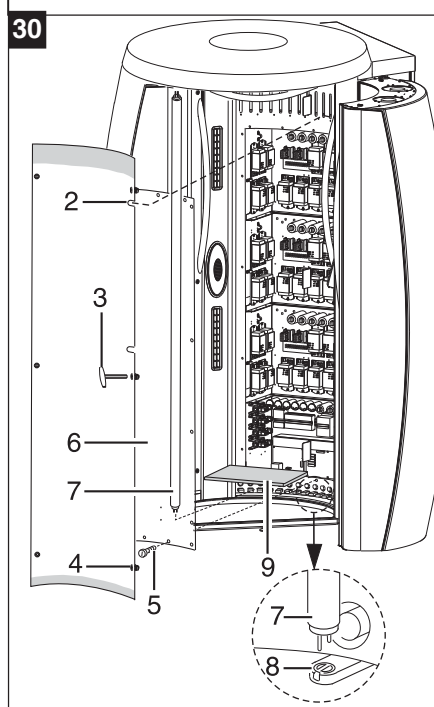
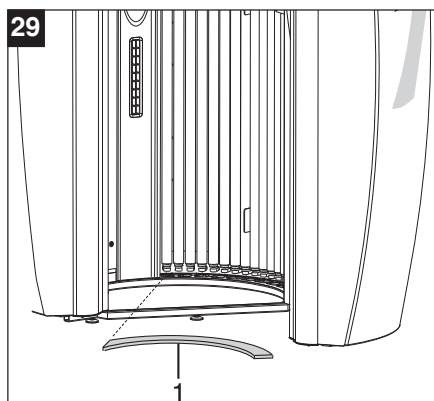
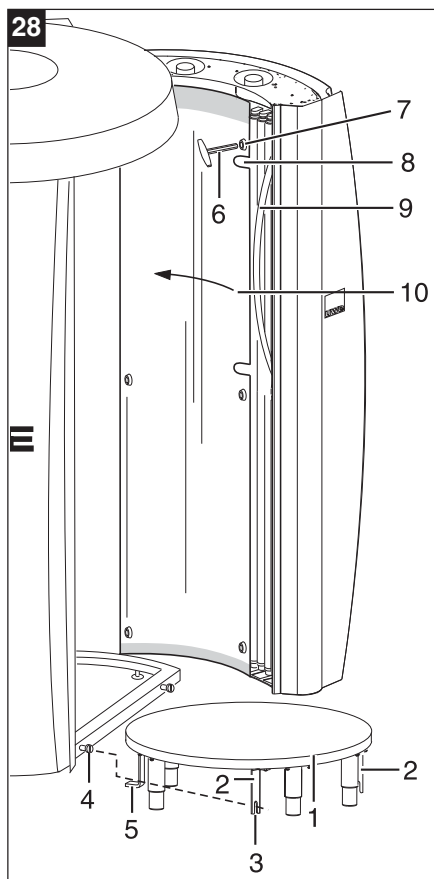

6.4.1 Filter mats in the base housing

Removing the bottom plate

1. The base plate (28/1) is plugged in the front with two fittings (28/3) at the cross strut of the metal bottom.
Lift the base plate (28/1) until the fittings (28/4) are free.
2. Pull the base plate (28/1) forwards to unplug the dump protection (28/5) in the back area.
3. Tilt the bottom plate (28/1) carefully outside the unit.

Removing the acrylic sheet panel

1. Unlock the six lock bolts (28/7) with the Allen key (28/6).
2. Move the acrylic panel (28/10) a little to the left to allow the grooves (28/8) to slide out of the locking device at the handle.
3. Now you can remove the acrylic panel (28/10) to the front.

Changing filter mats panels

1. Remove the old filter mats (29/1) on the panel bottom and replace them by new filter mats.

Fitting the acrylic panel

1. Take the acrylic panel (28/10). The grooves (28/8) must point towards the handle.
2. Push the acrylic panel (28/9) with its grooves (28/8) to the right in direction of the handle.
3. Turn the six bolts (28/7) of the acrylic panel (28/10) back with the Allen key (28/6) so that the acrylic panel is secured firmly in place.

Installing the bottom plate

1. Take the base plate (28/1) tilty into the unit.
2. Lift up the bottom plate (28/1) in the front and plug in the two fittings (28/3) at the cross strut (28/4) of the metal bottom.
The bottom plate is fixed.

6.4.2 Changing filter mats boards

Removing the bottom plate

1. The base plate (28/1) is plugged in the front with two fittings (28/3) at the cross strut of the metal bottom.
Lift the base plate (28/1) until the fittings (28/4) are free.
2. Pull the base plate (28/1) forwards to unplug the dump protection (28/5) in the back area.
3. Tilt the bottom plate (28/1) carefully outside the unit.

Removing the Acrylic sheet panel

1. Unlock the six lock bolts (30/4) with the Allen key (30/3).
2. Move the acrylic panel a little to the left to allow the grooves (30/2) to slide out of the locking device at the handle.
3. Now you can remove the acrylic panel to the front.

Changing the sunlamp

1. Turn the sunlamp (30/7) in either direction until the contact pins can be seen in the groove of the lamp holder (30/8).
2. Remove the lamp (30/7).
3. Remove all sunlamps to be able to remove the cover (30/6) of the mounting boards.

• Reflector

Wipe off the reflector with a cloth moistened with alcohol when replacing the reflectors.

Changing filter mats mounting boards

1. Remove the screws (30/5) of the mounting board covers
3. Remove the old filter mat at the bottom of the lowest mounting board module, put the new filter mat (30/9) at the same location.

Further procedure

Mounting the mounting board cover

1. Take the cover (30/6) for the mounting boards.
2. Fix the cover with the screws (30/5) onto the reflector.

Mounting the sunlamp

1. Hold the sunlamp (30/7) in vertically so that the contact pins are vertically above each other.
2. Press the sunlamp into the lamp holder (30/8) in this position.
3. Turn the sunlamp through 90 degrees so that the notch in the metal ring at the end of the lamp is at the top. Install all the sunlamps.

Fitting the acrylic panel

1. Take the acrylic panel. The grooves (30/2) must point towards the handle.
2. Push the acrylic panel with its grooves (30/2) to the right in direction of the handle.
3. Turn the six bolts (30/4) of the acrylic panel back with the Allen key (30/3) so that the acrylic panel is secured firmly in place.

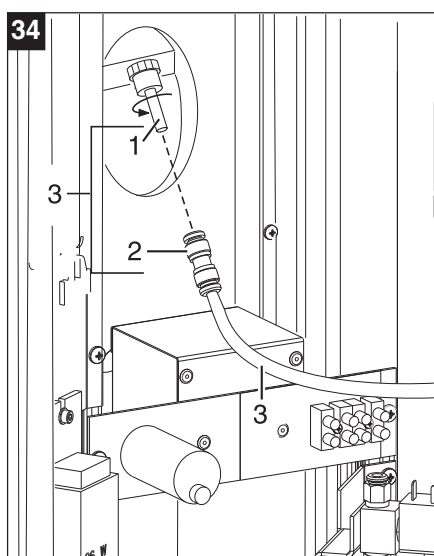
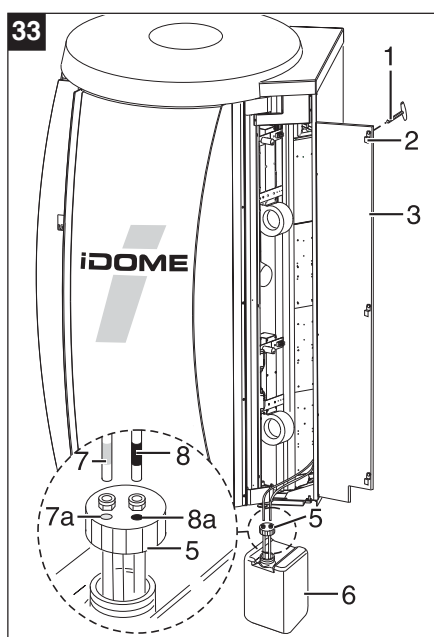
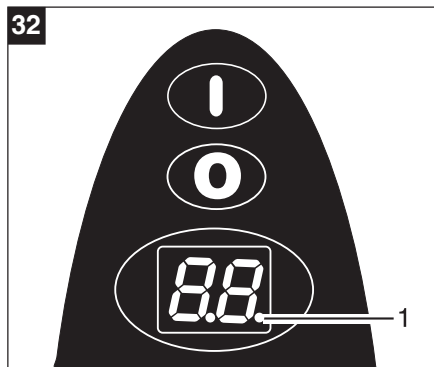
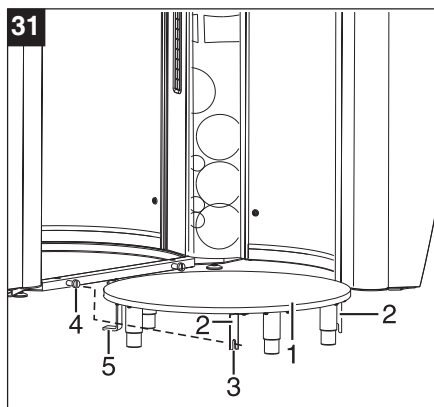

Installing the bottom plate

1. Take the base plate (31/1) tilty into the unit.
2. Lift up the bottom plate (31/1) in the front and plug in the two fittings (31/3) at the cross strut (31/4) of the metal bottom. The bottom plate is fixed.

6.5 Servicing the BREEZE system

The BREEZE lines must be bled during the initial commissioning, following service work on the BREEZE system and after changing the tank.

6.5.1 Bleeding the BREEZE lines

Follow the instructions as described in Chapter 5.1.3 under program PrP5.

6.5.2 BREEZE system faults

• Fault indicators

When the preset service interval of the BREEZE system is reached, the right decimal point illuminates (32/1).

BREEZE has the following special feature:

If the preset service interval is exceeded by a relatively long period of time, the continuously illuminated right decimal point begins to flash and the BREEZE function is deactivated.

Further information on the service intervals can be found in Chapter 5.2, Preset **service intervals**.

6.6 Replacing the BREEZE tank



The unit must absolutely be disconnected from the power supply before changing the tank! The tank capacity is 5 liters.

Warning

For health reasons, neither normal tap water nor distilled water may be used. Use only the water available from uwe in the original tanks which is triple distilled and sterile.

Open service compartment 2

1. Close the iDOME.
2. Unlock the three lock bolts (33/2) with the Allen key (33/1).
3. Open the door (33/3).

Replacing the BREEZE tank

1. Remove the empty BREEZE tank.
2. Unscrew the lid (33/5) of the empty BREEZE tank. Pull the tubes out of the instant plug-in clutches.
3. Screw the cover (33/5) with the line connections onto the full tank (33/6).
4. Insert the tube (33/7) from the pump into the green (33/7a) marked instant plug-in clutch.
5. Insert the tube (33/8) from the solenoid valve into the red (33/8a) marked instant plug-in clutch.
6. Place the full BREEZE tank (33/6) into the service compartment.
7. Close the door (33/3) of the service compartment. Lock the door (33/3) with the Allen key (33/1).

6.6.1 Replacing BREEZE nozzle

The BREEZE unit (34/3) is also located in service compartment 2

1. Pull the line (34/3) at the instant plug-in clutch (34/2) from the BREEZE nozzle.
2. Turn out the BREEZE nozzle anticlockwise at the knurl.
3. Replace the defect BREEZE nozzle (34/1) by a new one.
4. Push the quick-fit connector (34/2) over the BREEZE nozzle (34/1).
5. Close service compartment 2, turn the three bolts (33/2) with the Allen key (33/1) in position.

6.6.2 Important information to BREEZE

The BREEZE lines must be deventilated during the initial commissioning, following service work on the BREEZE system, after changing the tank and the BREEZE nozzles.



Important!

After changing the BREEZE tank, the number of spray cycles must be set to zero in program menu PrP4.

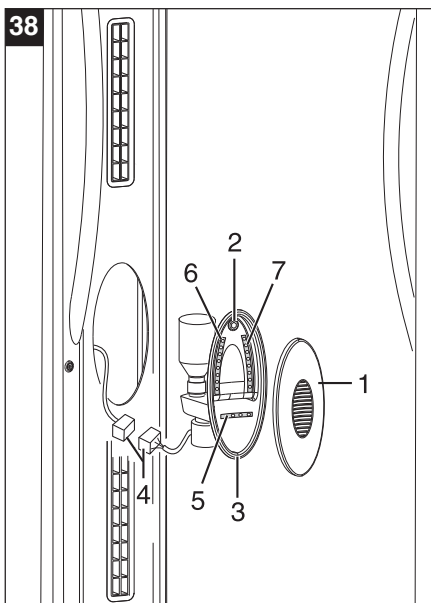
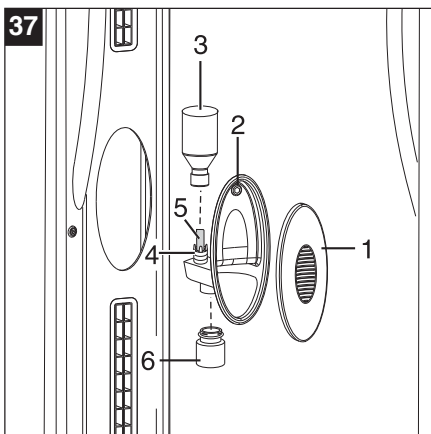
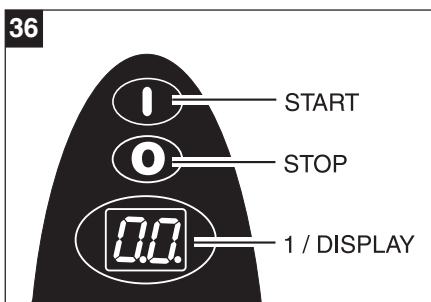
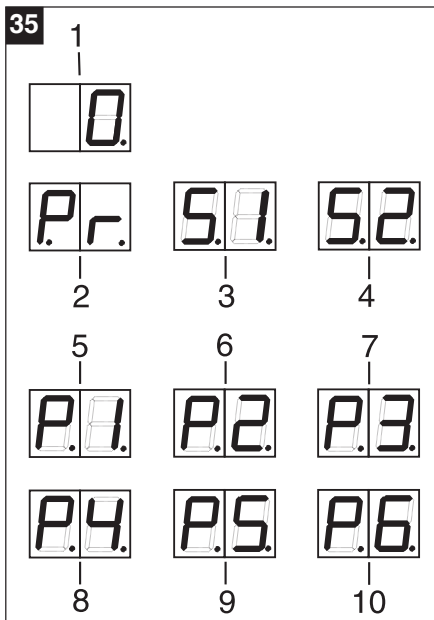

6.6.3 Set the BREEZE spray cycles to zero, bleed BREEZE

Setting BREEZE spray cycles to zero

1. Actuate **[START]** and **[STOP]** picture 36 simultaneously for 4 seconds.
The program menu **Pr** (35/2) appears on the display.
2. Actuate **[STOP]** picture 36.
The program menu **P1** (35/5) appears.
3. Actuate **[START]** until program menu **P4** (35/8) BREEZE spray cycles appears.
4. Actuate **[STOP]** and then **[START]** and **[STOP]** simultaneously for 4 seconds.
The number of BREEZE spray cycles counted up to now is set to zero (36/1).

6.6.4 Bleeding the BREEZE system

1. Actuate **[START]** and the program menu **P5** (35/9). Bleed BREEZE appears.
2. In program menu **P5**, press **[STOP]** for up to 1 minute until the emission pattern of the nozzle jet is a finely atomized cone.
3. Disconnect the unit from the power supply within 5 minutes to save and activate the changed parameters.

Wait 1 minute before triggering another spray cycle.

6.7. Changing AROMA bottle



Warning

Disconnect the unit from the power supply before change the bottles.

The AROMA module is located in the column segment of the iDOME. Always wear gloves when working on the AROMA module. Each AROMA bottle contains 200 ml.

Replacing AROMA bottle and fleece

1. Remove the protective grid (37/1).
2. Rotate both bolts (37/2) with the Allen key through 90° to the left.
3. Remove the complete AROMA module from the plastic cover.
4. Screw the bottle (37/3) off in an anticlockwise direction. Also rotate the evaporation tank (37/6) on the bottom side in an anticlockwise direction. Remove the old evaporation fleece (37/5) from the level tube (37/4) and replace it by a new one provided in the package with the new AROMA fragrance bottle.
5. Insert the evaporation tank (37/6) with the sealing on the back of the AROMA module. There is a bajonet catch at the evaporation tank, turn the evaporation tank to the right side until it engages.
6. Put the new full bottle on the level tube (37/4).
7. Screw the bottle clockwise on the level tube. Make sure to tighten the bottle with a slight pressure.
8. Re-insert the AROMA module in the provided opening of the plastic cover.
9. Rotate the bolt (37/2) with the Allen key through 90° to the right.
10. Reinstall the protective grid (37/1).

6.7.1 Replacing the LED illumination AROMA

1. Remove the protective grid (38/1).
2. Rotate both bolts (38/2) with the Allen key through 90° to the left.
3. Remove the complete AROMA module from the plastic cover.
4. Disconnect the plug connector (38/4) X6a to the LED illumination.
5. Remove the defective LED stripe (38/5, 38/6, and 38/7).
6. Remove the old glue.
7. Place the new LED stripe at the same position
8. Connect the plug connector (38/4)
9. Re-insert the AROMA module in the provided opening of the plastic cover.
10. Rotate the bolt (38/2) with the Allen key through 90° to the right.
11. Reinstall the protective grid (38/1).

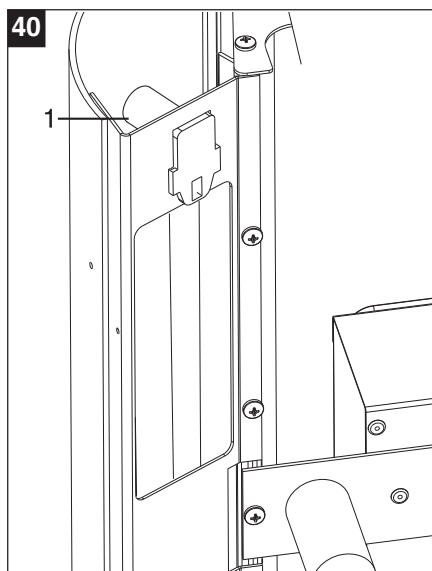
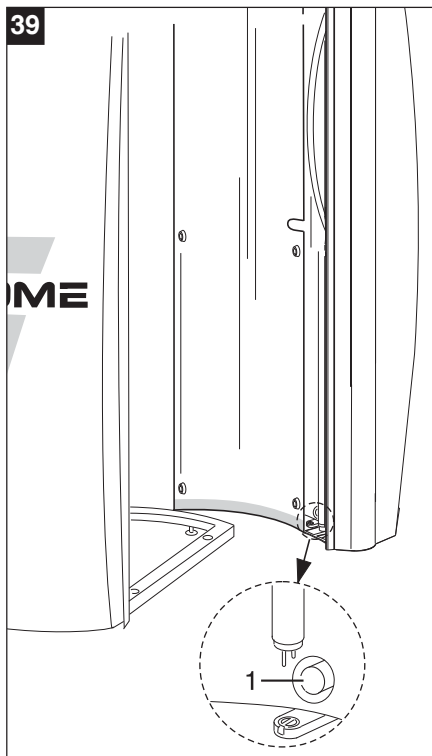

7 TIPS FOR CORRECTING MINOR FAULTS



Warning

Disconnect the unit from the power supply before starting any servicing or repair work.

Repair work should only be carried out by uwe Customer Service or other authorized persons.

No safety devices may be removed or put out of action.

After each repair, the unit must be tested to DIN VDE 0701 or the corresponding national standard and the results recorded.

• Dark spots at the lamp ends

Dark areas near the ends of the lamp when switched off have no detrimental effect on the performance of the unit.

Replace the starter to be on the safe side.

• One or more lamps not illuminate (replace starter)

In the unit, there are LP lamps below the acrylic sheet panel with starters Fig.39.

What to do when a lamp does not illuminate?

1. Gain access to the lamp which does not function.
See Chapter 6 Servicing and Maintenance, sections 6.3 and 6.5.3
2. Check whether the lamp is correctly mounted.
3. Then check the starter for proper seating.
4. Remove the starter from the lamp which does not illuminate and remount by turning to the right.
5. If the lamp still does not illuminate, mount the starter from a functioning lamp.
If this does not work, you must inspect the lamp.
6. Install the lamp in a base in which a lamp illuminates.
If the lamp does not illuminate, it is defective and must be replaced.
If it does illuminate, however, there is an electrical defect in the unit.



Function

Inspection by uwe Customer Service or a authorized company.

Where are the starters?

• Panels (39/1)

Exchanging the Sunlamp see Chapter 6.3

• Sunlamps in the facia panel Figure 40 (40/1), Sec. 5.3.1

The panels becomes to warm

1. Check whether the air intake filters (filtermats) are clogged.
2. Ensure that the exhaust air can be discharged unobstructed. Airflow must not be obstructed at either the exhaust hose or in the ventilation duct, as this will lead to overheating of the unit.
For information on effective ventilation, refer to the „Climatization tips“ brochure available from your dealer or from uwe.



Function

Arrange for an inspection by PC Marketing or a service provider named by PC Marketing.

8 WASTE DISPOSAL

Lamps

Fluorescent lamps, high-pressure lamps and illumination lamps are special waste. Do not dispose of in the household garbage. The local authorities provide information about where the lamps can be disposed of.

Unit

Dispose of defective units in accordance with the national regulations.

INFORMATION FOR THE ENGINEER AND DEALER SPECIALIST

9 INSTALLATION OF THE PROFI UNIT

The unit may only be set up by uwe personnel or authorized persons. At least two people are required to set up the unit. The rooms for setting up and operating the unit must be well ventilated or there is a danger of the unit overheating.

9.1 Place of Installation and State on Delivery

To ensure safe transport, the unit is delivered in individual pre-assembled packages on pallets.

Package 1, bottom & top	Art. No	272 659
Package 2, bottom & top	Art. No	272 659
Package Panel 1	Art. No	272 667
Package Panel 2	Art. No	272 662
Package Panel door	Art. No	272 666
Package column	Art. No	272 988
Column element body cooling		
Package control system board	Art. No	272 907
Package mounting board 2	Art. No	273 029
Package mounting board 3	Art. No	272 908
Package mounting board 4	Art. No	273 025
Package		
Fan for preswitch devices	Art. No	273 028
Package mounting board 5	Art. No	273 026
Package mounting board 6	Art. No	272 668
Package mounting board 7	Art. No	273 027

The packages are fastened securely to the pallet by straps and covered with a film wrap. The pallet with the packages is unloaded on site by platform lift or fork lift.

Please check the delivery for completeness.

For installation at the required installation site, the individual packages must be removed from the pallet and transported to the desired installation site and assembled there.

All units are solely intended for tanning indoors. The unit must only be operated in areas where there is no risk of explosion and in dry surroundings.
The surroundings must be well ventilated.

9.2 Assembly and Installation

Remove the straps and packaging wrap.

Transport the individual packages to the installation site.

9.2.1 Assembling the bottom

1. Take the bottom element (41/1) out of the bottom & top package Art. no. 272 659.
2. Place the bottom element (41/1) in the required position.
3. The bottom is provided with 6 adjustable feet (41/2) to level out any unevenness of the floor.
4. Check with a spirit level that the bottom is level. The adjustable feet (41/2) can be adjusted using a SW 17 wrench.

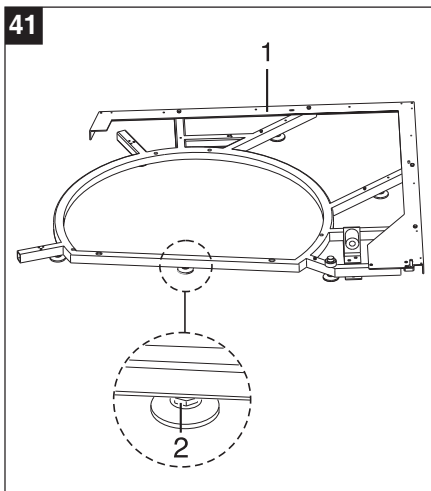

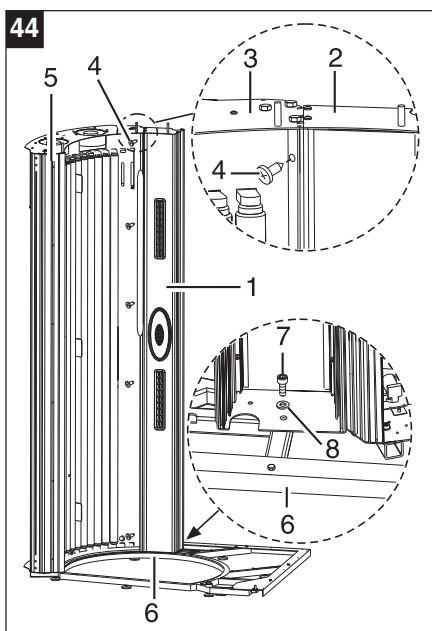
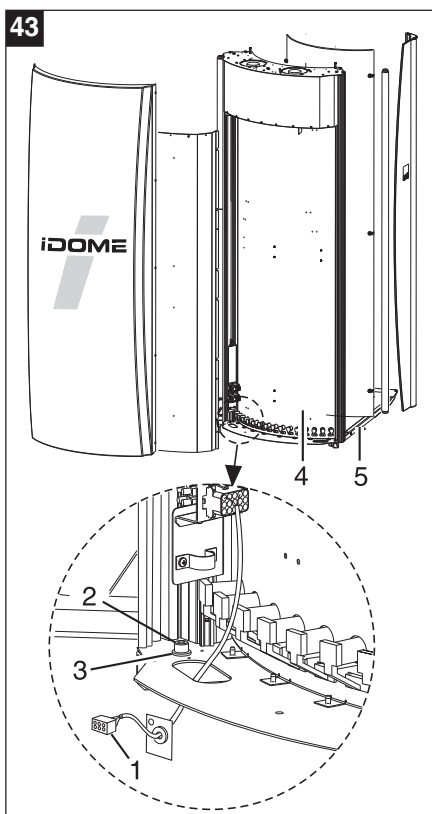
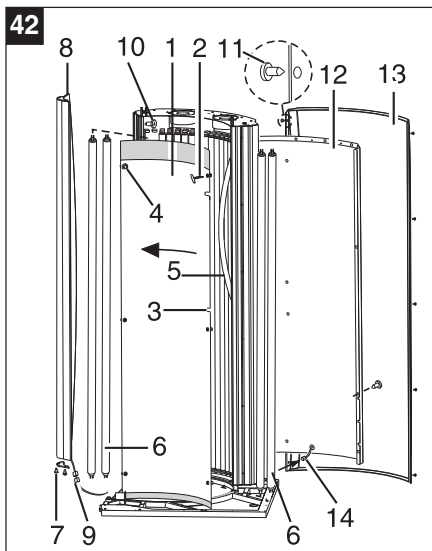

9.2.2 Assembly Panel 1

1. Remove the acrylic panel (42/1).
2. Unlock the six lock bolts (42/4) with the Allen key (42/2).
3. Now you can remove the acrylic panel (42/1) towards the front. Put the acrylic panel aside until final assembly.
4. Rotate the two outside sunlamps (42/6) on the left and right sides of the panel in either direction until the contact pins show in the socket groove. Pull the lamp out. Put the lamps aside until final assembly.
5. Unscrew the two 4.2 x 9.5 pan head screws (42/7) on the rear side of the handle (42/8) with a cranked screwdriver. Disconnect the plug connector X (42/9) at the rear side.
6. Turn the six pan head screws 5,5 x 13 (42/10) at the left side of the handle out and put them aside until the final assembly.
7. Unscrew the ten fastening screws 4.8 x 13 (42/11) at the panel cover hood and put them aside.
8. Unscrew the fifteen 4,2 x 9,5 pan head screws of the lower metal cover (42/12) and put it aside until the final assembly. Make sure that the plug connector (42/14) of the LED Lights inside the cover is disconnected.
9. Now put Panel 1 (43/4) onto the bottom module (43/5).
10. On the back of the panel there is on the left and the right sides each with a M 6 x 16 hexagon socket screw (43/2) and an washer A 6.4 (43/3). Screw them into the bottom module (43/5) using an Allen key.



Function

Make sure that the fastening screws of the panel are positioned in the holes provided. The panel must stand upright on the bottom module. Please check with a spirit level.

9.2.3 Assembly body cooling column

1. Place the body cooling column (44/1) vertically on the bottom module (44/6).
2. Push the body cooling column in direction of Panel 1 (44/5) so that the two gear profiles (44/3) and (44/2) engage.



Important!

Important! Align the function column using a spirit level.

3. Screw the body cooling column (44/1) with the bottom module (44/6) with the hexagon socket screw M 6 x 16 (44/7) and an washer A 6.4 (44/8) on the back of the body cooling function module.
4. Screw the body cooling function column (44/1) with six 5.5 x 13 pan head screws (44/4) with Panel 1 (44/5) from the front right internal side of Panel 1 (44/5).

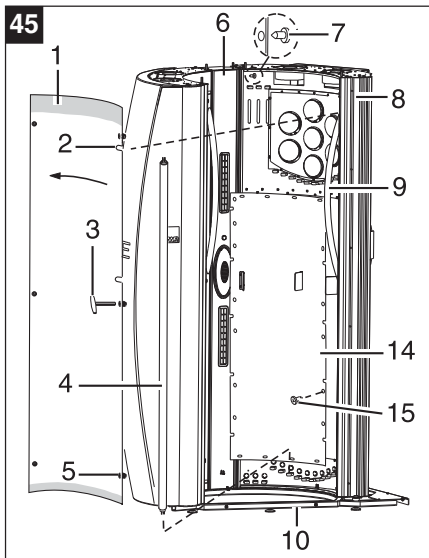

9.2.4 Assembly Panel 2

1. Remove the acrylic panel.
2. Unlock the six lock bolts (45/5) with the Allen key (45/3).
3. Now you can remove the acrylic panel (45/1) to the front. Put the acrylic panel aside until the final assembly.
4. Rotate the sunlamp (45/4) in either direction until the contact pins are visible in the socket groove.
5. Pull the lamp (45/4) out. Remove the remaining sunlamps as described above. Put the sunlamps aside until the final assembly.
6. Put Panel 2 (45/8) onto the bottom module (45/10).
7. On the back of the panel (46/6) there is on the left and the right side each with a hexagon socket screw (46/7) M 6 x 16 and a washer (46/8) A 6.4. Screw them into the bottom module (46/1) with an Allen key.
8. **Make sure that the fastening screws of the panel are positioned in the holes provided. The panel must stand upright on the bottom module. Please check with a spirit level.**
9. Screw the Panel 2 (45/8) with the body cooling function column (45/6) with six 5.5 x 13 pan head screws (45/7) from the front left internal side of Panel 2.

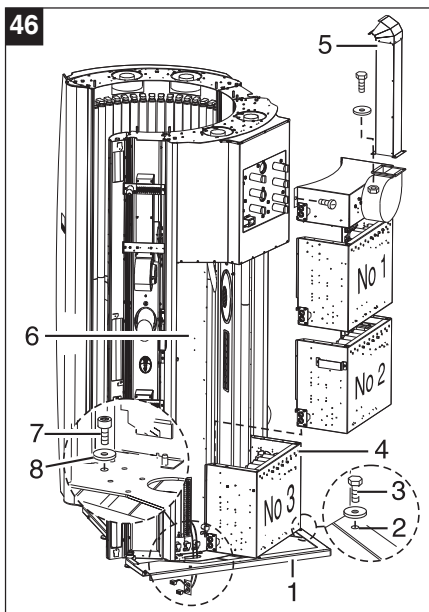

9.2.5 Assembly of housings for series devices

1. Remove the eighteen pan head screws (45/15) 4.2 x 9.5 of the cover (45/14) towards the service chamber from the front side on panel 2 (45/8). Remove the cover (45/14).
2. Put the mounting board 3 (46/4) down on the bottom module (46/1).
3. Align mounting board 3 so that the holes (47/2) on the front lower side of the mounting board are aligned with the holes of the bottom module (47/1).
4. Screw two hexagonal screws M 4 x 10 (47/3) and a washer A 4.3 into the holes (47/2).
5. Screw the mounting board 3 (47/4) to the reflector plate on the front side of Panel 2, using four 4.2 x 9.5 pan head screws.
6. Place the mounting board 2 (47/5) on top of mounting board 3 (47/4).

Align the holes on the back of mounting board 2 with the holes on the top side of mounting board 3 (47/4).
7. Insert four hexagonal bolts M 4 x 10 and a washer A 4.3 before screwing on the hexagonal nut M 4.
8. Screw mounting board 2 to the reflector plate from the front side of Panel 2, using four 4.2 x 9.5 pan head screws.
9. Repeat for mounting board 1 and the fan for preswitch devices (47/5) for the series devices as described above.
10. Place the chimney (46/5) on the fan exit and fasten it with four hexagonal bolts M 6 x 16 and a washers A 6.4 before screwing on the hexagonal nut M 6.
The upper side of the chimney screw with 2 pan head screws to the top of panel 2.

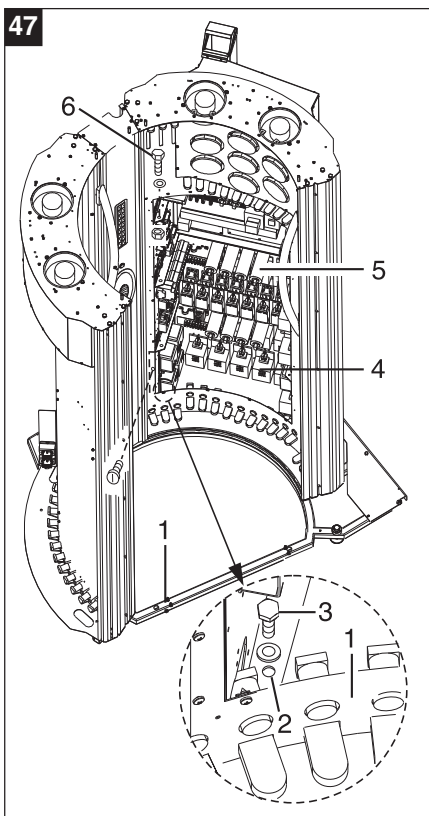

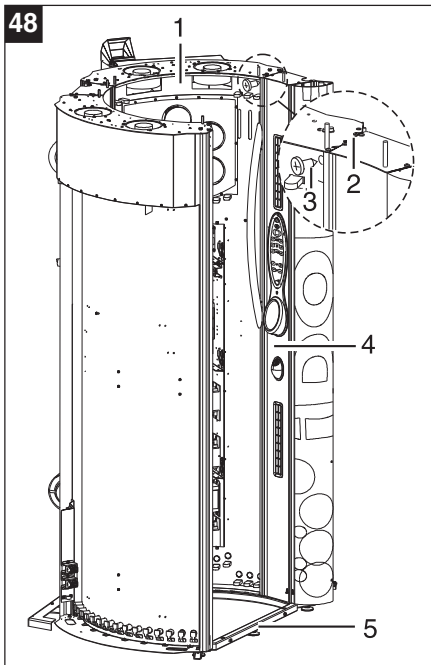

9.2.6 Assembly function column and facial panel

1. Place the function column (48/4) vertically on the bottom module (48/5).
2. Push the function column (48/4) in direction of Panel 2 (48/1) so that the two gear profiles (48/2) engage.
3. Important: Align the function column with a spirit level use.
4. Screw the function column (49/1) with the bottom module with the hexagonal socket screw (49/2) M 6 x 16 and a washer (49/3) A 6.4, on the back of the column (49/1).
5. Screw the function column (48/4) with Panel 2 (48/1) with six pan head screws (48/3) 5.5 x 13 from the front right side of Panel 2 (48/1).

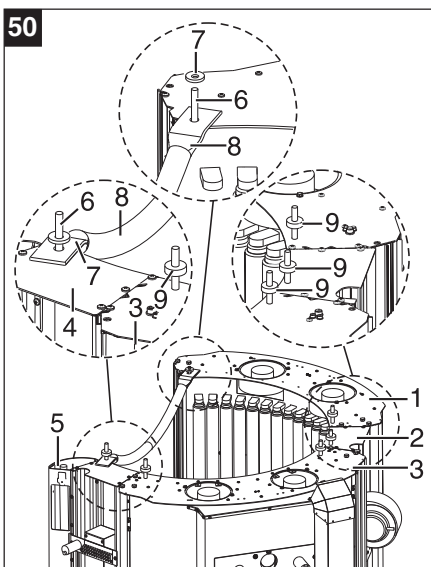
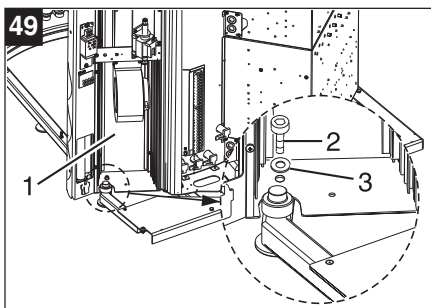

9.2.7 Assembly of top module

1. Take the handle out of the packing bottom & top Art. no. 272 659.
2. Take the handle (50/8) and insert it with the holes in the appropriate bolts (50/6), at Panel 1 (50/1) and at the function column (50/4).
3. Take the two 5 mm high spacers (50/7) provided and put them on the bolts (50/6).
4. Take the four 8 mm high spacers (50/9) provided and put them on the two bolts of Panel 2 (50/3) as well as on the bolt of the body cooling column (50/2) and on the bolt of Panel 1 (50/1) near the body cooling column connection (50/2).
5. Take the bottom plastic cover (51/1) of the top module and position the cover in a way that the three studs (51/8) at the unit rear side fit into the holes of the cover so that the cover bears on the spacers mounted before.
6. Now place the main ventilation module (51/2) on the plastic cover (51/1). The position is defined by the three bolts (51/3) on the back of the unit and the big hole by side for the top door hinge.
7. Screw the main ventilation module (51/2) onto the bolts with the six washers (51/6a) A 8.4 and the six hex. nuts (51/6) M 8. Do not tighten too much as otherwise the panel frame ribs could be distorted.
8. Screw the plastic cover in the area of the door with the supporting straps (51/5) with three pan head screws (51/4) 4.2 x13 with the three contemplated plastic drums (51/4a).
9. The slotted hole of the supporting strap (51/5) screw with three washers A 6.4 (51/10a) and three hexagonal socket screws M 6 x 16 (51/10) with the contemplated bolts (51/10b) at the main ventilation module. Pull the supporting straps with the slots to back up, so the plastic cover is adjust upwards and couldn't be damaged with the door assembly.
10. Lay the connection cable XS 4 (51/7) to the back of the unit, on the right side below the mounting board.

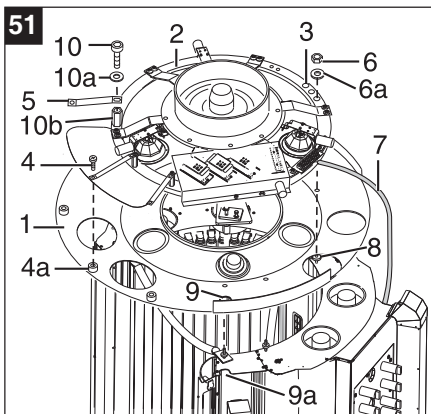

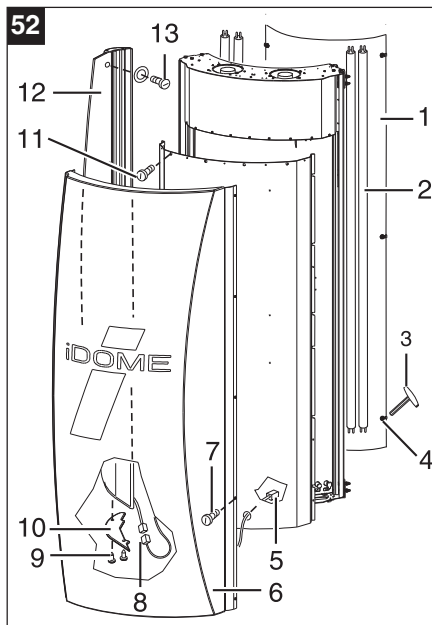

9.2.8 Assembly of panel door

1. Remove the acrylic panel (52/1).
2. Unlock the six lock bolts (52/4) with the Allen key (52/3).
3. Now you can remove the acrylic panel (52/1) towards the front. Put the acrylic panel aside until final assembly.
4. Rotate the two outside sunlamps (52/2) on the left and right sides of the panel in either direction until the contact pins show in the socket groove. Pull the lamp out. Put the lamps aside until final assembly.
5. Unscrew the two 4.2 x 9.5 pan head screws (52/9) on the rear side of the handle (52/12) with a cranked screwdriver. Disconnect the plug connector X (52/8) at the rear side.
6. Turn the six pan head screws 5,5 x 13 (52/13) at the left side of the handle out and put them aside until the final assembly.
7. Unscrew the ten fastening screws 4.8 x 13 (52/6) at the panel cover hood and put them aside.
8. Unscrew the fifteen 4,2 x 9,5 pan head screws (52/11) of the lower metal cover and put it aside until the final assembly.
Make sure that the plug connector (52/5) of the LED Lights inside the cover is disconnected.

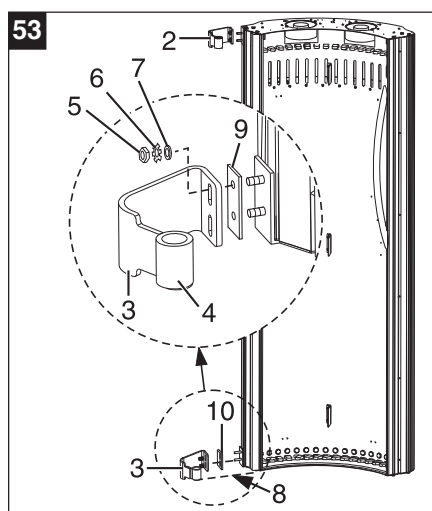

Further assembly

1. Fasten the provided door hinges as follows.
2. Top door hinge (53/2), top plastic bearing bush.
3. Insert the studs into the grooves of the top door hinge.
4. Align the hinge with the top edge of the door module.
5. Mount the washer (53/7) A 8.4 and the lock washer (53/6) A 8.4 on the bolt. Screw the hexagonal nut (51/5) M 8 to the bolt and tighten with a fork wrench.
6. Bottom door hinge (53/3), bottom plastic bearing bush (53/4).
7. For level out any unevenness of the floor add to the bottom door hinge a distance plate.
8. Insert the anchors to the drillings of the distance plate (53/9)
9. Insert the studs into the grooves of the bottom door hinge.
10. Align the hinge with the bottom edge of the function column.
11. Mount the washer A 8.4 and the lock washer A 8.4 on the bolt. Screw the hexagonal nut M 8 to the bolt and tighten with a wrench.
12. Lift the door module to be able to fit the bottom door hinge in the hinge bolt on the right side of the function column.
13. Tilt the door module in the direction of the unit center.
14. Insert the anchors (54/1) of the corrective plate (54/4) to the upper hinge.
15. Screw the corrective plates to the upper side of the function module. Use the two hexagon bolts (54/3) M 8x16 and the two washer A 8.4.
16. Align the door module.
17. There are two compensation plates on the top of the function column. Slightly unscrew the hexagonal bolts (54/3) M 8 x 16 to adjust the gap between the door module and Panel 1. After alignment retighten the hexagonal bolts (54/3).
18. To adjust the height between Panel 1 and door module slightly unscrew the hexagonal nuts (55/2) at the hinges (55/1). The door module can be moved in vertical direction. After alignment retighten the hexagonal nuts (55/2).
19. Lead the door module connection cable XS 3 (54/5) through the bottom unit. The bottom unit must be lifted slightly to fit through the bushing housing. Lead the door module connection cable to the mounting boards.

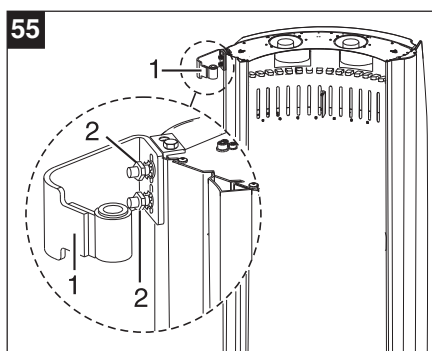
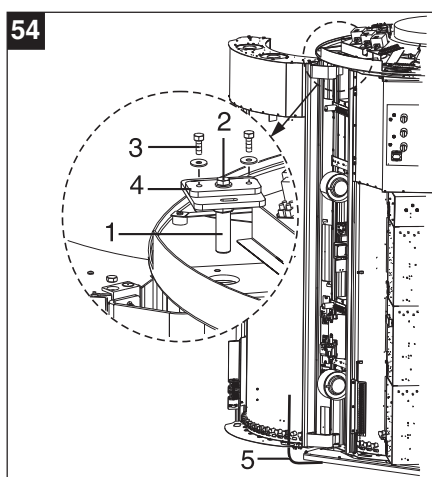

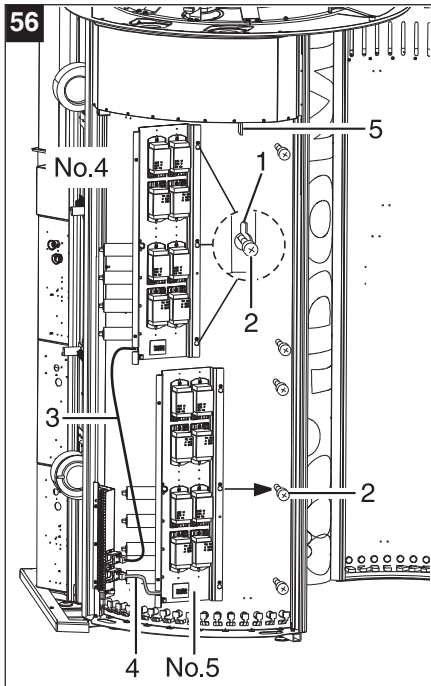

9.2.9 Fit the mounting boards into the panel 1 and panel door

1. Hang up the mounting board no. 4 for panel 1 over the three placed pan (56/1) head screws (56/2) on the right side of the back of the panel. Put the mounting board controlled with the three keyholes on the side over the pan head screws and hang it up by a downward movement. Make sure that the flange (56/5) above the mounting board stays in front of them. Tight the three screws (56/2) and connect the pin housing XS 11 (56/3) with the bushing housing XB 11 placed below on the left side.
2. Hang up the mounting board no. 5 for panel 1 over the three lower placed pan head screws on the right side of the back of the panel. Put the mounting board controlled with the three keyholes on the side over the pan head screws and hang it up by a downward movement. Tight the three screws and connect the pin housing XS 12 (56/4) with the bushing housing XB 12 placed below on the left side.

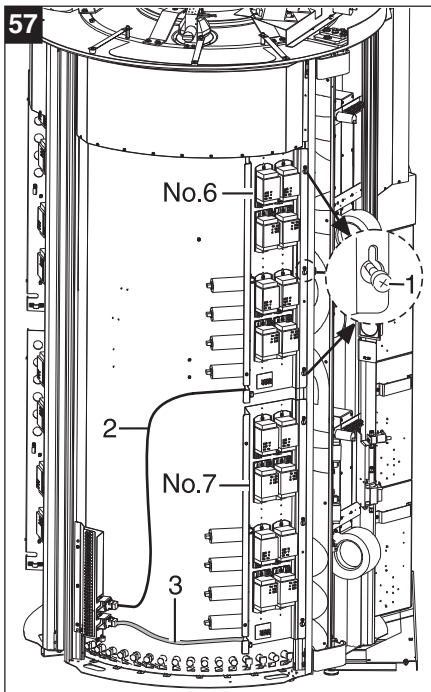

3. Repeat for mounting board 6 and 7 for panel door as described above. Tight the screws and connect respectively the pin housings XS 31 and XS 32 with the bushing housings XB 31 and XB 32.

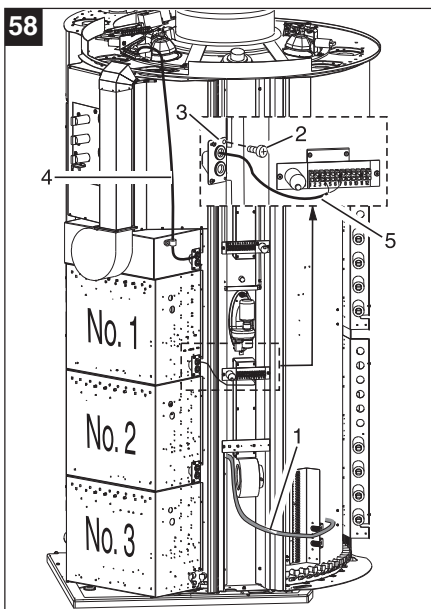

9.3 Connection of plug connections

1. The connection cables of the individual modules go to the rear area of the electrical unit.
2. Lead the **connection cable (58/1) of Panel 1** through the opening in the **mounting board no. 2**, as shown in Figure 58.
3. There is a cable bushing on the cable as well as a cover plate (58/3). Insert the cable bushing in the appropriate opening on mounting board 2. Fix the cover plate (58/3) with three 4.2 x 9.5 pan head screws (58/2) to mounting board no. 2.
4. Lead the **connection cable (58/5) from the body cooling function column** through the opening in the **mounting board no. 1**, as shown in Figure 58. There is a cable bushing on the cable which must be inserted in the appropriate opening in mounting board 1. Fix the cover plate using three 4.2 x 9.5 pan head screws onto the mounting board no. 1. Fix the cover plate (58/3) with three 4.2 x 9.5 pan head screws (58/2) to mounting board no. 1.
5. Lead the **connection cable (58/4) of the main fan in the top module** directly from the back to the opening on the fan for preswitch devices as shown in Figure 58. Fix the cover plate with three 4.2 x 9.5 pan head screws on the fan board.

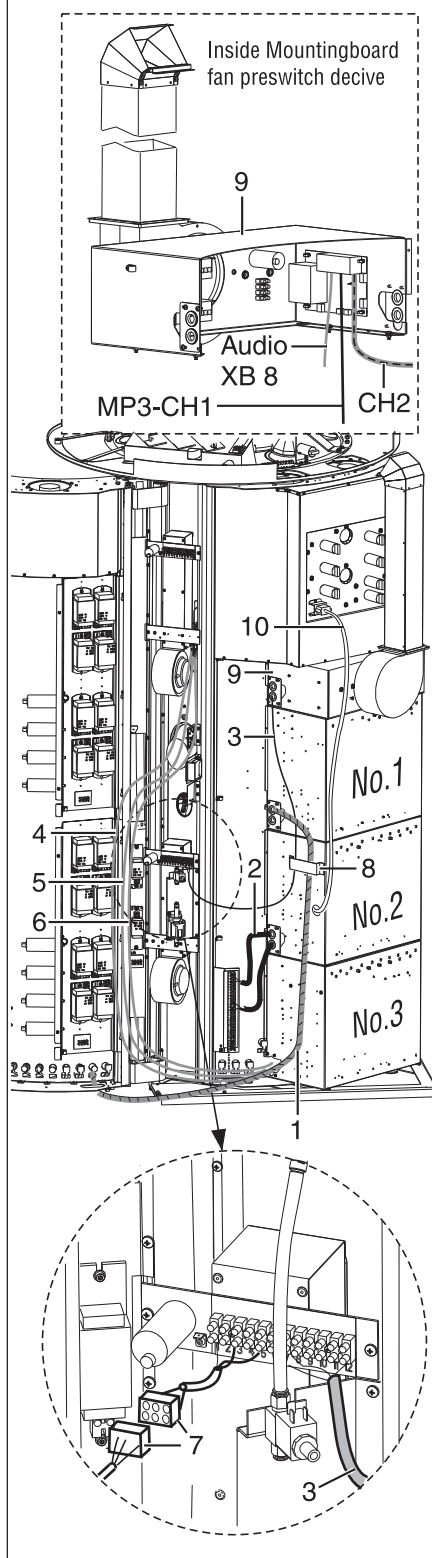

6. Lead the two **connecting cables (59/2)** from **Panel 2** as shown on Figure 55 through the opening in the **mounting board no. 2**.
There is a cable bushing on the cable as well as a cover plate. Insert the cable bushing in the appropriate opening on mounting board no. 2.
Fix the cover plate using three 4.2 x 9.5 pan head screws onto the mounting board no. 2.
7. Lead the **connecting cable (59/1)** from the **door panel** through the hinging bracket (59/8) for the cable and then through the opening on **mounting board no. 1**, as shown in Figure 59. There is a cable bushing on the cable and a cover plate.
Insert the cable bushing in the appropriate opening on mounting board no. 1. Screw the cover plate with three 4.2 x 9.5 pan head screws on mounting board no. 1.
8. Lead the **connection cable (59/3)** of the **function column** through the hinging bracket (59/8) for the cable and then through the opening on the **fan for preswitch devices (59/9)**, as shown in figure 59.
There is a cable bushing on the cable and a cover plate. Insert the cable bushing in the appropriate opening on the fan for preswitch devices.
Screw the cover plate with three 4.2 x 9.5 pan head screws on the fan for preswitch devices.
9. Lead the data cable (59/4), the MP 3 connection cable (59/5) and the audio connection cable (59/6) for the studio through the front opening of mounting board no. 3.
10. Connect the plug connector XS5D (59/7) of the function column for illumination of the facia panel, as shown in Figure 59.

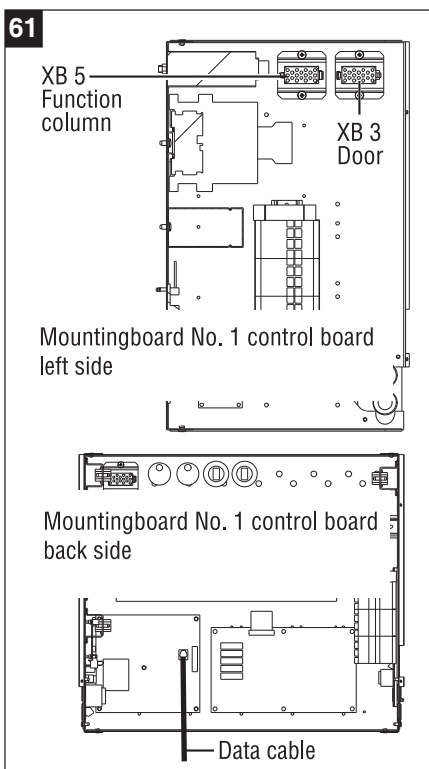
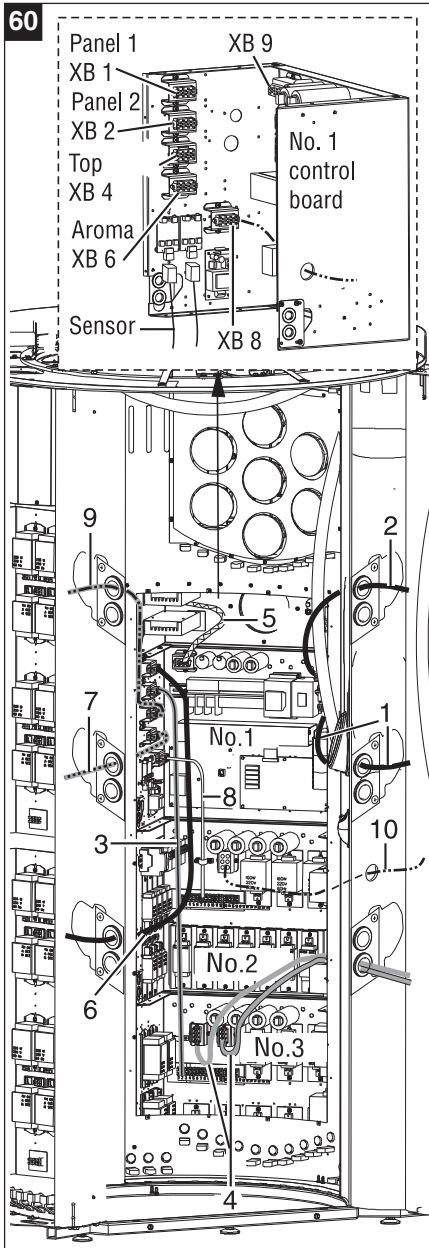

Other plug connections

11. Connect the **pin housing of the door module XS 3** with the **bushing housing (60/1) XB 3** on the right side of **mounting board no. 1**.
12. Connect the **pin housings (56/4) of panel 2 XS 21/22** with the **bushing housings XB 21/22** on **mounting board no. 3**.
Take the **connection cable (60/3) XS 2** which is screwed to the terminal and lead it on the left side into **mounting board no. 1**.
Connect the pin housing with the **bushing housing XB 2**.
13. Connect the **pin housing (60/6) of Panel 1 XS1** with the **bushing housing XB1** on the left side of **mounting board no. 1**.
14. Take the **pin housing (60/9) of the top module XS 4** and lead it lower into **mounting board no. 1**.
Connect the pin housing with the **bushing housing XB 4**.
15. Take the **pin housing (60/7) of the body cooling and AROMA function column XS6** and lead it to the left side of **mounting board no. 1**. Connect the pin housing with the **bushing housing XB 6**.
16. Take the **pin housing (60/2) of the function column XS 5** and lead it lower into **mounting board no. 1**.
Connect the pin housing with the **bushing housing XB 5**.
17. Take the **pin housing (60/5) of the fan for preswitch devices XS 9** and lead it lower into **mounting board no. 1**.
Connect the pin housing with the **bushing housing XB9**.
18. Take the **connection cable (60/8) XS 8** of the Swing module which is screwed to the terminal of mounting board no. 2 and lead it on the left side into mounting board no. 1.
Connect the pin housing with the **bushing housing XB 8**.
Take the **connection cable X 23/24** and connect the **pin housing XS 23** with the **bushing housing XB 23** on the mounting board no. 2.
Lead the other **pin housing XS 24 (60/10)** through the opening on the right side of mounting board no. 2 and lead it to the upper **bushing housing XB 24 (59/10)** on the backside of the Swing module as shown in Figure 59.
19. Take the **data cable (59/4)** and lead it up into **mounting board preswitch devices (59/9)**.
Connect it to the **bushing housing** on the mother board, as shown in Figure 61.
20. Take the **MP3 cable CH1 (59/5)** and lead it up into **mounting board preswitch devices (59/9)**.
Connect it with the **bushing housing XB 8** on the **audio board**, as shown in Figure 59.
21. Take the **audio cable for studio operation CH2 (59/6)** (see Fig 59) and lead it to the bottom into **mounting board preswitch devices (59/9)**.
Connect it with the **bushing housing XB 9** on the **audio board**, as shown in Figure 59.
22. Close the unit.

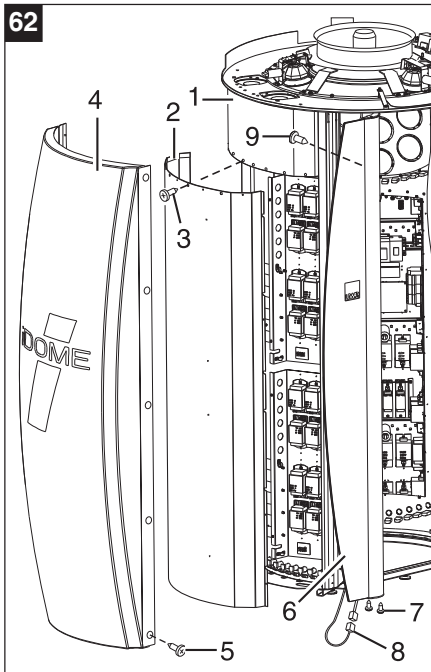

9.4 Assembling the housing parts

Before you fix the metal cover, connect the plug connector of the LED-Lights.

9.4.1 Assembling the panel housing parts

1. Take the metal cover (62/2) of Panel 1 (62/1) and screw the fifteen 4.2 x 9,5 pan head screws (62/3) in this way.
2. Screw 5 screws on the top of the cover into the free holes of the upper cover, then 3 screws on the left and 3 on the right side of the panel and 4 screws in the middle of the cover into the mounting board 4 and 5.
3. Take the cover (62/4) of Panel 1 and put it on the back side of Panel 1.
4. Screw the ten 4.8 x 13 pan head screws (62/5) in the appropriate fixing holes provided.
5. Attach the handle (62/6) completely to panel 1 (62/1).
6. Connect the plug connector X (62/8) to the under side of the handle of panel 1.
7. Screw in the two 4.2 x 9.5 countersunk screws (62/7) on the lower side using a cranked screwdriver.
8. Screw in the six 5.5 x 13 pan head screws (62/9) on the left inner side of Panel 1, handle (62/6) is connected to Panel 1.
9. Close the panel door (63/1) in the same way as described above.

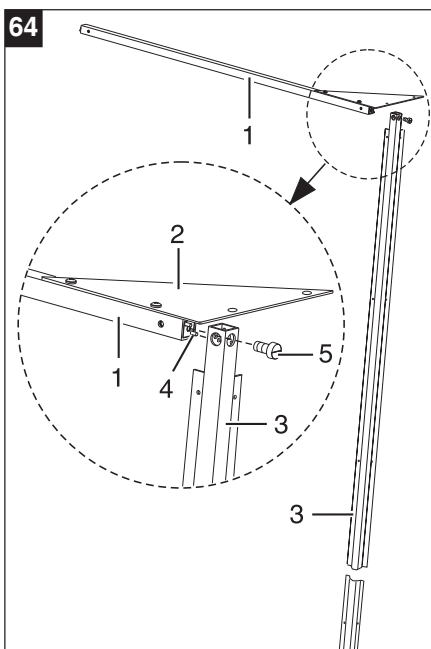
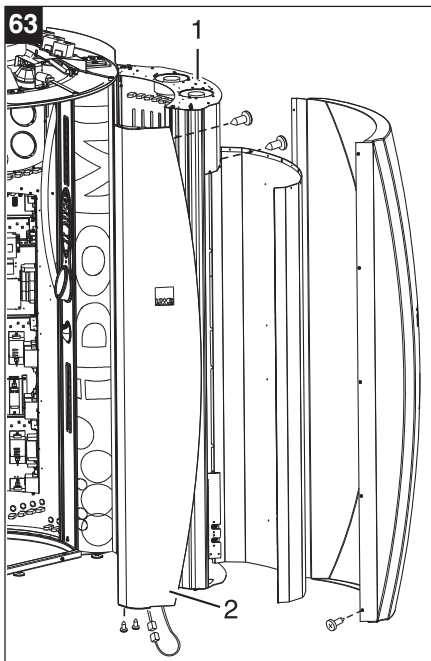

9.4.2 Assembly of unit housing

The frame for the housing parts is delivered partially dismantled.

The frame consists of the following preassembled parts: Corner strut partially dismantled as well as strut 1 left side (110° angel), strut 2 center, and strut 3 right side.

1. Put the corner strut (64/1) with the fixed plate (64/2) and join into the two diagonal placed bolts (64/4) of it the strut 2 (64/3).
The two beads of the strut must be turned to the middle of the unit.
Fix the strut 2 (64/3) with an slotted pan screw M 5 x 10 (64/5) into the corner strut.

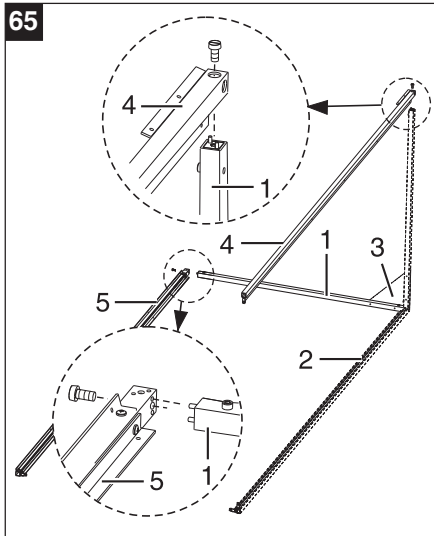

2. Connect the second corner strut with the strut 2 in the same way with an slotted pan screw M 5 x 10. Make sure that the two holes for the plate (65/3) above are turned right.
3. Put the strut 1 (65/5) (left) to the other end of the corner strut and connect it with the 2 bolt and a slotted pan screw M 5 x 10.
4. Put the strut 3 (right) to the other end of the other corner strut and connect it with the 2 bolt and a slotted pan screw M 5 x 10.
5. Fix the upper plate into the second corner strut with two pan head screws 4,8 x 9,5.

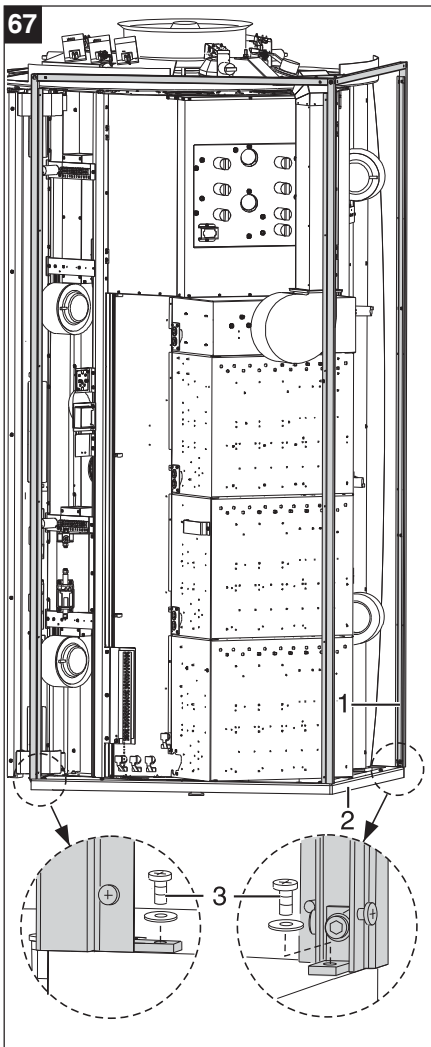
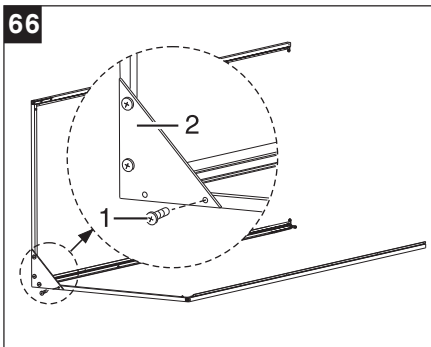

Further assembly the frame

1. Place the assembled frame (67/1) for the unit housing with the angle supports onto the bottom module (67/2).
2. Screw the frame with the three provided countersunk screws 4.2 x 13 (67/3) at the appropriate holes on the left side, in the center and on the right side.

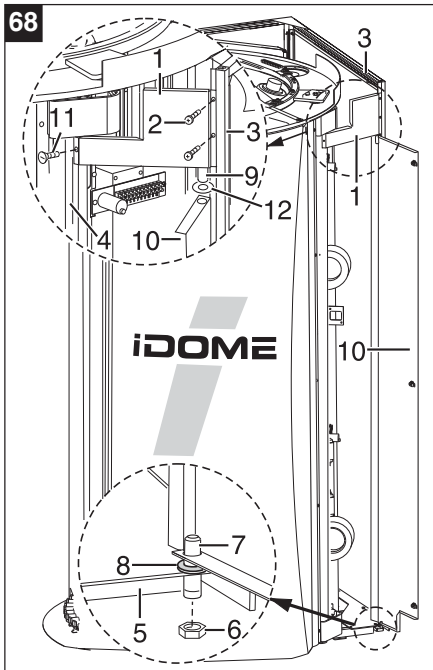

3. Apply housing part 1 at the right side of the frame, as shown in Figure 68.
4. Screw the housing (68/1) using the two 4.2 x 9.5 pan head screws (68/2) provided to the frame (68/3) and the countersunk screw 4.2 x 13 (68/11) with the support sheet (68/4).
5. Unscrew the at the bottom module (68/5) the lower hexagonal nut M 6 (68/6) and pull the hinge bolt (68/7) off to the bottom.
6. Put the plastic washer A 8.4 (68/12) to the top hinge bolt (68/9). Insert the service door (68/10) in the top hinge bolt (68/9) and place the service door (68/10) vertically into the frame (68/3).
7. Put the second plastic washer A 8.4 (68/8) under the service door (68/10) in the area of the opening for the bolt. Re-insert the bottom bolt (68/7) through the lower opening at the service door (68/10). Screw the bolt (68/7) with the hexagun nut (68/6).
8. Fix the housing part 2 (69/1) to the frame (69/2).
9. Screw the housing part (69/1) with the provided pan head screw (69/3) 4.2 x 9.5 at the appropriate fixing holes.
10. Fix housing part 3 (70/1) to the frame (70/2).
11. Fix housing part 3 (70/1) using the six 4.2 x 9.5 pan head screws (70/3) provided in the appropriate mounting holes.

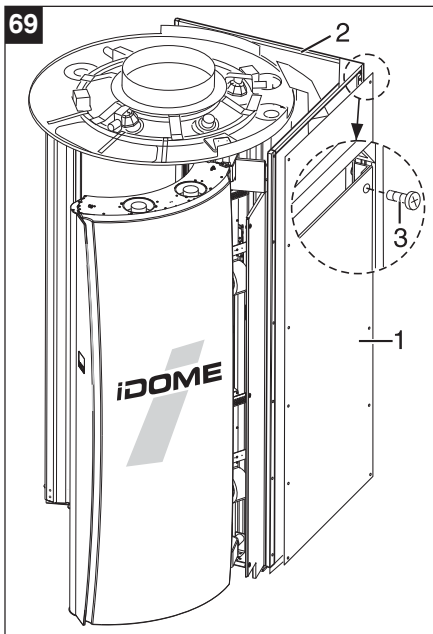

12. Fix housing part 4 (70/4) to the frame (70/2).
13. Fix housing part 4 (70/4) using the twelve 4.2 x 9.5 pan head screws (70/5) provided in the appropriate mounting holes.
14. Place the plastic hood (70/6) on the top module.
15. Place the plastic hood (70/6) first on the edge (70/7).
16. Make sure it is above the unit housing.
17. At the transition points from the unit housing to the panels recesses are provided in the plastic hood (70/8), as shown in Figure 70.
18. Put the front part of the upper plastic hood into the bottom plastic housing.

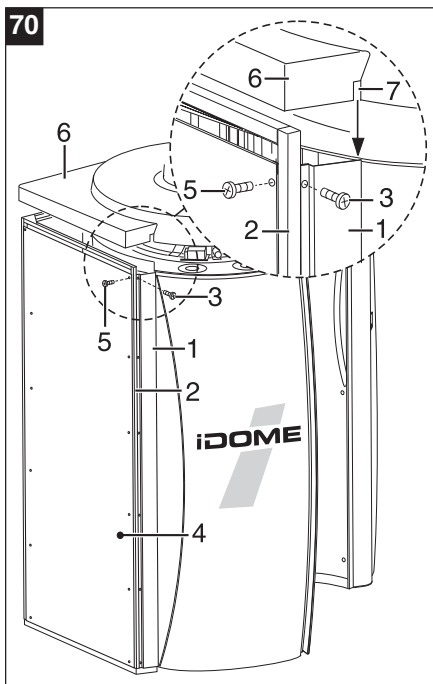

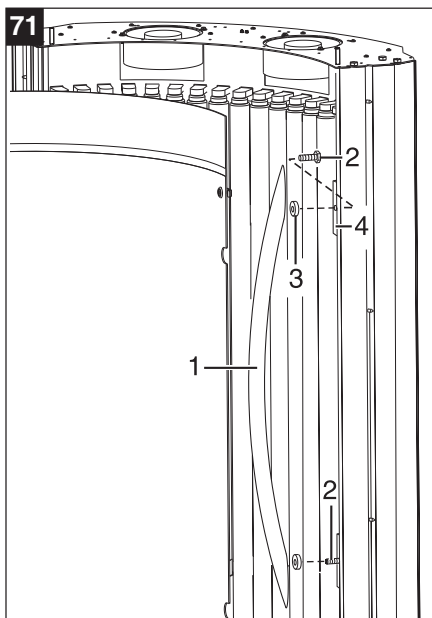

9.5 Final assembly of fittings

1. Assembly of the inside hand rail for each panel. Fix the inside hand rail (71/1) with two spacers (71/3) and two hexagonal bolts (71/2) M 6 x 30 with two contemplated supports (71/4) of the right side of each panel.
2. Mount the two outer sunlamps on the right and left in all panels, as described in Sec. 3.3.1 Page 9-10.
3. Take the acrylic panel and reinstall it, as described in Sec. 3.3.1 Page 9-10.

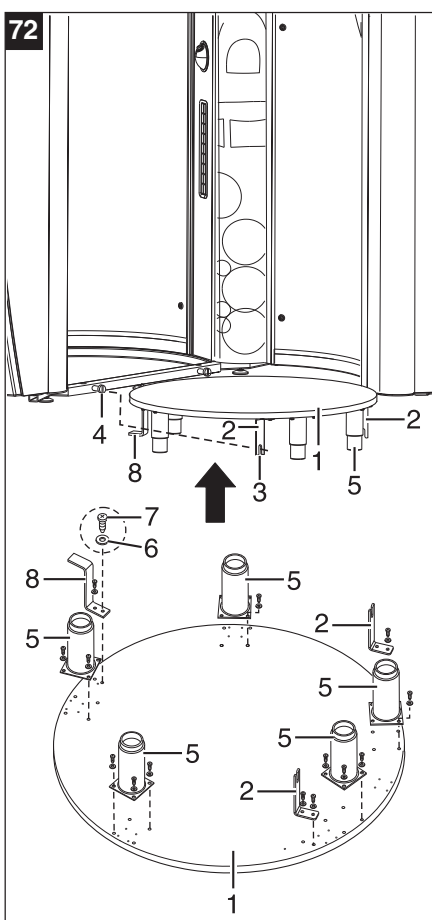

9.5.1 Assembly the bottom plate

1. Fit the 5 provided feet (72/5) with 4 washers A 6,4 (72/6) and 4 Ejot-PT-Screws 6 x14 (72/7) at the lower side of the bottom plate (72/1).
2. The positions are given by the bores.
3. Beside the 2 feet in the front fit the 2 metal fittings (72/2) each with 2 washers A 6,4 (72/6) and 2 Ejot-PT-Screws 6 x 14 (72/7).
4. Fit the dump protector (72/8) in the back area with 2 washers A 6,4 (72/6) and 2 Ejot-PT-Screws 6 x 14 (72/7).
5. The bottom plate (72/1) must be fixed in the unit with both components, the dump protection (72/8) and the fittings (72/2), because of the risk of accident.

9.5.2 Installing the bottom plate

1. Take the base plate (72/1) tilty into the unit.
Lift up the bottom plate (72/1) in the front and plug in the two fittings (72/3) at the cross strut (72/4) of the metal bottom.
The bottom plate is fixed.
2. Close the BREEZE tank as described in Sec. 3.4 Page 10.
3. Reinstall the AROMA bottle as described in Sec. 3.4.2 Page 10-11.

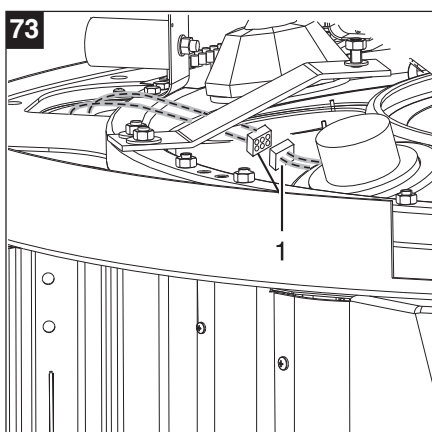

9.6 Options

1. Connect the wire (73/1) of the roof speakers and other roof parts as shown in the circuit diagram.
2. Connect the three POWERSPOT modules as shown in the circuit diagram.

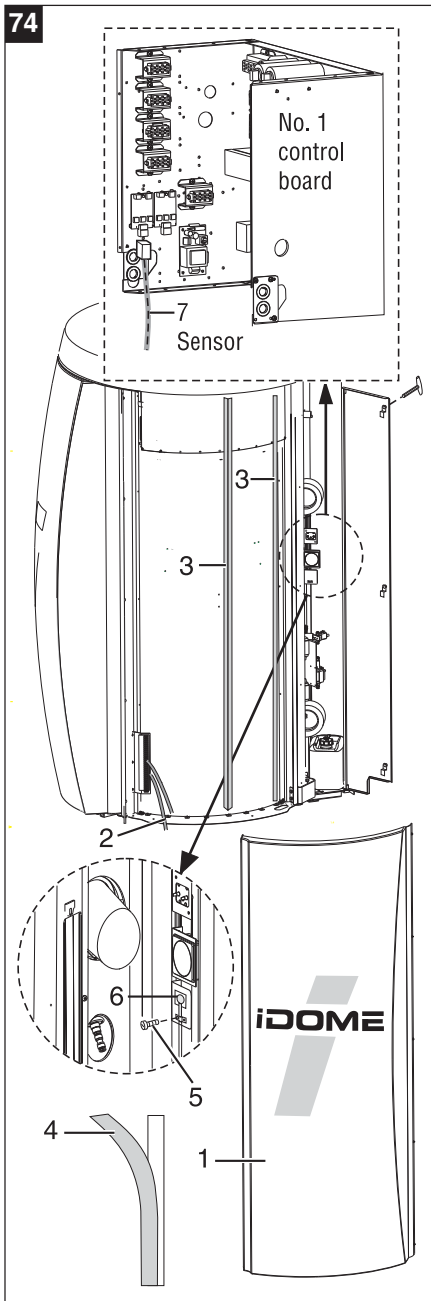

9.6.1 Translucent Canopy with RGB (Optional*)

Replacing the LED-Lights and Sensor in panel 1 / door panel

1. Loosen the ten slotted pan head screws 4,8 x 13 at the covering part panel door. Place the covering part at the side.
2. Loosen the feed cable (74/2) of the LED-bead at the terminal strip in the panel. Have the provided wiring diagram to your fingertips.
3. Remove the broken LED-bead (74/3) and the glue rests from the socket strap.
4. Remove the protection film (74/4) at the rear of the new LED-bead.
5. Glue on the new Led-bead to the old position.
6. Connect the feed cable to the LED-bead by using the provided wiring diagram.
7. Replace the covering part (74/1) panel door again and screw it together with the ten slotted pan head screws 4,8 x 13.
8. To loosen the feed cable for the sensor of the RGB remote control, you need to demount the acrylics as well as the tanning lamps and the cover of the **service shaft 1** as described in chapter 6.4.2, page 20-21.
9. On the guide plate you will find the circuit board on which the feed cable for the sensor head is plugged in. Please disconnect this Connection (74/7).
10. Open the **service shaft 2** as described in chapter 3.4, page 10.
11. Loosen the two slotted pan head screws (74/5) 2,9 x 6,5 on the rack and remove the broken sensor head (74/6) together with the feed cable.
12. Mount the new sensor head by operating backwards.

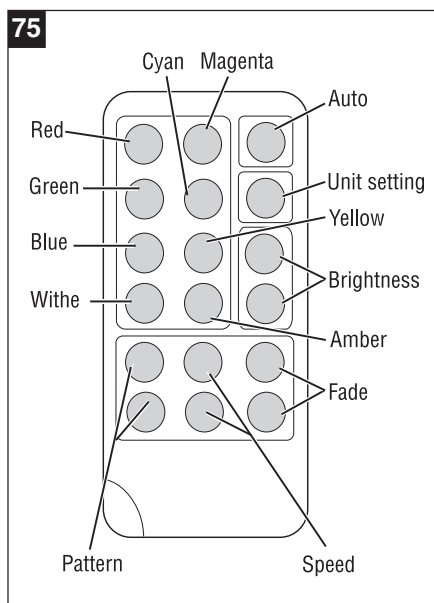

The handling of the LED-lighted panel door is founded by the RGB-controller with remote control picture 75.

9.6.2 RGB-Controller with remote control

Additional to fixed adjusted programs the colours can be regulated stageless in their brightness as well as in their speed.

The assortment of the colours red, green, blue, cyan, magenta, yellow, orange and white takes place by the push of a button as shown in picture 75.

Technical specification:

Feed in voltage	12-24V DC
Composite recording of electricity	max. 6 Ampere each channel
Exits	Collective connection via + pole and red, yellow and blue
Measures remote control	87mm (l) x 41mm (w) x 7mm (h)
Measures plate	67mm (l) x 45mm (w) x 14 mm (h)
Fields of application	LED – tapes red, yellow, blue
	LED – tapes cold white, warm white, cold+warm white
	LED – tapes RGB
	Hiflux-chains

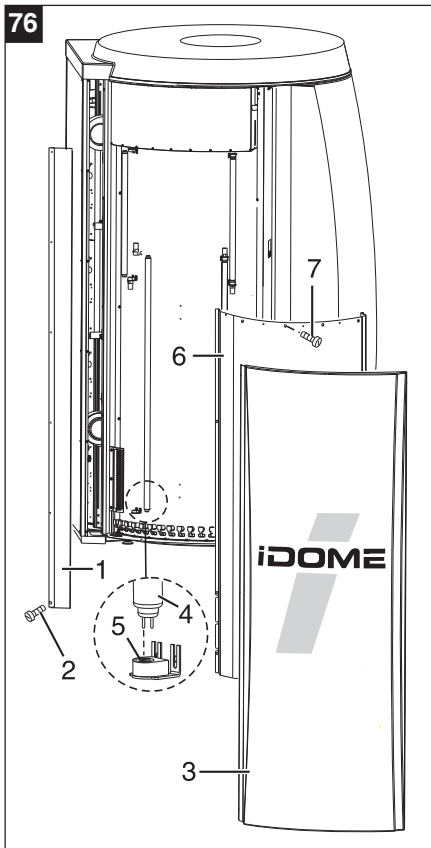

9.6.3 Translucent canopy with illumination tubes (Optional*)

Changing the illumination tubes

1. Remove the left covering of the unit (76/1) by loosening the six slotted pan head screws (76/2) 4,2 x 9.5. Place the cover part at the side.
2. Loosen the ten slotted pan head screws 4,8 x 13 at the canopy (76/3) of the panel. Place the cover part to the side.
3. Twist the broken illumination tube (76/4) in any direction until the connection spikes in the notch (76/5) of the socket become visible.
4. Unplug the illumination tube.
5. Replace the broken illumination tube (76/4) against a new one. Operate backwards for the mounting.

9.7 Connecting the Outgoing Air Unit



Warning! Important information!

Warning

The heated cooling air must be extracted from the outgoing air duct of the unit via a direct air outlet (central outgoing air duct).

You should therefore always connect an out-going air hose to the hose adapter that can be used to guide outgoing air outside.

uwe recommends using a special outgoing air chimney for this purpose as a standard addition to your unit, which you can order as an accessory.

If the outgoing air is discharged to the atmosphere via a ventilation shaft, ensure minimum flow resistance inside the shaft. Fit a booster fan if necessary.

In this case please consult an air-conditioning/ventilation specialist.

The discharge airflow is approx. 2,500 m³/hour. The same amount of fresh air must be introduced into the tanning room, and you should therefore ensure that there are fresh air vents in the tanning room wall providing a total opening cross section of at least 2,500 cm².

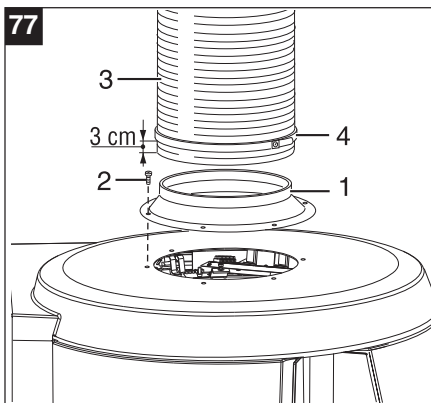

9.7.1 Mounting of the exhaust hose (optional)

1. Place the exhaust nozzle (77/1) on the covering of the roof module.
2. Screw together the exhaust nozzle (77/1) with the six slotted pan head screws (77/2) 4,2 x 9,5 at the cover of the roof module.
3. Take the exhaust hose (77/3).

Insert the hose buckle (77/4) over the exhaust hose (77/3) until a height of 3 cm.
4. Place the exhaust hose (77/3) on the exhaust nozzle (77/1) and push it to the bottom until it butts against the flange of the exhaust nozzle.
5. Now position the hose buckle (77/4) the way, that it is placed perfectly around the exhaust nozzle. Tighten the hose buckle (77/4) firmly.

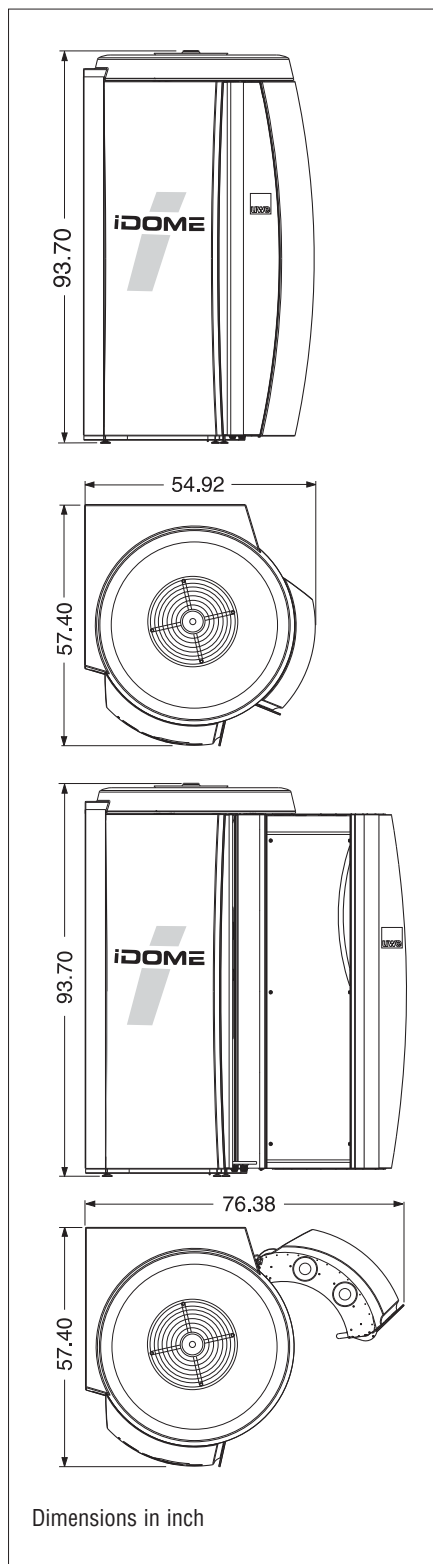

10 TECHNICAL SPECIFICATIONS

10.1. Technical Specifications, Dimensions and UV-Type*

iDOME SWING		
Unit model	350 48 10 K	
Power	[kW]	13,5
Electical connection	[V]	220 V 3~60 Hz
Protection Fuse	[A]	3 x 50 A (K50)
Weight	[pound]	ca. 1278.7
Dimensions	[inch]	
Length		54.92
Width		57.40
Height		93.70
Length iDOME open	[inch]	76.38
Recommended minimum dimension cabin L x D	[inch]	94.50 x 94.50
Noise emission ≤ 70 dB (A).		
Room temperature for operation max. 35° C		
The installation site must have a loading capacity of at least 500 kg/m² and must be flat.		

*We reserve the right to make technical modifications.

iDOME SWING		
Unit model	350 48 10 K	
	Lamps	UV-TYP nach/to EN 60335-2-27
Panel, body		
Panel backgroundlighting	2 x TL-D 36 W 18 blau / blue	
Panel hand rail illumination uwe logo	2 x LED control board	
Roof, shoulder tanning	3 x POWERSPOT 250 W	
Facial tanner	7 x POWERSPOT 250 W	
Translucent canopy RGB	6 X LED	
Translucent canopy tubes	2 x 36 W red / blue / green / amber / yellow	

CAUTION: CONNECT ONLY TO A CIRCUIT PROTECTED BY A CLASS A GROUND FAULT CIRCUIT INTERRUPTER. (ONLY FOR CANADA).

ATTENTION: BRANCHER SEULEMENT A UNE DERIVATION PROTEGÉE PAR UN DISJONCTEUR DIFFERENTIEL DE CLASSE.

! Turn off the power to the unit before changing lamps.

RELAMPING INSTRUCTIONS

REPLACEMENT LAMP TYPES

CAUTION: REPLACE ONLY WITH ORIGINAL LAMPS OR FDA APPROVED EQUIVALENT

10.2 Cover of lamps (filter discs)

The UV light sources in the panels are covered by 2.5 mm acrylic panels.

The acrylic panels are frosted on the lamp side.

The three high-pressure lamps in the roof module are covered by 3 mm acrylic panels.

11 CUSTOMER SERVICE ADDRESS

PC MARKETING
1040 WILT AVENUE
RIDGEFIELD, NJ 07657
1-800-FAST TAN

PC MARKETING
1040 WILT AVENUE
RIDGEFIELD, NJ 07657

1-800-FASTTAN



ID.-NR. 273 337/ 12/07