



## CONTENTS

|  |          |
|--|----------|
| Contents.....                                  | 1        |
| Warning Labels.....                            | 2        |
| Lamp Compatibility Chart.....                  | 3        |
| Electrical Requirements.....                   | 4        |
| General Notes.....                             | 5-6      |
| Beauty and the Responsible Tanner.....         | 7-8      |
| Tanning Sensitivity (with allergen table)..... | 9        |
| Care and Maintenance.....                      | 10-11    |
| Preventive Maintenance.....                    | 12       |
| Replacement of Components.....                 | 13       |
| Troubleshooting Guide.....                     | 14       |
| Warranty.....                                  | 15       |
| Dimensions.....                                | 16       |
| Controls.....                                  | 17       |
| Assembly.....                                  | 18 to 30 |
| Installing / removing acrylic's.....           | 31       |
| Hour counter.....                              | 32       |
| Electric drawing Delta 160 Panels.....         | 33       |
| Electric drawing Delta 180 Panels.....         | 34       |
| Electric drawing Delta Controls.....           | 35       |



## WARNING LABEL

### ⚠ WARNING

- Read the instruction booklet before using this product
- When using a folding combination machine with a canopy and bench, lie down on the bench and pull the canopy down as far as it will go
- When using a canopy only, lie down and pull the canopy down to a point no closer to the body than the minimum allowed usage distance 4 inches or 10 centimeters
- Operation of this device closer to the body than the recommended minimum distance for use may result in overexposure
- Recommended eyewear: provided eye shields (Intrexco nr. 5635/1s) or equivalent eyewear as defined under 21CFR1040.20,2(b)(6)
- Two pair of protective eyewear are furnished with this equipment and should be worn by all persons in the room when lamps are on
- Disconnect power before attempting to clean, relamp or engage in the maintenance of this product



### ⚠ DANGER

- Ultraviolet radiation
- Follow instructions
- Avoid overexposure
- **WEAR PROTECTIVE EYEWEAR** - Failure to do so may result in severe burns or long term injury to the eyes
- As with natural sunlight, overexposure can cause eye and skin injury and allergic reactions
- Repeated exposure may cause premature aging of the skin and skin cancer
- Medications or cosmetics may increase your sensitivity to the ultraviolet radiation
- Consult your physician before using sun lamps, if you are using medication or have a history of skin problems or believe yourself to be especially sensitive to sunlight
- If you do not tan in the sun, you are unlikely to tan from the use of this product
- Minimum use distance is 4 inches or 10 centimeters
- Tanning may appear after one application, provided that your skin is capable of developing a suntan
- Allow a minimum of 48 hours between exposures
- To reach maximum session times, follow the recommended exposure schedule
- To maintain your tan, it is recommended that you tan no more frequently than twice a week and do not exceed maximum exposure times



## Exposure Schedule

| RECOMMENDED<br>TANNING SCHEDULE | SKIN TYPE   |   | MAXIMUM EXPOSURE TIME IN MINUTES |        |        |         |
|---------------------------------|-------------|---|----------------------------------|--------|--------|---------|
|                                 |             |   | Week 1                           | Week 2 | Week 3 | Maximum |
|                                 | I           | Sensitive Skin<br>Burns easily & severely<br>Does not tan | Tanning Not Advised              |        |        |         |
| II                              | Light Skin  | Burns easily & severely<br>Tans minimally                 | 2                                | 3      | 6      | 10      |
| III                             | Normal Skin | Burns moderately<br>Tans moderately                       | 2                                | 3      | 6      | 10      |
| IV                              | Dark Skin   | Burns minimally<br>Tans well / above average              | 2                                | 3      | 6      | 10      |

The following lamps (or compatible) have been certified for use in this equipment:

Lighttech Combi R-UVA 180 Watt Intensive  
Light Sources Signature VHO-R 160 Watt  
Cosmolux 160 Watt-VHR

Facial units where applicable:  
Cosmolux LS 25 Watt  
Philips HPA 400/30S  
Hereus 1000 Watt

This product is in conformity with performance standards for sun lamp products under CFR 1040.20

CERTIFIED LAMPS

9123



## LAMP COMPATIBILITY CHART

### AURORA By Light Sources, Inc.

37 Robinson Boulevard, Orange, CT 06477  
Phone: 203-799-7877 Fax: 203-795-LAMP

### USER INSTRUCTIONS

**DANGER :** Ultraviolet Radiation - Follow Instructions

| Lamp Type:                          | Equivalent to:              |
|-------------------------------------|-----------------------------|
| Signature series FR71 / VH® 160Watt | Cosmolux VHR NA1-15-160Watt |
|                                     |                             |



## ELECTRICAL REQUIREMENTS

### IMPORTANT NOTICE

Please carefully read the following information prior to connecting your tanning bed.

The electrical requirements for your new tanning bed are:

| Tanning Bed Model | Required Voltage &<br>Circuit Breaker      | Required Hertz                    | Required Continuous<br>Operating Amps |
|-------------------|--|-----------------------------------|---------------------------------------|
|                   |  |                                   |                                       |
| Delta 180         | 220 Volts / 80 Amps<br>220 Volts / 40 Amps | 60Hz Single Phase<br>60Hz 3 Phase | 56 – 62<br>22 – 32                    |
| Delta 160         | 220 Volts / 80 Amps<br>220 Volts / 40 Amps | 60Hz Single Phase<br>60Hz 3 Phase | 56 – 62<br>22 – 32                    |

Operating any 220 Volt combination at voltage levels below 210 Volts or above 230 Volts constitutes an automatic NULLIFICATION of the **ProSun®** factory warranty, because it could cause damage to the unit's system.

Please insure that your electrician and/or installer, reads this user's manual carefully prior to the installation of your tanning bed.

### WARNING:

**ALWAYS DISCONNECT THE TANNING BED  
FROM ITS POWER SUPPLY WHEN SERVICING  
OR REPAIRING THE UNIT.**

## GENERAL NOTES



- *EVERY EFFORT HAS BEEN MADE TO ASSURE THAT THE EQUIPMENT OUTLINED REFLECTS THE ACTUAL EQUIPMENT EXPECTED TO BE INSTALLED. THE EQUIPMENT IS POSITIONED IN SUCH A MANNER AS TO PROVIDE OPTIMUM OPERATION. THE CUSTOMER SHALL BEAR THE SOLE RESPONSIBILITY FOR COMPLIANCE WITH ALL APPLICABLE CODES; OSHA; NEMA; LOCAL AND NATIONAL STANDARDS.*
- *EQUIPMENT WARRANTIES, EXPRESSED OR IMPLIED ON THE PART OF ProSun®, ITS DEALERS, DISTRIBUTORS OR OTHER DESIGNATED AGENTS, SHALL BE CONTINGENT UPON STRICT COMPLIANCE WITH ELECTRICAL, STRUCTURAL AND MECHANICAL RECOMMENDATIONS CONTAINED IN THIS MANUAL UNLESS SPECIFIED OTHERWISE IN THE EQUIPMENT SALES ORDER..*
- *THE CUSTOMER IS RESPONSIBLE FOR ALL ROOM PREPARATION, COSTS, FEES, PERMITS AND INSPECTIONS UNLESS SPECIFIED OTHERWISE IN THE GENERAL ORDER FOR EQUIPMENT PURCHASED*
- *ProSun®, ITS DEALERS, DISTRIBUTORS OR OTHER DESIGNATED AGENTS SHALL SUPPLY ALL INTERCONNECTING CABLES REQUIRED FOR THE EQUIPMENT. TO INCLUDE; EQUIPMENT INSTALLATION AND SETUP. ANY ADDITIONAL POWER, GROUNDING OR ANCILLARY EQUIPMENT SHALL BE THE RESPONSIBILITY OF THE CUSTOMER UNLESS SPECIFIED OTHERWISE IN THE EQUIPMENT SALES ORDER.*
- *EQUIPMENT INSTALLATION CANNOT BEGIN UNTIL THE ROOM IS COMPLETE AND READY FOR EQUIPMENT INSTALLATION. TO INCLUDE, CONTRACTORS EQUIPMENT, ELECTRICAL REQUIREMENTS AND ROOM CONSTRUCTION.*
- *ProSun®, ITS DEALERS, DISTRIBUTORS OR OTHER DESIGNATED AGENTS SHALL RESERVE THE RIGHT TO REFUSE TO INSTALL ANY EQUIPMENT INTO ANY ROOM WHICH HAS NOT BEEN PROPERLY PREPARED IN ACCORDANCE WITH THESE GENERAL NOTES.*

## GENERAL ELECTRICAL NOTES



- *ALL ELECTRICAL WORK SHALL COMFORM TO THE REQUIREMENTS OF THE NATIONAL ELECTRICAL CODE, O.S.H.A. OR APPLICABLE LOCAL AND OR STATE ORDINANCES, AS WELL AS UTILITY COMPANY RULES REGARDING AMPERE INTERRUPTION AND SAFETY SHUNT TRIP SWITCHES AND POWER PANELS OF WHICH SHALL BEAR THE LABEL OF UNDERWRITER'S LABORATORIES, INCORPORATED AND SHALL BE PERMANENTLY MARKED FOR EASY IDENTIFICATION.*
- *ALL WIRES SHALL BE SINGLE SOLID RUNS WITHOUT SPLICES MEETING THE N.E.M.A. STANDARDS*
- *THE ELECTRICAL CONTRACTOR SHALL PROVIDE AND INSTALL ALL ELECTRICAL MATERIAL AS SPECIFIED FOR A SAFE OPERATING SYSTEM.*
- *THE ELECTRICAL CONTRACTOR SHALL RING OUT AND TAG AND TERMINATE ALL WIRES AT BOTH ENDS, WITH EACH RUN TO BE INSPECTED TO ENSURE THAT NO WIRES HAVE BEEN GROUNDED OR OPEN.*
- *THE CUSTOMER SHALL PROVIDE A DEDICATED POWER SOURCE WHEN CALLED FOR BY PROSUN, ITS DEALERS, DISTRIBUTORS OR OTHER DESIGNATED AGENTS.*
- ***ProSun®**, ITS DEALERS, DISTRIBUTORS OR OTHER DESIGNATED AGENTS ARE NOT RESPONSIBLE FOR THE FINAL INSTALLATION OF THE ELECTRICAL SYSTEM. THE RECOMMENDED ELECTRICAL PLAN MUST BE COORDINATED BETWEEN THE CUSTOMER AND THE ELECTRICAL CONTRACTOR. ANY DEVIATION TO THE ELECTRICAL PLAN BEFORE, DURING AND AFTER EQUIPMENT INSTALLATION IS THE RESPONSIBILITY OF THE CUSTOMER.*
- *THE ELECTRICAL CONTRACTOR SHALL ENSURE THE COMPLETION OF ALL ELECTRICAL REQUIREMENTS PRIOR TO THE INSTALLATION OF ANY **ProSun®** SYSTEM.*

## BEAUTY AND THE RESPONSIBLE TANNER



Many people in today's image-conscious society want to be tanned. The Romans built large sunning terraces onto their villas so as to take advantage of the sun's spiritually and physically therapeutic effects. They somehow inherently knew of the positive influences that natural sunlight could lend to the human condition, millennia before the science of photobiology was conceived of.

Researchers in this field have concluded that there are indeed a number of good things that can be had by regulated exposure to filtered sunlight, not the least of which being the production of vitamin D, a major contributing substance in the fight against many different types of skin disorders. All of the body's basic functions are enhanced by a strengthened immune system, which occurs directly as a result of moderate dosages of the right types of ultraviolet light absorbed under controlled conditions.

The negative effects resultant of too much natural sunlight, however, is known to many of us in the forms of sunburn, premature aging and wrinkling of the skin, and finally, skin cancer. Avoiding these notorious hazards at all costs, as well as knowing how your individual skin type reacts to ultraviolet light, are the primary keys to successfully and responsibly achieving the tan you have always wanted.

Start by asking the question, "just what is a tan?"

### UV (ULTRAVIOLET) RAYS

Light is measured and analyzed by reading the variations in frequency of a wavelength (like radio waves) on an oscilloscope. Ultraviolet light isn't visible to the unassisted human eye, and must therefore be measured by special sensing devices, i.e. a UVA-meter. The three types of UV are UVA, UVB and UVC.

UVA has a higher frequency of wavelength than UVB or UVC, and is the ray which is thought to promote the excretion of pigment from the hormone called "Melanin", which occurs naturally in the skin.

UVB is believed to be the catalyst, or kick-starter for the Melanin to begin producing pigment. It is also the ray which causes sunburn and wrinkling, so the skin can withstand only brief dosages at very small percentage levels to UVA.

UVC, present in natural sunlight, is mostly filtered out by the ozone layer in the upper atmosphere, and is extremely harmful to human skin, at any level of exposure.

In tanning beds, only small percentages of UVB to UVA are used to effect tanning - example: 95% UVA-to-5% UVB - whereby the individual tanner will be placed on an acceptable exposure schedule according to his or her skin type. There is no UVC emitted by tanning lamps.

## The Tanning Process



The sunbed you have purchased is designed to concentrate optimal levels of UVA, in conjunction with very low percentages of UVB, on the outermost layers of the skin, so as to stimulate the production of Melanic pigment, which is slightly pink in its dormant state, and cause it to turn brown after excretion. The more Melanin cells present in the skin determines the amount of pigment that will be excreted and distributed, and therefore the extent of the tan.

### **A COMPREHENSIVE GUIDE TO RESPONSIBLE TANNING:**

1. Depending upon skin type, tanning “treatments, each consisting of 10 to 12 individual sessions, taken over a period of 20 to 24 days, should be embarked upon. No more than 2 of these treatments per week should be undertaken, for more in-depth details for tanning see the schedule label on bed.
2. Allow at least 48 hours to pass between each tanning session.
3. If you are taking any kind of medication, or are wearing facial cosmetics, make sure to first consult your doctor before tanning. Certain ingredients in pharmaceutical products and make-up could induce UV light sensitivity and cause allergic reactions. A table describing a number of known allergens can be seen later in this manual.
4. For best facial tanning results, make sure to clean the face of cosmetics thoroughly at least three hours before each session. Better still, if possible, try not to wear any make-up during the day of the session.
5. Don’t use tanning lotions, oils or gels, which contain SPF (sun protection factor), as these could hinder the desired tanning effect. Use only those that are specifically manufactured for use in tanning beds.
6. If your skin develops or displays any sort of undesired reaction such as a rash, acne, or unusual dryness, stop tanning immediately. If the problem doesn’t clear itself up within a couple of days, consult your doctor.
7. Always avoid sunburn. If you overexpose yourself you could erythemize (sunburn) the skin. Should this occur, stop tanning until the reddish color fully subsides, then recalculate your exposure schedule before continuing the treatment.
8. Read the WARNING label situated in full view of the user on the outside of the sunbed carefully before beginning a tanning session.
9. Never use “tanning accelerator” pills in conjunction with your tanning treatment, as these could lead to an increase of skin sensitivity to sunburn.





## TANNING SENSITIVITY

### MEDICATION LIST

Perfumes and colognes containing furocoumarins, compounds from natural products such as plants and fruits and their natural oils can sensitize the skin to sunlight.

Food and fruits that contain photosensitizing agents: celery, carrots, lime, coriander, parsley, fennel, dill, buttercup, mustard and figs. A partial list of known photosensitizing medications is listed below by name:

|                                  |                                     |   |
|----------------------------------|-------------------------------------|---|
| ACETOHEXAMIDE (DYMELOR)          | ACRIDINE PREPARATIONS (SLIGHT)      | AGAVE LECHUGUILLA (AMARYLLIS)           |
| AGRIMONY                         | 9-AMINOACRIDINE                     | AMINO BENZOIC ACID                      |
| AMITRIPTYLINE (ELAVIL, ETC.)     | ANESTHETICA (PROCAINE GROUP)        | ANGELICA                                |
| ANTHRACENE                       | ANTIMALARIALS                       | ARSENICALS                              |
| BARBITURATES                     | BAVACHE (CORYLIFOLIA)               | BENZENE                                 |
| BENZOPYRINE                      | BERGAMOT (PERFUME)                  | BITHIONAL (ACTAMER, LOROTHIDOL)         |
| BLANKOPHORES (SULFA DERIVATIVES) | BULOSEMIDE (JADIT)                  | BROMCHLORSALICYLANILID                  |
| 4-BUTYL-4-CHLOROSALICYLANILIDE   | CARBAMAZEPINE (TEGRETOL)            | CARBINOXAMINE D-FORM (TWISTON R-A)      |
| CARBUTAMIDE (NADISAN)            | CARROTS, WILD                       | CEDAR OIL                               |
| CELERY                           | CHLOROPHYLL                         | CHLOROTHIAZIDE (DIURIL)                 |
| CHLORPROMAZINE (THORAZINE)       | CHLORTETRACYCLINE (AUREOMYCIN)      | CITRON OIL                              |
| CITRUS FRUITS                    | CLOVER                              | COAL TAR                                |
| CONTRACEPTIVES, ORAL             | DEMECLOCYCLINE                      | DECLOMYCIN                              |
| DIMETHYLCHLORTETACLYLINE         | DESIPRAMINE (NORPRAMIN, PERTOFRANE) | DIBENZOPYRAN DERIVATES                  |
| DICYANINE-A                      | DIETHYLSTILBESTROL                  | DIGALLOYL TRIOLEATE SUNSCREEN           |
| DILL                             | DIPHENHYDRAMINE HYDROCHLORIDE       | EOSIN (SLIGHT)                          |
| ESTRONE                          | FENNEL                              | FLOURESCIN DYES                         |
| 5-FLUOROURACIL                   | GLYCERYL P-AMINO BENZOATE           | GOLD SALTS                              |
| GRASS (MEADOW)                   | GRISEOFULVIN (FULVICIN)             | HEMATOPORPHYRIN                         |
| HEXACHLOROPHENE (RARE)           | HEXACHLOROTHIAZIDE (ESIDRIX)        | IMPRAMINE HCL (TOFRANIL)                |
| ISOTHIPENCYL (THERUHISTIN)       | ISOTHIPENDYL                        | LADY'S THUMB (TEA)                      |
| LANTININ                         | LAVENDER OIL                        | LIME OIL                                |
| MECLOTHIAZIDE (ENDURON)          | MEPAZINE (PACATAL)                  | 9-MERCAPTOPURINE                        |
| METHOTRIMEPAZINE (LEVOPROME)     | METHOXSALEN (MELOYINE, OXSORALEN)   | 5-METHOXYPSORALEN                       |
| 8-METHOXYPSORALEN                | MONOGLYCEROL PARA-AMINO BENZOATE    | MUSTARDS                                |
| NALIDIXIC ACID                   | NAPHTHALENE                         | NORTRIPTYLINE (A VENTYL)                |
| OXYTETRACYCLINE (TERRAMICIN)     | PARA-DIMETHYLAMINO AZOBENZENE       | PARAPHENYLENEDIAMINE                    |
| PARSLEY                          | PARSNIPS                            | PENICILLIN DERIVATIVES                  |
| PERIOLINE                        | PERPHENAZINE (TRILAFON)             | PENANTHRENE                             |
| PHENAZINE DYES                   | PHENOLIC COMPOUNDS                  | PHENOTHIAZINES (DYES, METHYLENE BLUE)   |
| PHENOXAZINES                     | PHENYLBUTAZONE (BUTAZOLIDIN)        | PHENYTIOLIN (DILANTIN)                  |
| PITCH AND PITCH FUMES            | PORPHYRINS                          | PROCHLORPERAZINE                        |
| PROMAZINE HYDROCHLORIDE          | PROFRIPTYLINE                       | PSORALENS                               |
| PYRATHIAZINE HYDROCHLORIDE       | PYRIDINE                            | QUINETHAZONE (HYDROMOX)                 |
| QUININE                          | ROSE BENGAL PERFUME                 | RUE                                     |
| SALICYLANILIDES                  | SALICYLATES                         | SANDALWOOD OIL (PERFUME)                |
| SILVER SALTS                     | SMARTWEED (TEA)                     | STILBAMIDINE ISETHIONATE                |
| SULFACETAMIDE                    | SULFADIAZINE                        | SULFADIMETHOXINE                        |
| SULFAGUANIDINE                   | SULFANILAMIDE (SLIGHT)              | SULFAMERAZINE                           |
| SULFAMETHANIZINE                 | SULFAPYRIDINE                       | SULFATHIAZOLE                           |
| SULFONAMIDES                     | SULFAISOMIDINE (ELKOSIN)            | SULFONYLUREAS (ANTIDIABETICS)           |
| TETRACHLORSALICYLANILIDE         | TRETACYCLINES                       | THIAZIDES (DIURIL, HYDRODIURIL)         |
| THIOPHENE                        | THIOPROPAZATE DIHYDROCHLORIDE       | TOLBUTAMIDE (ORINASE)                   |
| TOLUENE                          | TRIBROMOSALICYLANILIDE (TBS)        | TRICHLORMETHAZIDE (METHAHYDRIN)         |
| TRIDIONE                         | TRIETHYLENE MELAMINE (TEM)          | TRIFLUPROMAZINE HYDROCHLORIDE (VESPRIN) |
| TRIMEPAZINE TARTRATE (TEMARIL)   | TRIMETHADIONE (TRIDIONE)            | TRIPYRATHIAZINE                         |
| TRYPTALVINE                      | TRYPAN BLUE                         | VANILLIN OILS                           |
| WATER ASH                        | XYLENE                              | YARROW                                  |

## A FEW QUESTIONS THAT ARE FREQUENTLY ASKED:

**Question** - How far away from the tanning lamps should the body be positioned?

**Answer** - To within 10 to 15 centimeters (4 to 6 inches)

**Question** - Does indoor tanning provide protection against sunburn outdoors?

**Answer** - No, indoor tanning is cosmetic only. Use lotions with high SPF outdoors

**Question** - Should a woman tan indoors during pregnancy?

**Answer** - Always consult your doctor before tanning during pregnancy.

Important note: Not everyone has the same skin type or tanning propensity. This needs to be taken into serious consideration when calculating a proper exposure schedule.

## CARE AND MAINTENANCE



The Care and Maintenance in this section covers most of the difficulties that you may encounter under normal working circumstances. If your tanning bed fails to operate properly, please review the following steps before calling for service.

THE TANNING BED YOU PURCHASED CONTAINS VOLTAGES WHICH ARE POTENTIALLY HAZARDOUS. ALL REPAIRS AND GENERAL MAINTENANCE SHOULD BE PERFORMED BY QUALIFIED SERVICE PERSONNEL.

### **FOR YOUR TANNING BED:**

Safe and continuous operation of your tanning bed depends partially on the care taken by users. Please observe the following precautions when tanning bed is in use.

- Do not disassemble any part of the bed while in use.
- Do not allow sharp objects in the bed while in use.
- Do not allow liquid or any foreign objects to get inside the bed.
- Ensure the beds back side is at least 6 – 12 inches away from the wall.
- Avoid from having the acrylic sheets come in contact with sharp edges and objects
- Insure that the main exhaust hoses are never kinked and keep them free of debris.
- The room or cabin in which the unit is operated must be well ventilated.
- Make sure that the unit never comes in contact with water while connected to power.
- Do not turn the machine on and off frequently within the space of 3 minutes.

## MAINTENANCE



### **Cleaning the machine**

Always disconnect the main power from the unit before attempting to clean or repair it. Dust the lamps with a dry cloth - **do not use cleaning fluid or alcohol.** The acrylics should be taken out at least once every week of operation and cleaned thoroughly with a non-alcoholic disinfectant glass or surface cleaner. If alcohol is used, the acrylic may fade, crack, or break altogether. Failure to use anything other than an approved cleaning material on the acrylic will result in poor UV-transmission, and could eventually cause injury to the person using the machine. Use a vacuum cleaner with a dust nozzle to clean around the ballast racks and throughout the interior portions of the base, top deck, and bench.

### **Longevity of the acrylic sheets**

The acrylic sheets used in this machine should be changed between 1200 and 1500 hours of operation. If not, UV-transmission could be greatly reduced.

*ProSun*<sup>®</sup> recommends the use of Lucasol or Solacryl when cleaning acrylic sheets

### **Longevity of the lamps**

Most lamps will display up to 120% of rated output during the first 50 hours of illumination. As such, exposure schedules should be reduced by 20%, or sunburning may occur. After the initial 50 hours, the lamps will run at 100% of their rated output and gradually go down from there, until about 800 hours, whereupon the lamps should be replaced.

### **What to do with old lamps?**

Contact your local garbage disposal company or city authority to find out what is the most environmentally sound manner of throwing away old fluorescent lamps.

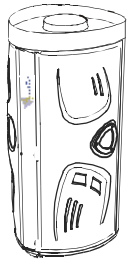

## PREVENTITIVE MAINTENANCE

| Frequency              | Clean Acrylic Top & Bottom | Clean Pillow | Clean & Sanitize Goggles | Ensure Clip Strip is firmly in place | Clean and Sanitize Bed Exterior | Remove & Clean the inside both Acrylic sheets | Dust Lamps | Wipe and Vacuum fans & vents | Clean all Reflectors | Wipe and Vacuum out Air Vents | Inspect Acrylic for cracks wear | Replace Top and Bottom Acrylic | Adjust shock tension (if needed) | Test Remote System | Check all Bolt and nuts for wear and tear |
|------------------------|----------------------------|--------------|--------------------------|--------------------------------------|---------------------------------|---|------------|------------------------------|----------------------|-------------------------------|---------------------------------|--------------------------------|----------------------------------|--------------------|---|
| After Each Session     | *                          | *            | *                        | *                                    |                                 |   |            |                              |                      |                               |                                 |                                |                                  |                    |   |
| Daily                  | *                          | *            | *                        |                                      | *                               |   |            |                              |                      |                               | •                               |                                |                                  |                    |   |
| Weekly                 | *                          | *            |                          |                                      |                                 | *   | *          | *                            |                      | *                             |                                 |                                | •                                | •                  | •   |
| Monthly                | *                          | *            |                          |                                      |                                 |   |            |                              | *                    |                               |                                 |                                |                                  |                    |   |
| every 1200 hrs. of use |                            |              |                          |                                      |                                 |   |            |                              |                      |                               |                                 | •                              |                                  |                    |   |

**\*\* Please Refer to the Lamp Manufacturer Specifications for Lamp and Facial Bulb Replacement and Frequency.**

When replacing Facial Bulbs ensure that any finger prints on the bulb itself are wiped clean using the cleaning pad provided with replacement bulbs or alcohol.

**ProSun®** recommends the use of Lucasol or Solacryl when cleaning acrylic sheets

\* Certified by: International Smart Tan Network.

For information about becoming a certified member, call or write to: International Smart Tan Network, 3101 Page Avenue, Jackson, MI 49203, (517) 784-1772

*The acrylic sheets used in this machine should be changed between 1200 and 1500 hours of operation. If not, UV-transmission could be greatly reduced.*

**ProSun®** recommends the use of Lucasol or Solacryl when cleaning acrylic sheets

## REPLACEMENT OF COMPONENTS



**WARNING:** Before doing any repair or replacement work on this machine, **ALWAYS** disconnect the power (or, if the main power cable has a wall plug, pull it out) at the main circuit breaker.

### Removal of the acrylic's:

**WARNING:** Let the tanning bed cool down for one hour before opening the acrylic sheets.

1. Unscrew the acrylic cover with the 4 quick locks (use screw driver).
2. Unscrew the acrylic lock bolts at the top (use coin).
3. Take the acrylic out starting at the out side.
4. Put the acrylic in a secure place.
5. For the door acrylic start with step 2.
6. Take the acrylic out starting at the out side.
7. Then lift the acrylic up.
8. Put acrylic in secure place.

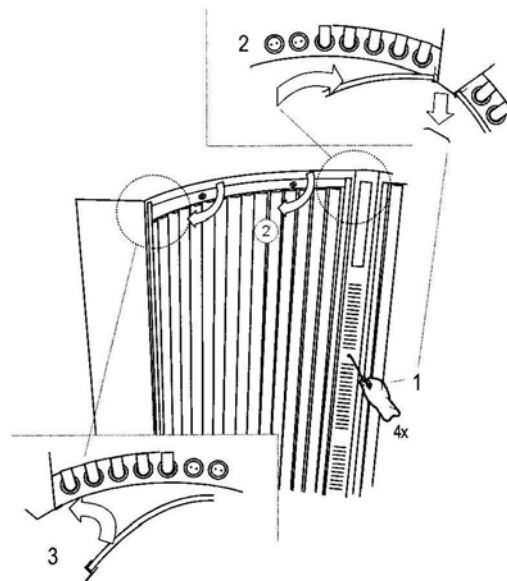

### Lamp replacement:

Holding the lamp at both ends, turn it until the bi-pins can slide easily out of the lamp holder socket, and slowly take it out of the unit. Clicks will be heard as the socket incrementally rotates. Replace the lamp in just the opposite manner; making sure that the labeling on the lamp itself is pointed outward, away from where the tanner would lay in the machine. **SEE WARNING LABEL FOR LAMP TYPES.**

### Starter replacement:

Grasp and turn the starter to the left, one half turn until it comes easily out of the socket. Replace the starter in the opposite manner.

**IMPORTANT:** ONLY USE MANUFACTURER - AUTHORIZED REPLACEMENT COMPONENTS. FAILURE TO DO SO MAY VOID WARRANTY.



## TROUBLE SHOOTING GUIDE

| PROBLEM                               | PROBABLE CAUSE   | POSSIBLE SOLUTION   |
|---------------------------------------|--|---|
| Unit is activated but nothing happens | <ul style="list-style-type: none"> <li>No Power</li> <li>Timer clears after priming</li> <li>Remote timer does not work</li> </ul>     | <ul style="list-style-type: none"> <li>Check to see if the power source has been properly connected</li> <li>Restart the timer and try again</li> <li>Check connections to both – replace if defective</li> </ul> |
| Bed appears too be to hot             | <ul style="list-style-type: none"> <li>Fans are obstructed</li> <li>Room temp to high</li> </ul>                                       | <ul style="list-style-type: none"> <li>Ensure all fans or clear of obstructions and dust.</li> </ul>  |
| Unit temperature abnormally warm      | <ul style="list-style-type: none"> <li>Bed is too close to the wall</li> </ul>   | <ul style="list-style-type: none"> <li>Pull the bed away from the wall at least 6 – 12 inches.</li> </ul>   |
| Individual lamps do not light         | <ul style="list-style-type: none"> <li>Lamp not in socket properly</li> <li>Lamp is defective</li> <li>Starter is defective</li> </ul> | <ul style="list-style-type: none"> <li>Turn lamp in socket until lamp illuminates</li> <li>Replace lamp</li> <li>Replace starter</li> </ul>   |
| Lift System does not go up or down    | <ul style="list-style-type: none"> <li>Loose connector</li> </ul>  | <ul style="list-style-type: none"> <li>Locate (see setup manual) and secure connection</li> </ul>   |
|                                       |  |   |

To see more detailed troubleshooting information please go to [www.prosun.com](http://www.prosun.com) or call ProSun on:  
1-800-874-2776

**ProSun®**  
**LIMITED WARRANTY**  
**EFFECTIVE January 1-2002**

**1. Warranty Period:** PROSUN warrants new tanning equipment manufactured or imported by it, provided it is still owned and operated by the original purchaser, to be free from defects in material and workmanship under normal use and service, for a prorated period of two (2) years from the date of delivery to the original Purchaser.

**2. Activation of Warranty:** To activate this Limited Warranty the original Warranty Registration card attached hereto must be completed by the Purchaser and the Selling Dealer at the time of delivery to the Purchaser, and returned to PROSUN within fifteen (15) days of delivery as a condition precedent to obtaining any coverage under this Limited Warranty.

**3. What is covered:** During the warranty period as specified above PROSUN will replace any defective system or component, at PROSUN's sole discretion. The Purchaser shall be responsible for the difference between the cost of a new system or component and the prorated value of the defective system or component. Prior to making any repairs PROSUN will advise the Purchaser of the nature of the problem and the cost to the Purchaser based on the proration of the defective system or component.

**4. What is not covered:**

A) Acrylic sheets, starters (igniters), Lamps, blue and clear filter glass.

B) Any plastic parts affected by discoloration.

C) Any failure or problems resulting from improper installation of the product.

D) Any failure or problems resulting from accident, abuse, neglect, improper maintenance, alteration, use of parts not supplied by PROSUN, or failure to operate and use the product in accordance with the instructions provided in the Owner's Manual supplied with the product.

E) Any failure to the external timing system (example: T-Max, FST)

F) Any damage caused by the failure of any supporting hardware not supplied by PROSUN.

G) Any failure or damage caused by repair by an unauthorized person.

H) Any labor charges, travel time charges, or mileage charges associated with a warranty item.

I) Shipping costs to PROSUN's factory. PROSUN will pay for ground transportation back to the purchaser.

**1. Procedure for Requesting Warranty Work:** In the event of a problem covered under this limited warranty, the customer must first contact PROSUN and obtain a Returned Goods Authorization for products to be repaired or replaced at PROSUN's option, provided product(s) are returned freight prepaid to PROSUN. PROSUN will perform its obligation within thirty (30) days from the date of PROSUN's receipt of the Purchaser's authorization to effect repairs and acceptance of the cost of repairs based on the prorated values of the defective systems or components. Any payment due from the Purchaser shall be payable in full prior to PROSUN's return of the repaired system or component.

**2. Right to Modify:** PROSUN reserves the right to make changes or improvements in its products without incurring any obligations to similarly alter products which have been previously purchased.

**3. Exclusivity of Warranty:** This warranty is the only warranty made by PROSUN and may only be modified or amended by a written instrument signed by a duly authorized officer of PROSUN. PROSUN's sole and exclusive liability and Purchaser's sole and exclusive remedy under this warranty shall be, at PROSUN's option, to repair or replace, to the extent available on a prorated basis, any such defective Products. These remedies are available only if PROSUN's examination of such Products discloses to PROSUN's satisfaction that such defects actually exist and were not caused by Purchaser's misuse, neglect, improper installation or testing, attempts to repair, or any other cause beyond the range of normal usage, or by accident, fire or other hazard. Repair or replacement of a part does not extend the warranty period or extend the prorated value of a part or product beyond the initial two year limited warranty period from the date of delivery.

**THE WARRANTY SET FORTH ABOVE IS IN LIEU OF ALL OTHER WARRANTIES, EXPRESS OR IMPLIED, INCLUDING BUT NOT LIMITED TO ANY IMPLIED WARRANTY OF MERCHANTABILITY OR FITNESS FOR A PARTICULAR PURPOSE. IN NO EVENT SHALL PROSUN BE LIABLE FOR ANY INCIDENTAL OR CONSEQUENTIAL DAMAGES WITH RESPECT TO THE PRODUCTS DELIVERED HEREUNDER OR SUBSEQUENT USE THEREOF.**

**4. Limitation of Liability:** PROSUN shall not be liable for any loss, damages, or penalty resulting from failure to perform any of its obligations under this Agreement due to force majeure or any cause beyond its reasonable control.

**PROSUN'S LIABILITY UNDER OR FOR BREACH OF THIS AGREEMENT SHALL NOT EXCEED THE REFUND OF THE PURCHASE PRICE LESS REASONABLE RENTAL FOR PAST USE. IN NO EVENT SHALL PROSUN BE LIABLE FOR COSTS OF PROCUREMENT OF SUBSTITUTE GOODS BY THE PURCHASER OR FOR UNAUTHORIZED REPAIRS UNDERTAKEN BY THE PURCHASER WITHOUT PROSUN'S PREVIOUS WRITTEN APPROVAL. IN NO EVENT SHALL PROSUN BE LIABLE FOR ANY SPECIAL, CONSEQUENTIAL, OR INCIDENTAL DAMAGES, HOWEVER CAUSED, WHETHER FOR BREACH OF WARRANTY, NEGLIGENCE, OR OTHERWISE. PROSUN DISCLAIMS ANY OBLIGATION OR LIABILITY FOR LOSS OF USE OF THE PRODUCT WARRANTED, LOSS OF TIME, INCONVENIENCE, COMMERCIAL LOSS OR ANY OTHER DIRECT, CONSEQUENTIAL, SPECIAL OR INCIDENTAL DAMAGES.**

**5. Governing Law:** Notwithstanding principles of conflicts of law of any jurisdiction to the contrary, all terms and provisions of this Agreement are to be construed and governed by the laws of the state of Florida without regard to the laws of any other jurisdiction. The Purchaser waives any and all privileges and rights which they may have under Chapter 47, Florida Statutes (1993), relating to venue as it now exists or may hereafter be amended, and under any other statute, or administrative provision thereof in any legal action on this Agreement; and further, the Purchaser agrees that any legal action brought on this Agreement or in connection therewith, shall be brought in the appropriate court in Pinellas County, Florida.

**6. Attorneys Fees:** Should a dispute arise with regard to this warranty or any other aspect of this sale the prevailing party shall be entitled to reasonable attorneys fees and costs through appeal.

# Dimensions ProSun Delta 160 / 180

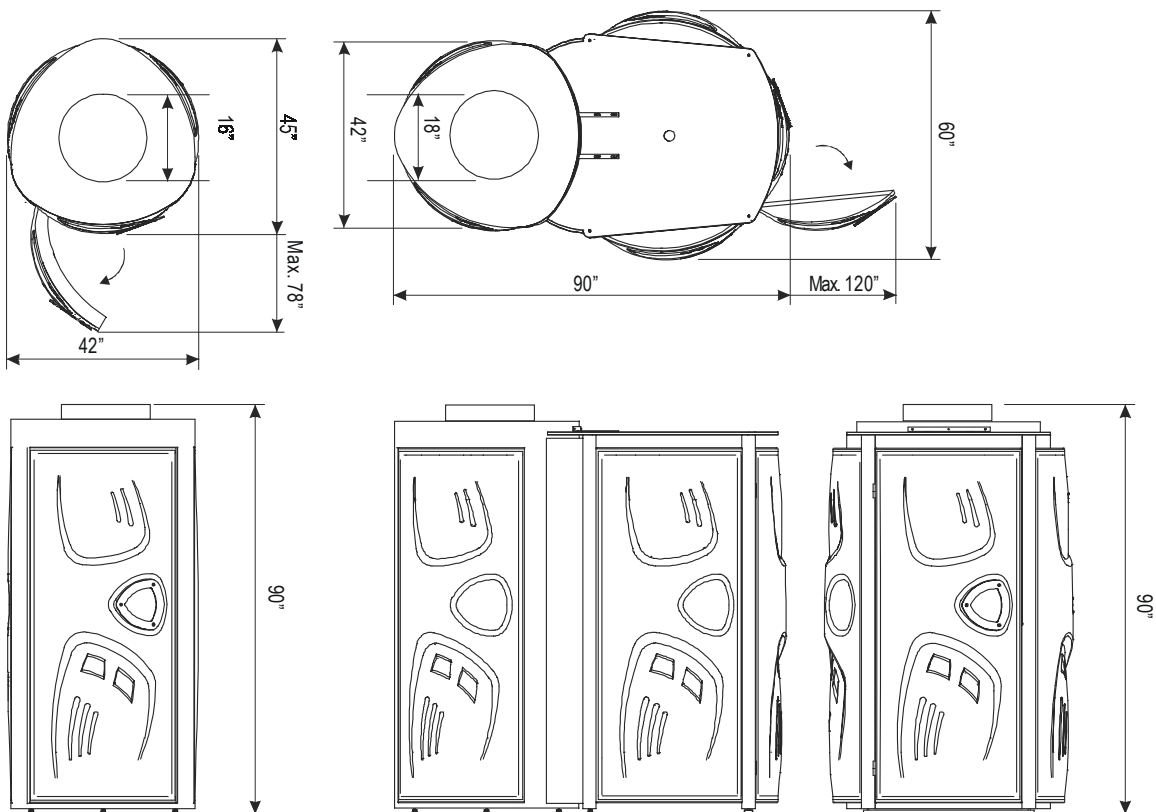



## Controls



- Display  
The display shows the elapsed time in minutes.
- Arrows  
Indicates the movement direction of the lift.
- Fan  
On / off Switch of the fan
- Stop button  
Stop button switch shuts the unit down.  
(After cooling last 3 minutes).

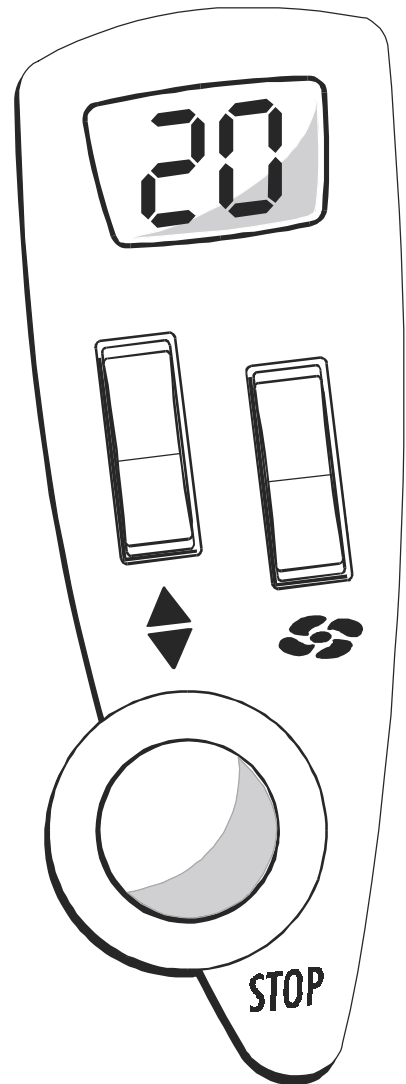

## Assembly

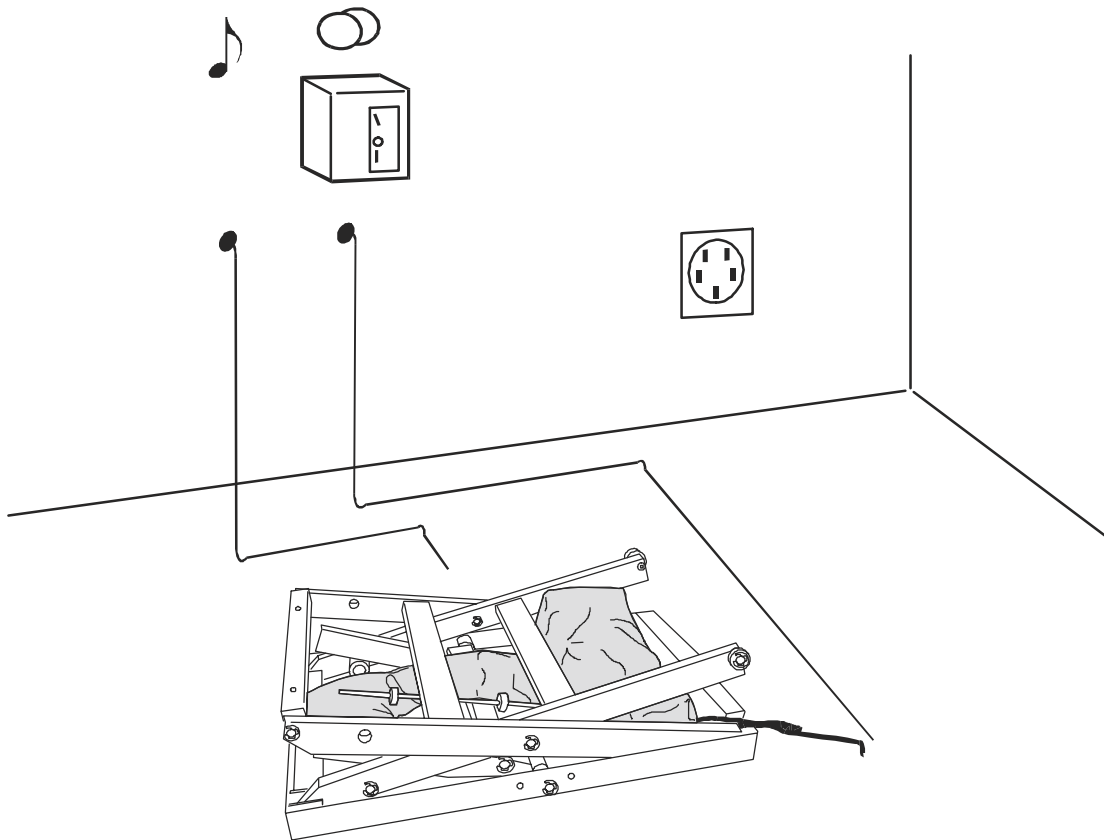

If the lift option is chosen, place the lift on a level surface with the motor and the wires on the right side.

## Assembly

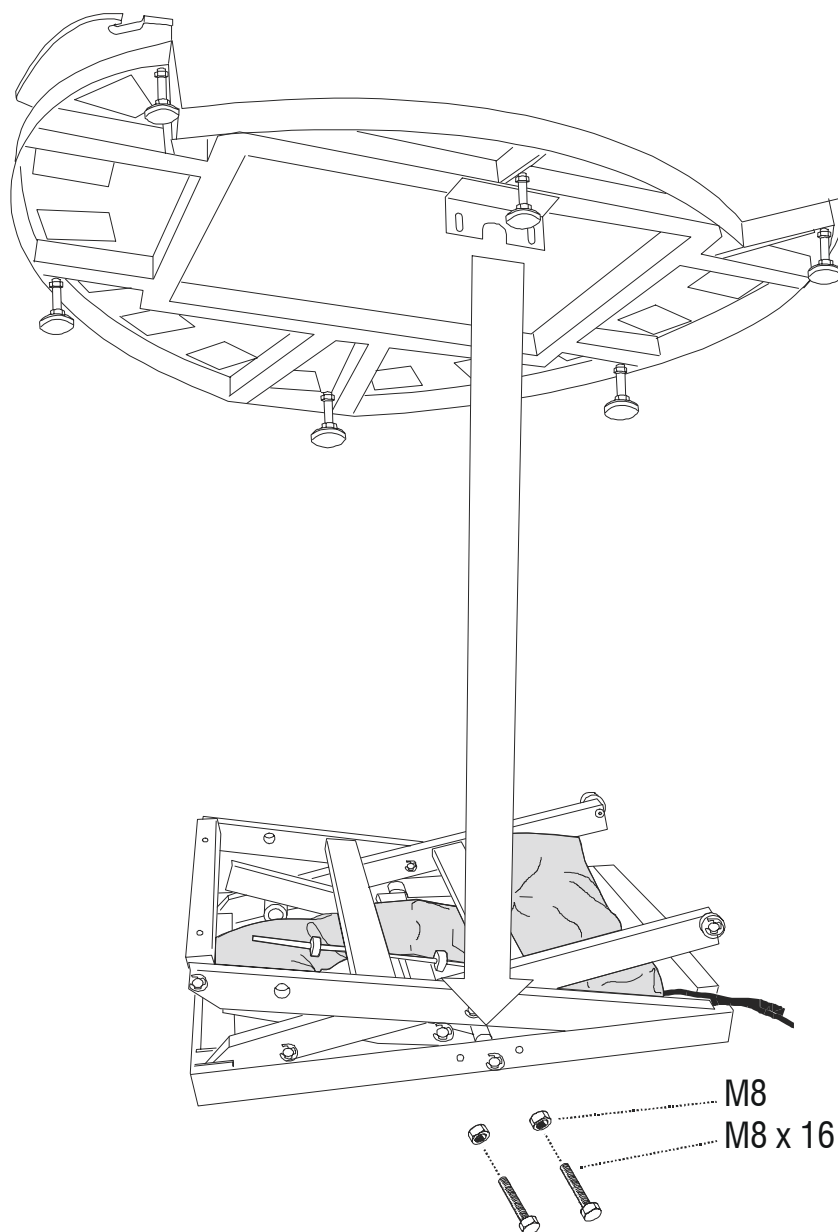

Install the Base to the lift, mind the distance to the nearest walls.

## Assembly

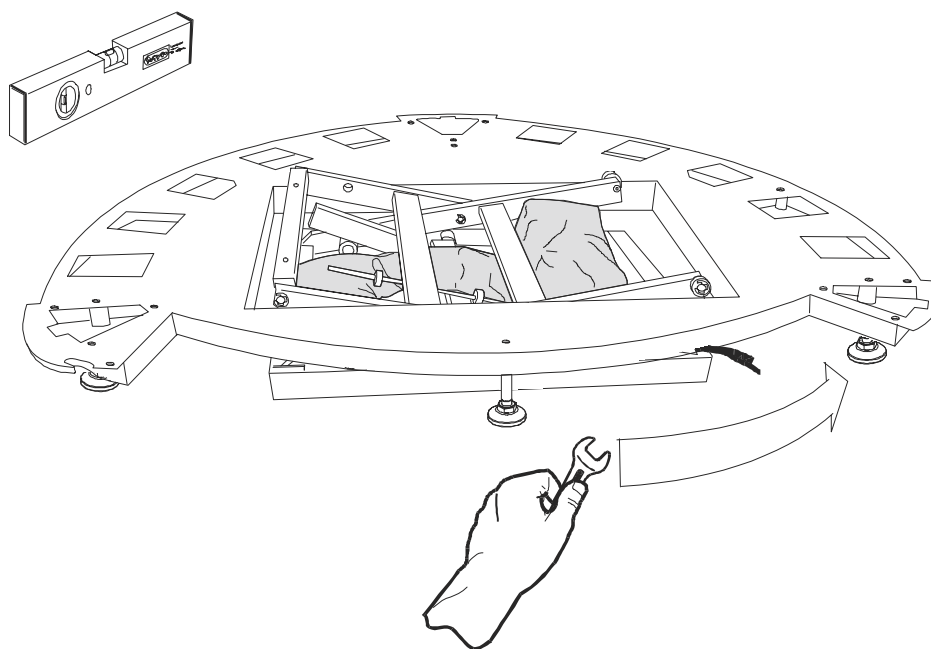

- Level the Base with the 6 adjustable leveling glides.

## Assembly

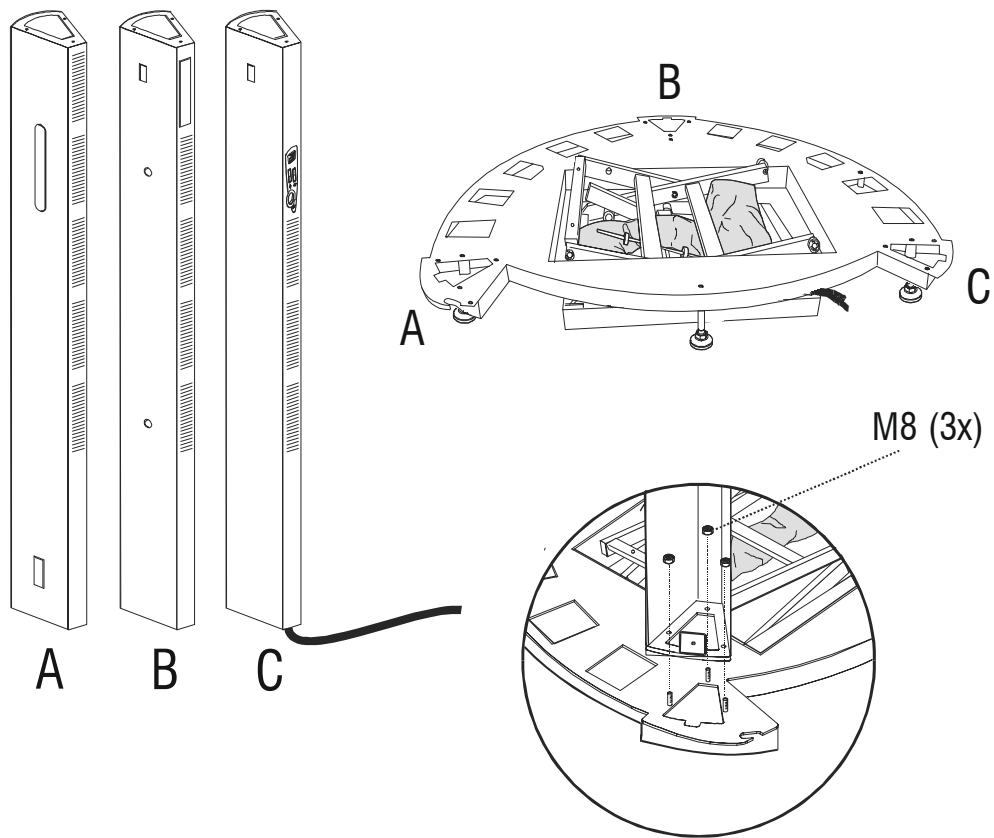

- Install the 3 Columns with 9 nuts.
- Fasten the nuts hand tight.

## Assembly

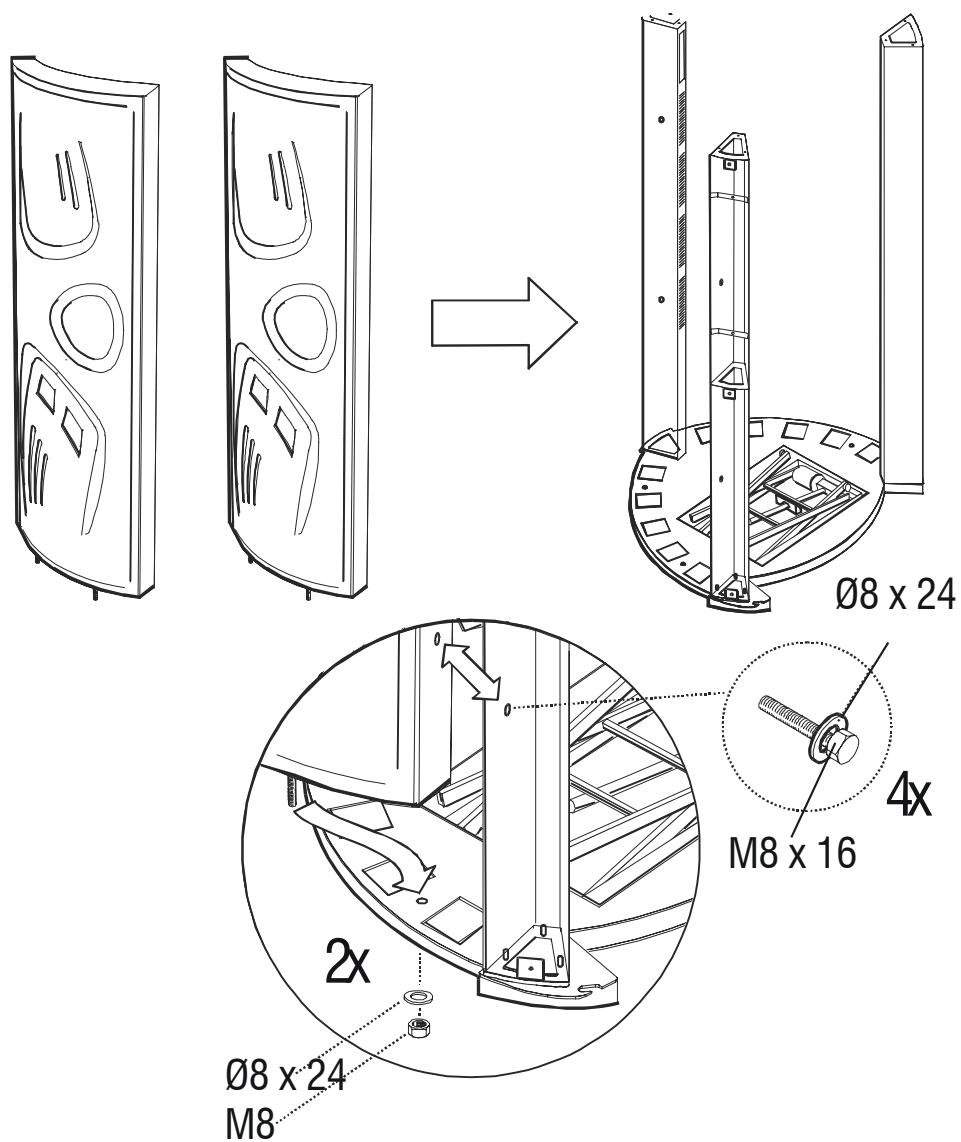

- Note: ( route the cables before complete installing the panels )
- Install the 2 similar panels and fasten the panels hand tight.

## Assembly

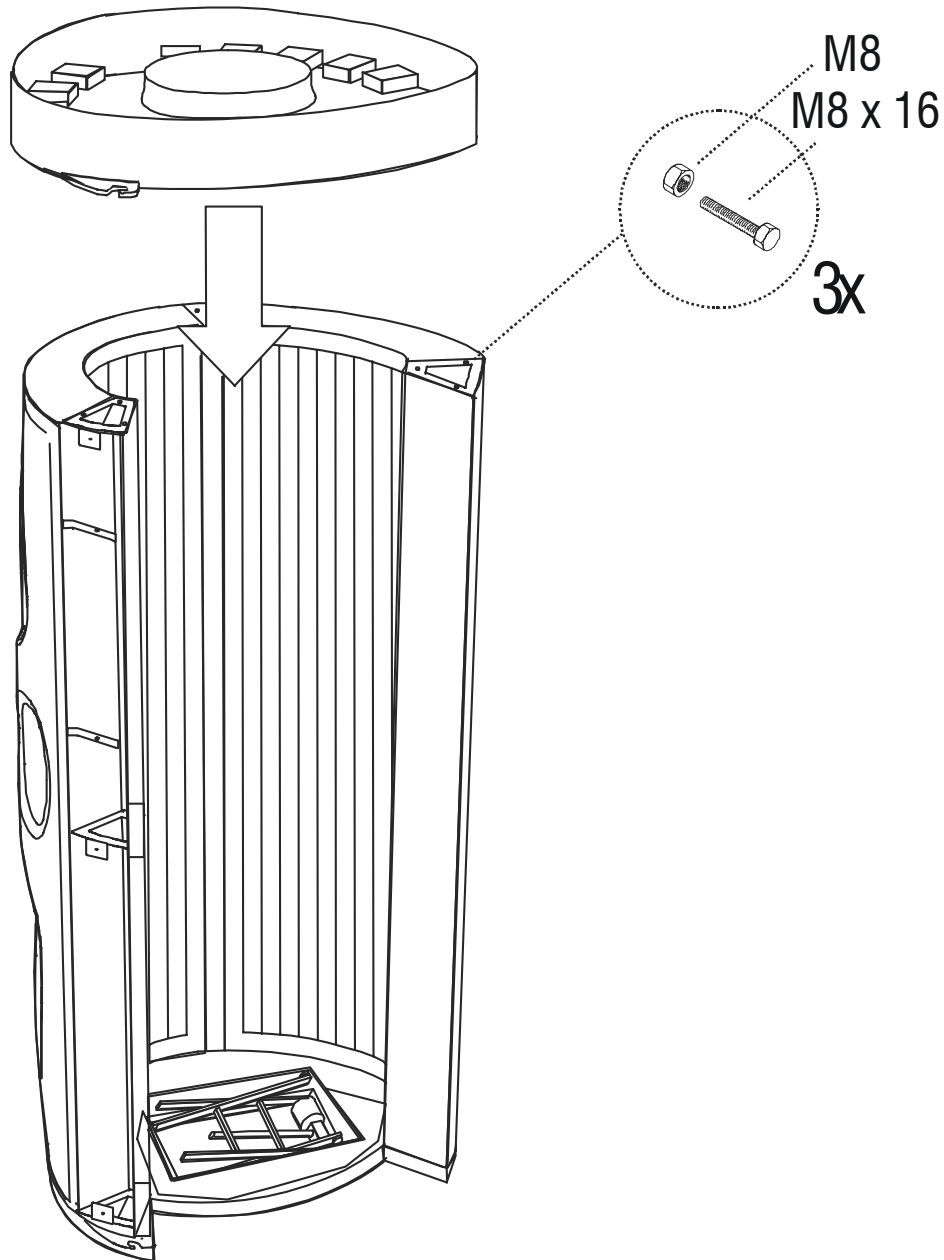

- Install the top to the panels and fasten the nuts hand tight.
- Position of the hinge needs to be on the left front side.
- Fasten **all** connections thoroughly, beginning with column A to C.

## Assembly

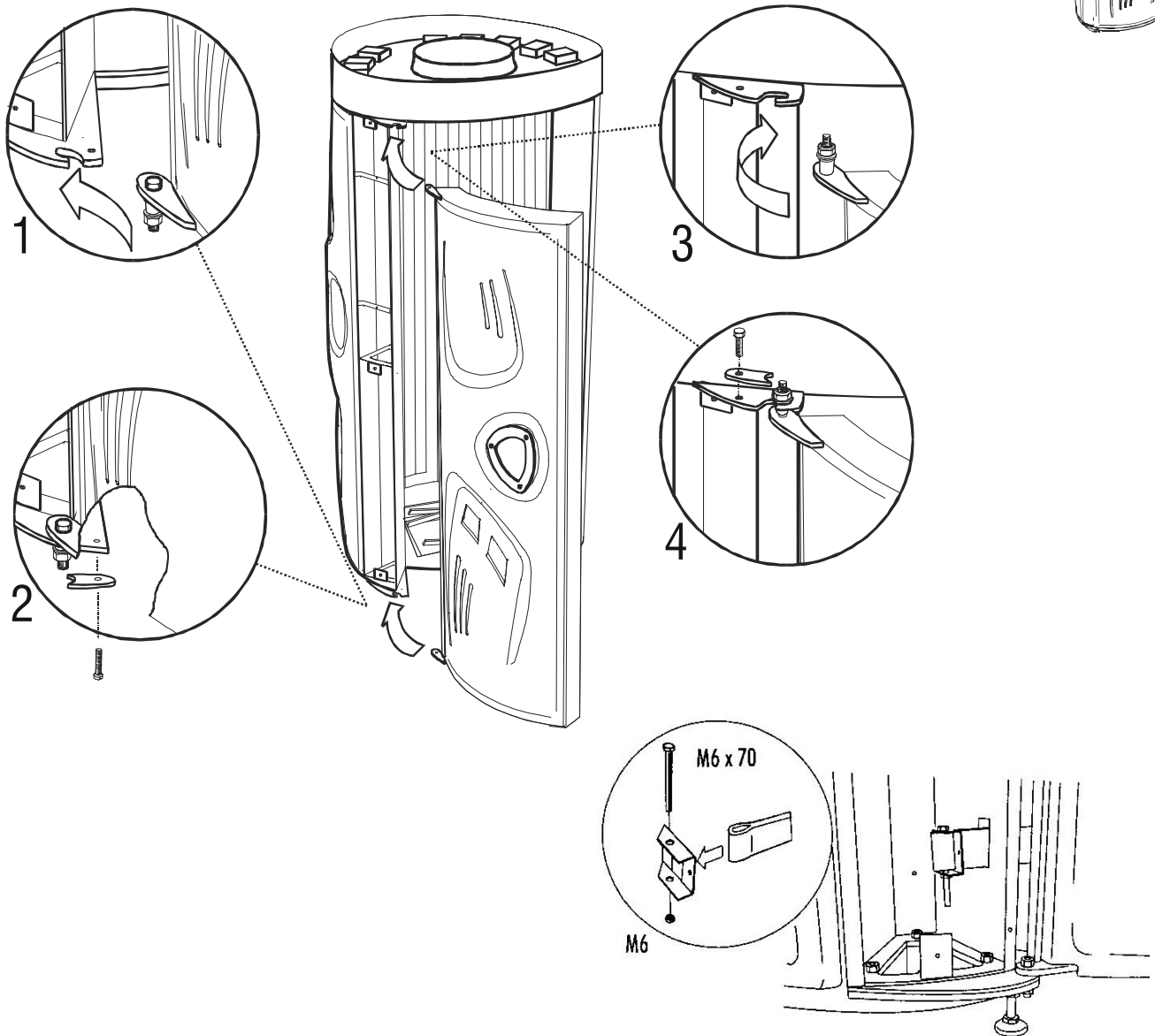

- Note: cables must be routed through slot before door is installed.
- Install the door and attach the 2 hinge guards.
- By tightening bolts until there is 2 mm between door and bushing.
- Door needs to swing freely.
- Do not over-tighten the hinge bolts.
- To connect door cables match colors on connector (see page 27 ).
- Push the rubber hinge guard through the column.
- Install the lock bracket with a bolt and nut ( see drawing ).



## Assembly

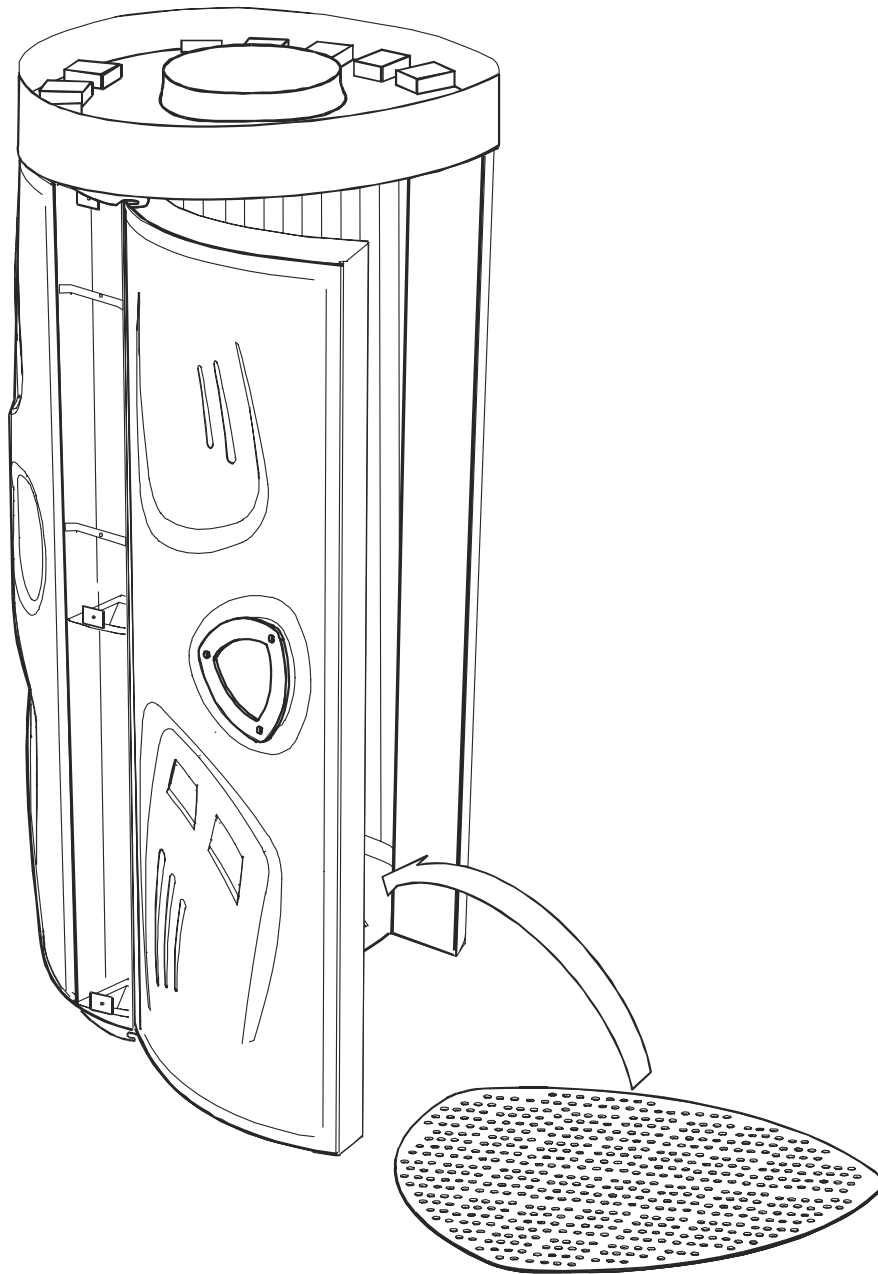

- Place the floor in the booth.
- If lift option is chosen see next page.

## Assembly

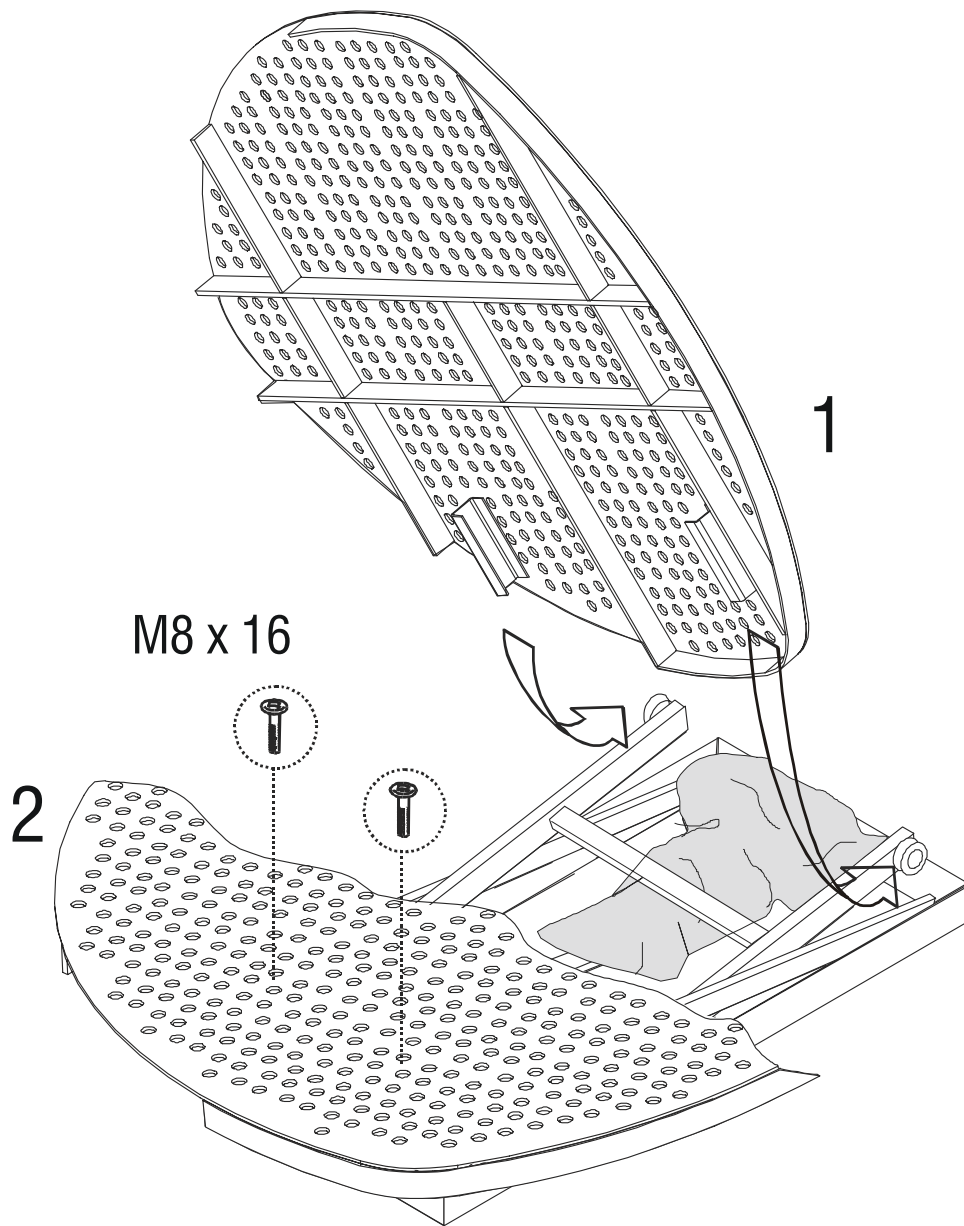

- Lift option.
- Slide channels over the wheels.
- Secure with 2 bolts.

## Assembly

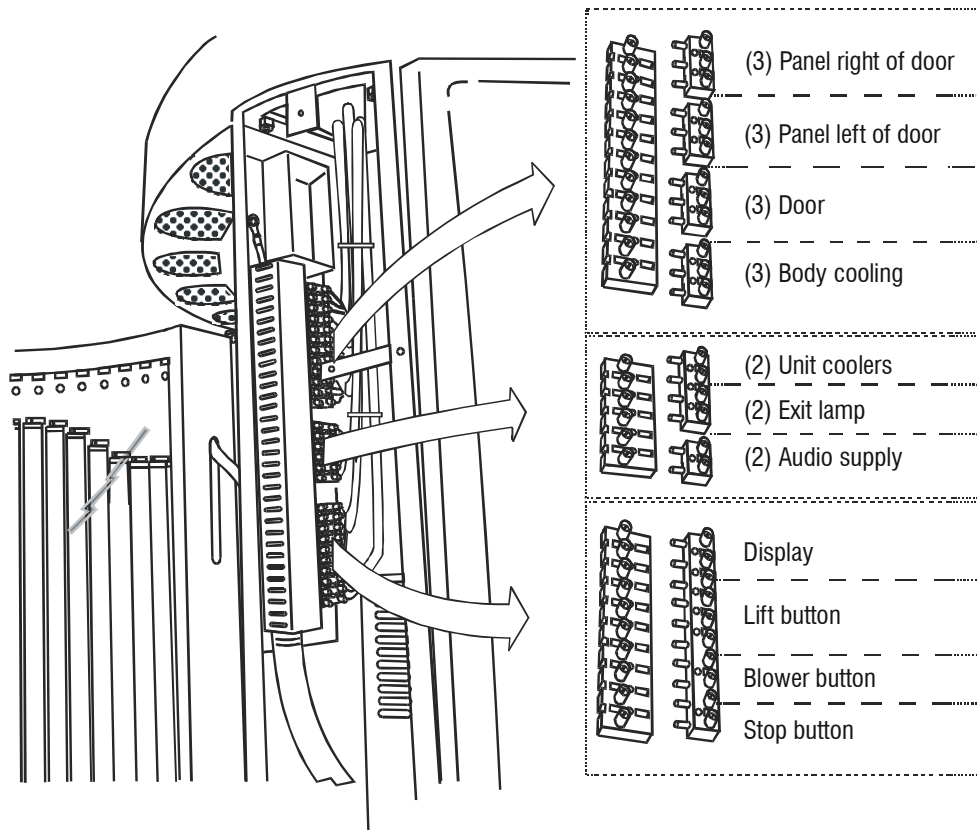

Put all the connectors together following the color code on the connectors.

## Assembly Lift and Remote

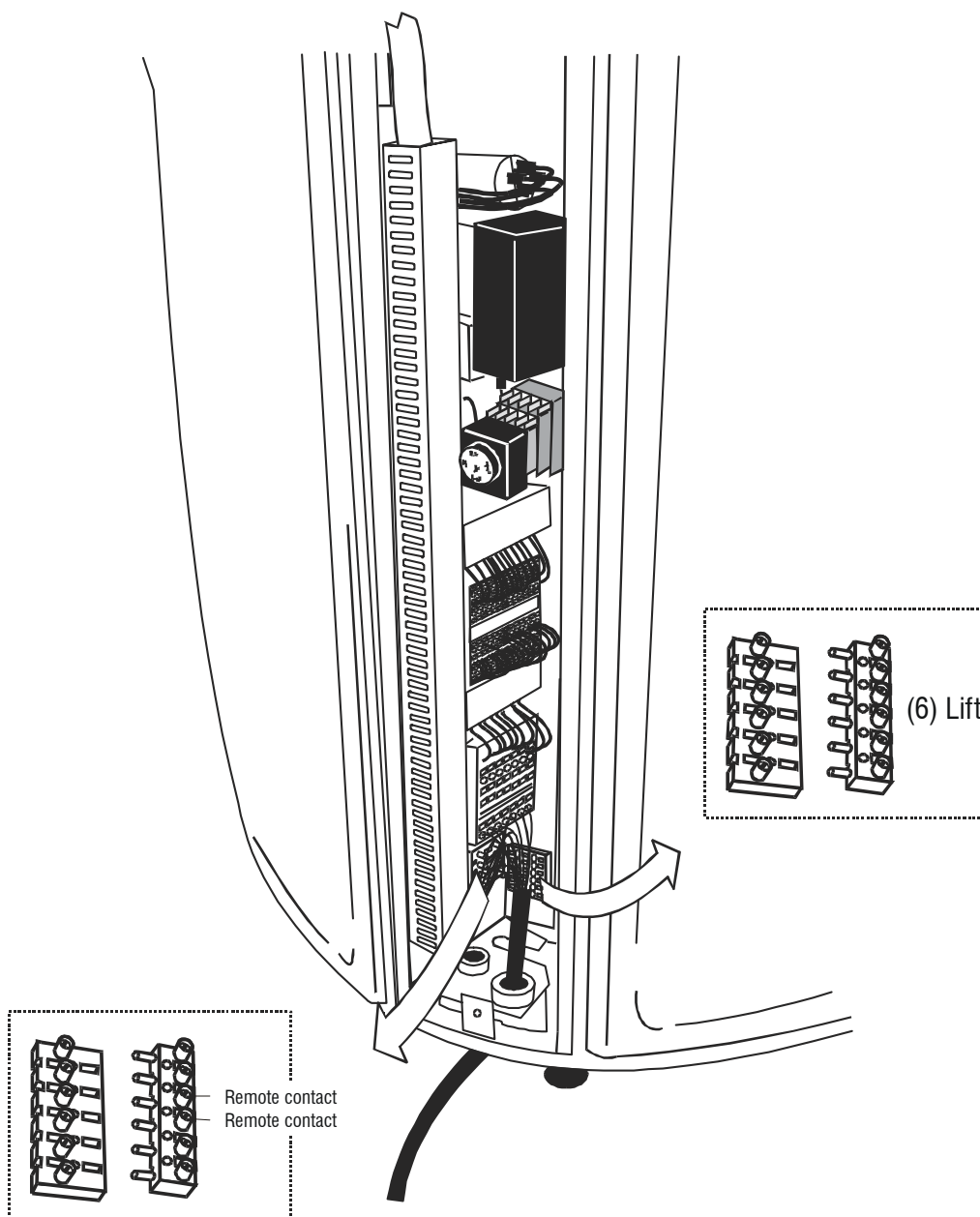

For remote operation use the pre-made 2-conductor white cord coming out of the right column.

## Assembly

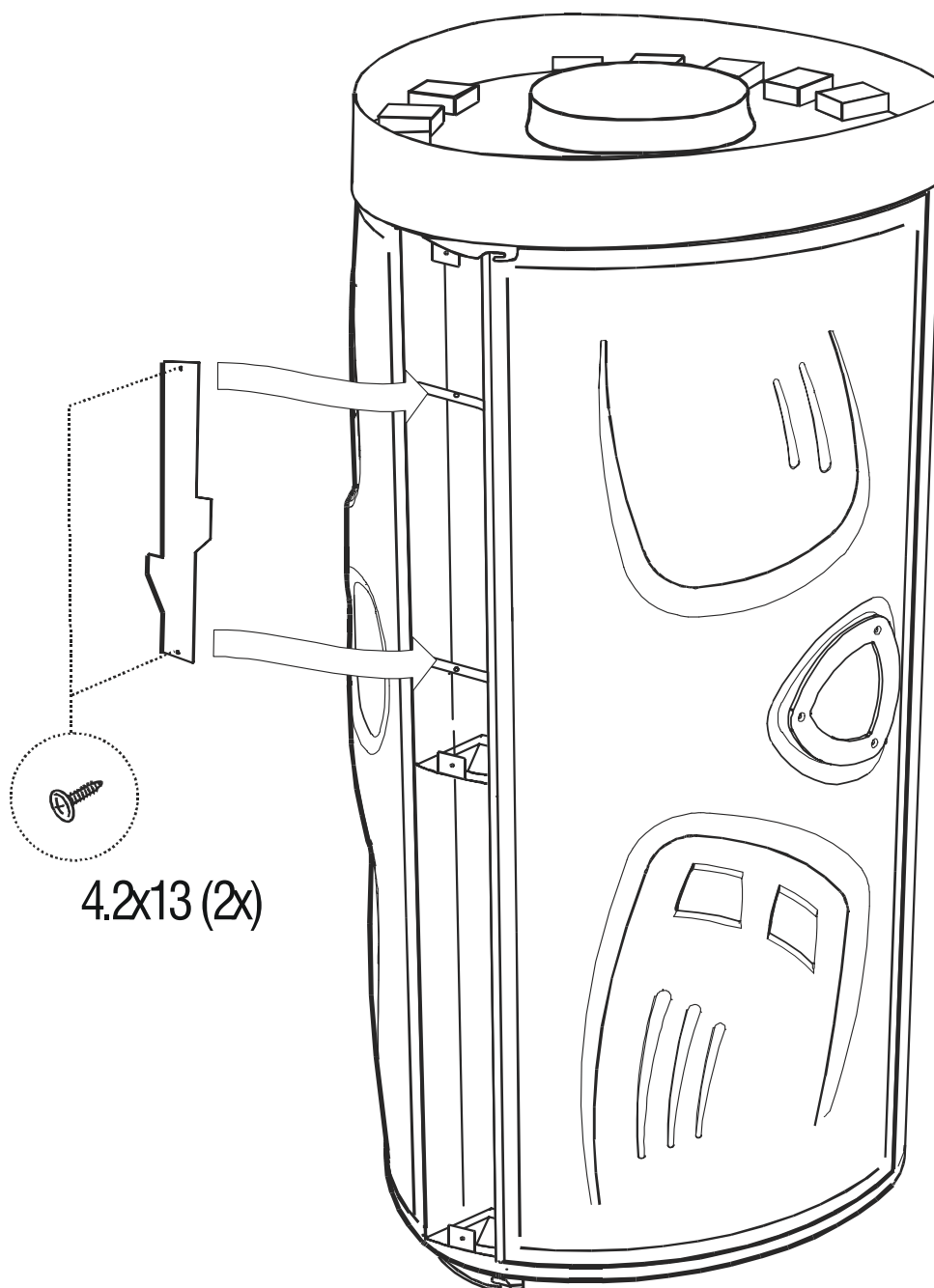

4.2x13 (2x)

Mount the 3 decoration plates.

## Assembly

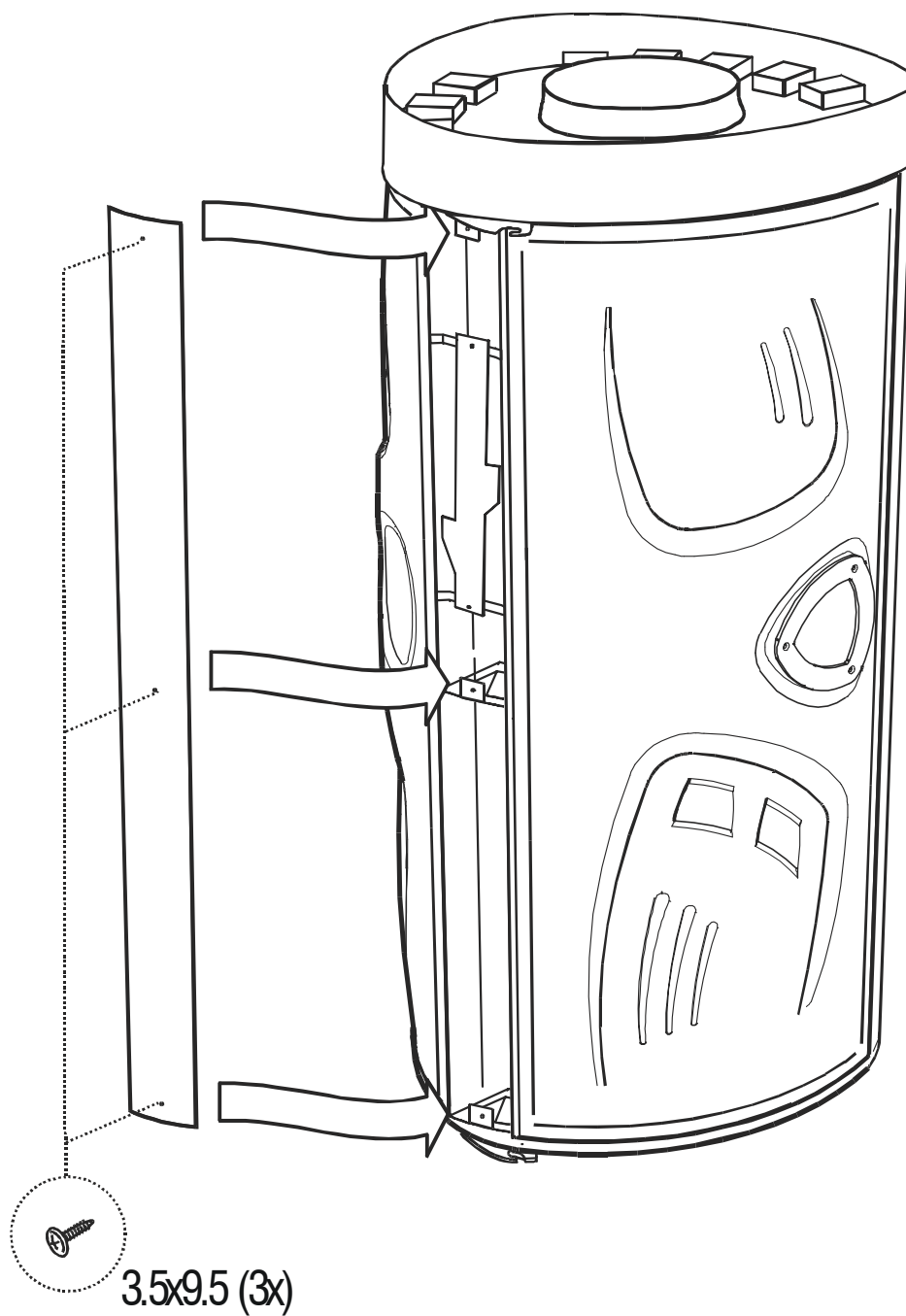

Mount the 3 ProSun cover panels ( 3 different ones ).



## Installation / Removal of Acrylic's

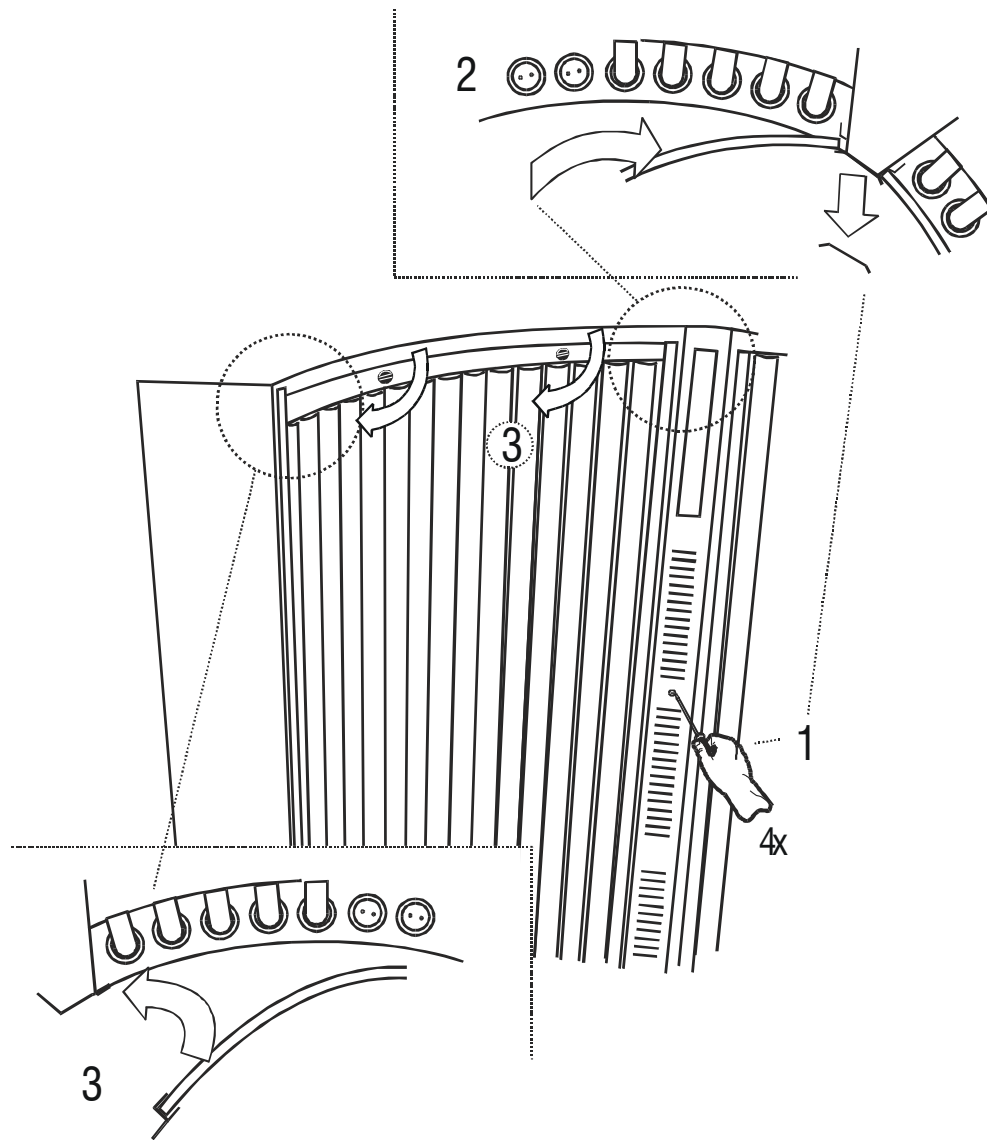

- Remove the acrylic strip in the back of the unit. ( 4 twist locks )
- Install the 2 acrylic's. ( Note: there is a difference between left and right )
- Snap the acrylic support rails in place. ( fig. 3 )
- ( Note: door has 2 acrylic support rails )
- Lock the acrylic locks on the top.
- Replace the acrylic strip in the back.
- To remove acrylic's follow above procedure in reverse order.

## Hour Counter

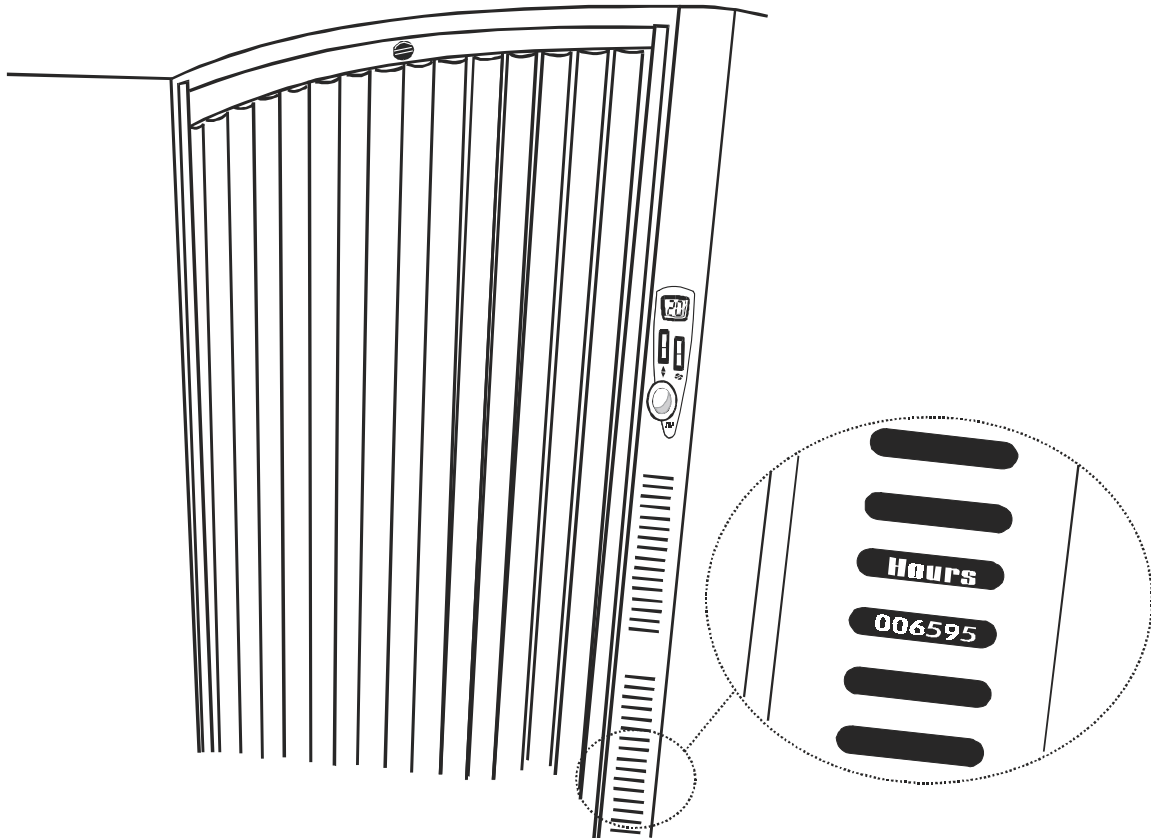

The hour counter is positioned in the control column. You can see it through Ventilation holes in the column.



Delta 160

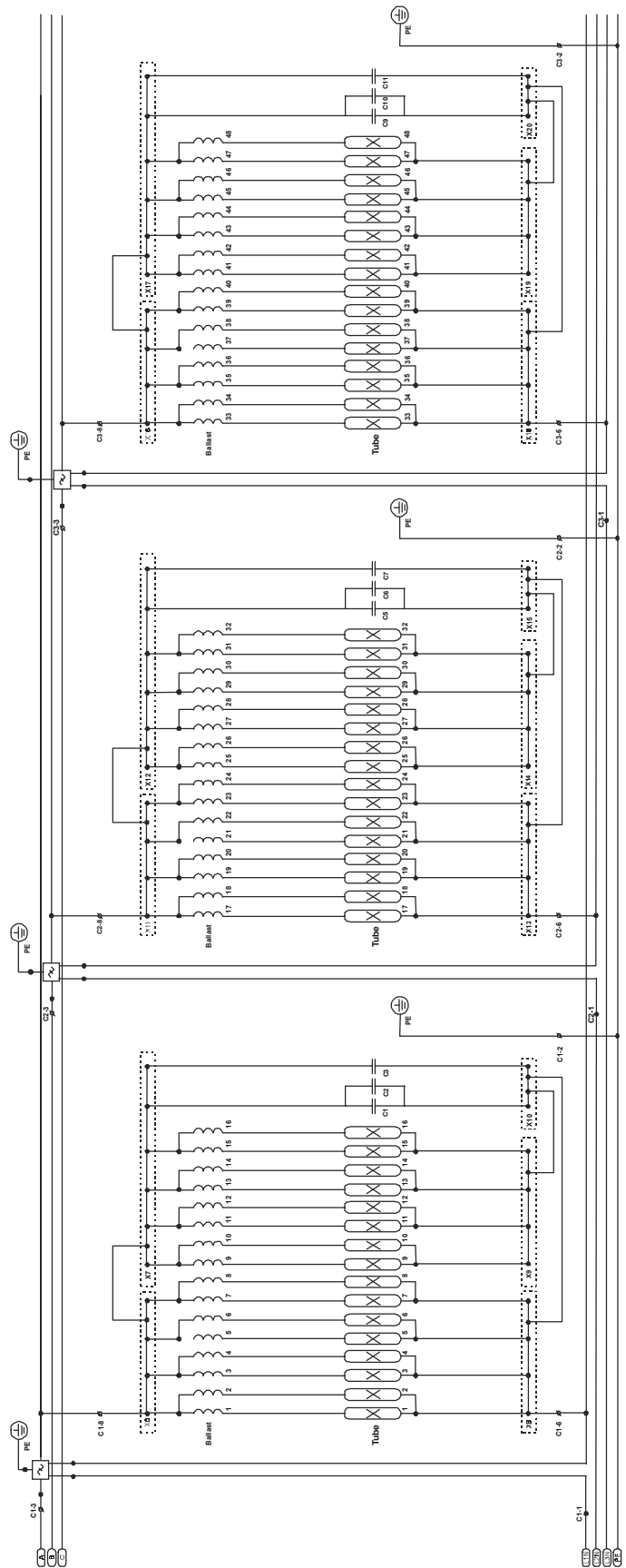

Panel 3  
(door)

Panel 2  
(backside unit)

Panel 1  
(rightside electroplate)

# Drawing 180

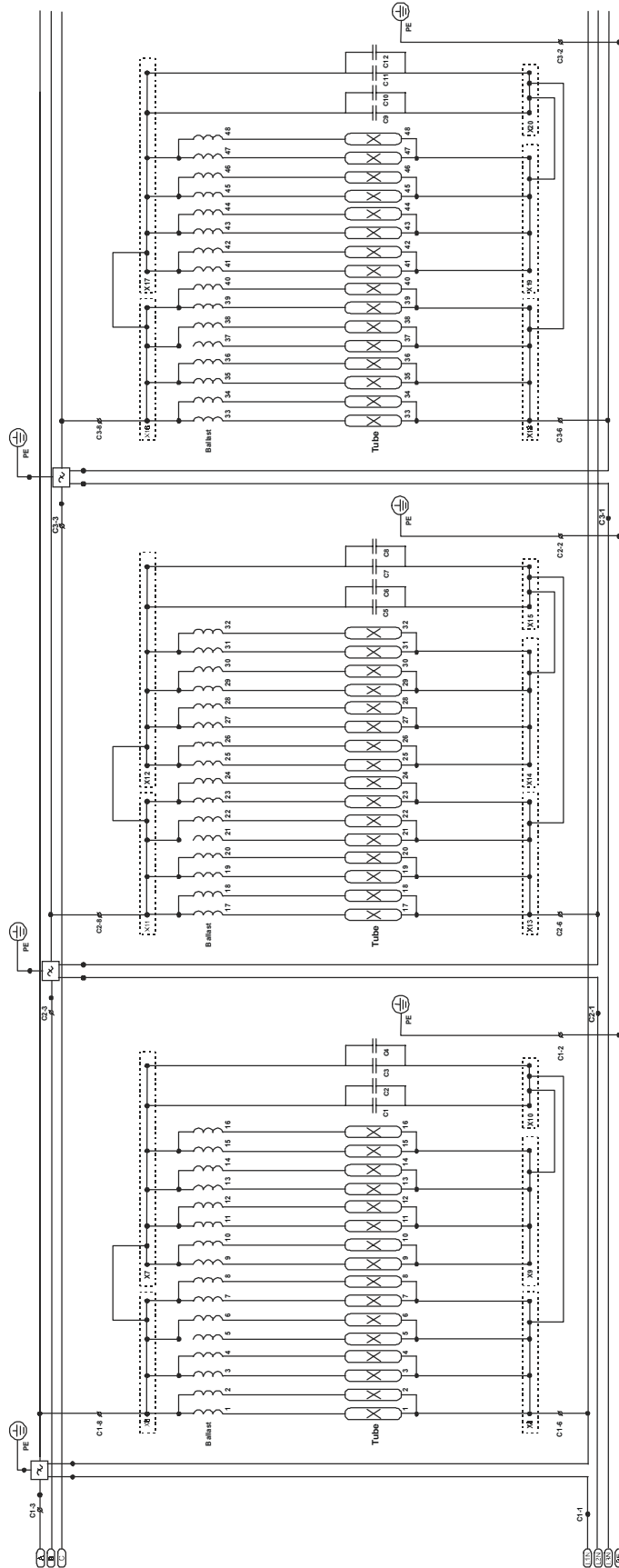

Panel 3  
(door)

Panel 2  
(backside unit)

Panel 1  
(rightside electroplate)

Drawing 35

